

From: jadu-www@scec322.servers.jadu.net <jadu-www@scec322.servers.jadu.net> **On Behalf Of** donotreply@hounslow.gov.uk
Sent: 10 July 2025 10:32
To: Licensing <Licensing@hounslow.gov.uk>
Subject: FAST TRACK APPLICATION TEMPORARY STREET TRADING LICENCE -1342813

Fast Track Pavement Licence online form has been received on 10/07/2025 at 10:31:43 by London Borough of Hounslow.

Web reference number: 1342813

Payment reference: JADT00158062

Page: Previous licence details

- Type of request Renew an existing pavement licence - £350
- Existing Pavement Licence Details
 - Existing pavement licence number PL131255/2024-2025
 - Date of expiry Mon 18th Aug 2025

Page: Applicant Details

- Are you applying as an individual or a company? Company
- Please complete if applying as a company
 - Please state the trading name of your company Gail's Ltd.
 - Registered address of company Unit 12 To 13, Garrick Industrial Centre, Irving Way, Colindale, London, NW9 6AQ
 - Telephone Number [REDACTED]
 - Email [REDACTED]
 - Please state Company Registration No. 06055393
 - What type of company 56101 - Licensed restaurants

Page: Business Details

- Certificate No: AC304447
- Date of Issue: Sat 1st Mar 2025
- Date of Expiry: Sat 28th Feb 2026
- Please upload your public liability certificate? Gails_Public_Liability_Insurance.pdf
- Please provide a detailed plan of the external areas showing dimensions, width, depth of area to be licensed and distance to the nearest street furniture and kerb
17067_11_PLANNING_EXT_SEATING_GAILS_CHISWICK.pdf

- You MUST provide photographs of the proposed licensed area Image_of_Bakery.png
- Are you applying for a pavement licence in-front of an adjacent premises? No

Page: Pavement Cafe/Tables & Chairs

- Name of premises Gail's Bakery
- Address: 282 - 284, Chiswick High Road, Chiswick, London, W4 1PA
- Telephone Number [REDACTED]
- Email [REDACTED]
- Size of area to be used for the pavement licence (length x width) m2 9
- Depth: 1.49
- Width: 6
- Please choose your working days Monday, Tuesday, Wednesday, Thursday, Friday, Saturday, Sunday
- Trading Times:

	From - am To - pm	
Monday	8.00	19.30
Tuesday	8.00	19.30
Wednesday	8.00	19.30
Thursday	8.00	19.30
Friday	8.00	19.30
Saturday	8.00	19.30
Sunday	8.00	19.30

- Where will the tables & chairs be stored at the end of trading hours? Inside the premise

Page: Further information

- Outline how the table and chairs will be managed. Gail's will manage the tables and chairs by setting them out each morning and removing them at the end of the trading day, ensuring none are left on the pavement overnight. The furniture will remain within the licensed area at all times, maintaining clear pedestrian access. Staff will regularly monitor the area to keep it clean, tidy, and used appropriately by customers, while also ensuring it does not cause obstruction or nuisance. The setup will be accessible, comply with any relevant health and safety guidance, and be managed to prevent any disturbance to neighbouring properties.
- Outline how local nuisance will be managed. Gail's will manage local nuisance by ensuring the outdoor seating area is used only during permitted hours, with furniture removed at the end of each day. Staff will monitor noise levels to avoid disturbance, keep the area clean and litter-

free, and address any inappropriate customer behaviour promptly. No amplified music, cooking, or smoking will be permitted in the external area, helping to minimise any impact on nearby residents and businesses.

- Will the placement of the table and chairs allow for people to pass with a minimum of 1.5m+?
Yes

Page: Applicant Declaration

- Declaration I understand that if I do not complete the appropriate sections of the application form and provided the required information my application will be rejected.
- Signature of Applicant I confirm all the details provided in this form are accurate to the best my knowledge at the time of submission and confirm I wish my application to be processed.
- Date Thu 10th Jul 2025
- Full Name Tamsin Penberthy
- Company Planning Potential
- Position in company Agent

Page: Payment

- Please tick here to accept this payment I accept

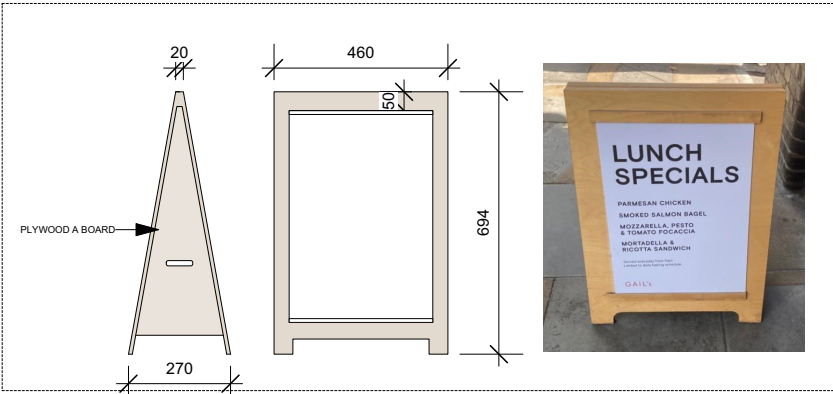

2 Proposed A Board
1:20

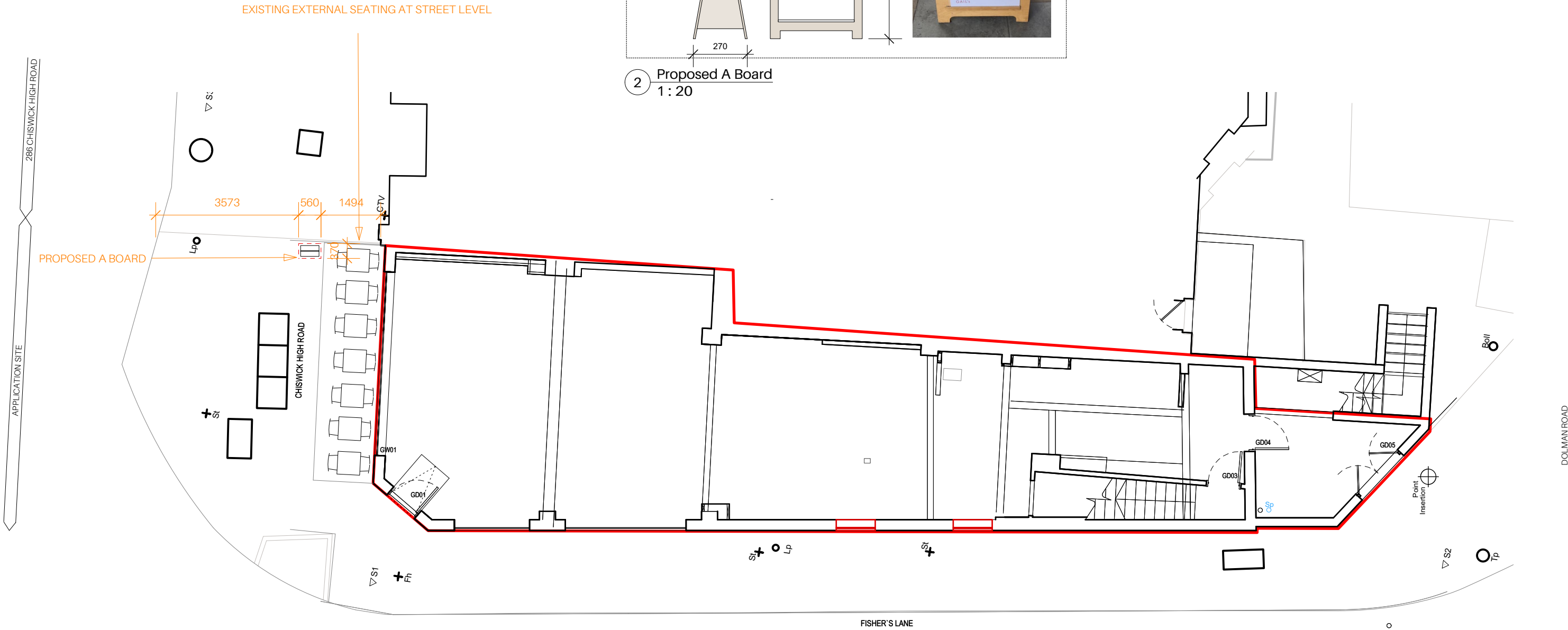

PROPOSED ROOF TERRACE APPLICATION

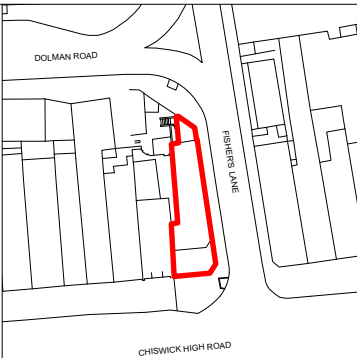
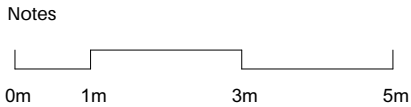

REV	DATE	DESCRIPTION	BY	CHK
00	18.08.23	ISSUED FOR PLANNING	MB	ET

Project Gail's Chiswick, 282 Chiswick High Rd			
Drawing Proposed Ground Floor Plan			
Job Number 17067	Drawing Number 1100	Rev 00	
Drawn CA	Date 18.01.18	Status PLANNING	Scale @ A3 1:100
Do not scale from this drawing. All dimensions are to be checked on site. This drawing is to be read in conjunction with all consultants information.			



Holland Harvey Architects
Unit 1.4
1-5 Vyner Street
London E2 9DG
hello@hollandharvey.com
+44 203 327 0340

Client

Gail's