

**Deposited Documents – Reference TMO/P045/24**

Held on deposit online

Placed on deposit on Friday, 13 June 2025

**Provision of parking places – Westbury Place, Brentford****Contents:**

1. Notice of Making dated 11 June 2025
2. Traffic Management Orders
  - A. The London Borough of Hounslow (Brook Road South & Brentford Stadium Event Day) (Parking Places) (Amendment No.8) Order 2025
  - B. The London Borough of Hounslow (Waiting and Loading Restriction) (Amendment No.364) Order 2025
3. Notice of Intent dated 20 December 2024
4. Proposed Traffic Management Orders
  - A. The London Borough of Hounslow (Brook Road South & Brentford Stadium Event Day) (Parking Places) (Amendment No.\*\*\*) Order 20\*\*
  - B. The London Borough of Hounslow (Waiting and Loading Restriction) (Amendment No.\*\*\*) Order 20\*\*
5. Statement of Reasons
6. Plan
7. Existing Traffic Management Orders
  - A. The London Borough of Hounslow (Brook Road South & Brentford Stadium Event Day) (Parking Places) Order 2015
  - B. The London Borough of Hounslow (Waiting and Loading Restriction) (Civil Enforcement Area) Order 2008

Any queries regarding these deposited documents should be sent by email to [trafficorders@hounslow.gov.uk](mailto:trafficorders@hounslow.gov.uk) or alternatively a voicemail can be left on extension 3322.



**Provision of parking places – Westbury Place, Brentford**

- A. The London Borough of Hounslow (Brook Road South & Brentford Stadium Event Day) (Parking Places) (Amendment No.8) Order 2025**
- B. The London Borough of Hounslow (Waiting and Loading Restriction) (Amendment No.364) Order 2025**
1. The London Borough of Hounslow hereby gives notice that, it made the above Orders on 11 June 2025 under sections 6, 45, 46, 49 and 124 of and Part IV of Schedule 9 to the Road Traffic Regulation Act 1984, as amended. The Order will come into operation on 27 June 2025.
  2. The general effect of the Orders will be to:
    - (a) to introduce a permit parking bay in Westbury Place, Brentford; &
    - (b) to revoke the vehicle crossover outside No.1A Westbury Place, Brentford.
  3. Documents giving further information of the Order can be viewed for a period of six weeks from the date of this Notice online at [hounslow.gov.uk](https://hounslow.gov.uk) by typing in the term “traffic notices” in the search bar.
  4. Any person desiring to question the validity of the Orders or any provision contained therein on the grounds that they are not within the relevant powers of the Road Traffic Regulation Act 1984, or that any of the relevant regulations made thereunder have not been complied with in relation to the Orders may, within six weeks of the date on which the Orders were made, make an application for the purpose to the High Court.

Dated: 11 June 2025

Sabeel Khan  
Acting Assistant Director for Traffic, Transport & Parking  
(The Officer appointed for the purpose)

# Traffic Management Order

2025 No.106

---

The London Borough of Hounslow (Brook Road South & Brentford Stadium Event Day) (Parking Places) (Amendment No.8) Order 2025

Made on 11 June 2025

Coming into operation on 27 June 2025

---

The Council of the London Borough of Hounslow, having consulted the Commissioner of Police of the Metropolis, in exercise of the powers conferred by sections 45, 46, 49 and 51 and 124 of the Road Traffic Regulation Act 1984<sup>a</sup> as amended, and of all other enabling powers make the following Order:

## Citation and Commencement

1. This Order shall come into operation on 27 June 2025 and may be cited as The London Borough of Hounslow (Brook Road South & Brentford Stadium Event Day) (Parking Places) (Amendment No.8) Order 2025

## Interpretation

2. (1) In this Order the “Order of 2015” means The London Borough of Hounslow (Brook Road South & Brentford Stadium Event Day) (Parking Places) Order 2015<sup>b</sup>.  
(2) Unless the context otherwise requires, any expression used in this Order which is also used in the Order of 2015 shall have the same meaning as in that Order.  
(3) Any reference in this Order to any enactment shall be construed as a reference to that enactment as amended, applied, consolidated, re-enacted by or as having effect by virtue of any subsequent enactment.

## Revocation and/or Designation of Parking Places

3. Without prejudice to the validity of anything done or to any liability incurred in respect to any act or omission before the coming into operation of this Order, the Order of 2015, shall have effect as though:
  - a) the item numbered 96a in the Schedule to this Order is added to Schedule 7 to that Order.

Dated this eleventh day of June 2025.



Sabeel Khan  
Acting Assistant Director for Traffic, Transport & Parking  
(The Officer appointed for this purpose)

---

a 1984 c. 27

b LBH 2015/06

## Schedule

No. of parking	Designated parking place	Minimum number of parking spaces	Minimum total length in metres not to be occupied by parking spaces	Special manner of standing
1.	2.	3.	4.	5.
96a	Westbury Place, Brentford, north-east side, from a point 6 metres south-east of the south-eastern building line of No.1 Westbury Place, to a point a point 1.0 metres south-east of the south-eastern building line of No.1 Westbury Place.	1	0	2 wheels on the footway

---

### EXPLANATORY NOTE

(This Note is not part of the Order, but is intended to indicate its general purport.)

The London Borough of Hounslow (Brook Road South & Brentford Stadium Event Day) (Parking Places) Order 2015 designates parking places in the Brentford area at which charges may be made by the Council for vehicles authorised by that Order to be left in those parking places during the permitted hours. This Order amends the Order to introduce a permit parking bay in Westbury Place, Brentford.

# Traffic Management Order

2025 No.107

The London Borough of Hounslow (Waiting and Loading Restriction) (Amendment No.364) Order 2025

Made on 11 June 2025

Coming into operation on 27 June 2025

The Council of the London Borough of Hounslow, after consulting the Commissioner of Police of the Metropolis, in exercise of the powers conferred by sections 6 and 124 to the Road Traffic Regulation Act 1984<sup>a</sup> as amended, and of all other enabling powers hereby make the following Order:

## Citation and Commencement

1. This Order shall come into operation on 27 June 2025 and may be cited as The London Borough of Hounslow (Waiting and Loading Restriction) (Amendment No.364) Order 2025.

## Interpretation

2. (1) In this Order the “Order of 2008” means The London Borough of Hounslow (Waiting and Loading Restriction) (Civil Enforcement Area) Order 2008<sup>b</sup>.  
(2) Unless the context otherwise requires, any expression used in this Order which is also used in the Order of 2008 shall have the same meaning as in that Order.  
(3) Any reference in this Order to any enactment shall be construed as a reference to that enactment as amended, applied, consolidated, re-enacted by or as having effect by virtue of any subsequent enactment.

## Revocation and/or Substitution and/or Addition of Prohibition and/or Restriction

3. Without prejudice to the validity of anything done or to any liability incurred in respect of any act or omission before the coming into operation of this Order, the Order of 2008 shall have effect as though:
  - a) the item numbered 952(ai) in Schedule 1 to that Order were substituted with the item similarly numbered and set out in the Schedule to this Order.

Dated this eleventh day of June 2025.



Sabeel Khan

Acting Assistant Director for Traffic, Transport & Parking  
(The Officer appointed for the purpose)

<sup>a</sup> 1984 c. 27

<sup>b</sup> LBH 2008/24

### Schedule

1 Item Number	2 Street	3 Prescribed hours
952	ai Westbury Place, Brentford, north-west sides, from a point 1 metres south of the southern building line of No. 1 Westbury Place southwards for a distance of 5 metres	GGGG

### EXPLANATORY NOTE

(This Note is not part of the Order, but is intended to indicate its general purport.)

This Order further amends The London Borough of Hounslow (Waiting and Loading Restriction) (Civil Enforcement Area) Order 2008 by amending waiting restrictions in Westbury Place, Brentford, to revoke the vehicle crossover outside No.1A Westbury Place, Brentford.

## **Deposited Documents – Reference TMO/P045/24**

Held on deposit online [https://www.hounslow.gov.uk/downloads/20165/traffic\\_notices](https://www.hounslow.gov.uk/downloads/20165/traffic_notices)

Placed on deposit on Friday, 20 December 2024

End of Consultation period is Friday, 17 January 2025

## **Provision of parking places – Westbury Place, Brentford**

### **Contents:**

- 1. Notice of Intent dated 20 December 2024**
- 2. Proposed Traffic Management Orders**
  - A. The London Borough of Hounslow (Brook Road South & Brentford Stadium Event Day) (Parking Places) (Amendment No.\*\*\*) Order 20\*\***
  - B. The London Borough of Hounslow (Waiting and Loading Restriction) (Amendment No.\*\*\*) Order 20\*\***
- 3. Statement of Reasons**
- 4. Plan**
- 5. Existing Traffic Management Orders**
  - A. The London Borough of Hounslow (Waiting and Loading Restriction) Order 2008 [2008/24] (articles only)
  - B. The London Borough of Hounslow (Waiting and Loading Restriction) (Amendment No.347) Order 2024 [2054/21]
  - C. The London Borough of Hounslow (Brook Road South & Brentford Stadium Event Day) (Parking Places) [2015/6]
  - D. The London Borough of Hounslow (Parking Places) (Parking Charges) Order 2018
  - E. The London Borough of Hounslow (Brook Road South & Brentford Stadium Event Day) (Parking Places) (Amendment No.4) Order 2019 [2019/28]

Any queries regarding these deposited documents should be sent by email to [trafficorders@hounslow.gov.uk](mailto:trafficorders@hounslow.gov.uk) or alternatively a voicemail can be left on extension 3322.



**Provision of parking places – Westbury Place, Brentford**

- A. The London Borough of Hounslow (Brook Road South & Brentford Stadium Event Day) (Parking Places) (Amendment No.\*\*\*) Order 20\*\***
- B. The London Borough of Hounslow (Waiting and Loading Restriction) (Amendment No.\*\*\*) Order 20\*\***
1. The London Borough of Hounslow proposes to make the above-mentioned Orders under sections 6, 45, 46, 49 and 124 of and Part IV of Schedule 9 to the Road Traffic Regulation Act 1984, as amended.
  2. It is necessary to amend the above Order to facilitate the provision of additional permit parking bay in Westbury Place, following the removal of an existing vehicle access at No.1A Westbury Place, Brentford.
  3. The general effect of the Orders would be:
    - (a) to introduce a permit parking bay in Westbury Place, Brentford; &
    - (b) to revoke the vehicle crossover outside No.1A Westbury Place, Brentford.
  4. Documents giving further information of the proposed Orders can be viewed for a period of 21 days from the date of this Notice online at [hounslow.gov.uk](https://hounslow.gov.uk) by typing in the term “traffic notices” in the search bar and at Hounslow Library, Hounslow House First Floor, 7 Bath Road, TW3 3EB or at The Reception of Hounslow House, Ground Floor, 7 Bath Road, TW3 3EB on Mondays and Thursdays between 9.30am and 8pm, Tuesdays, Wednesdays, Fridays and Saturdays between 9.30am and 5.30pm or on Sundays between 11.30am and 4.00pm.
  5. Any person wishing to object to the proposed Orders should send a statement in writing, stating the grounds of the objection, to the Acting Director for Environmental Services, Hounslow House 7 Bath Road, Hounslow, Middlesex TW3 3EB or by email to [trafficorders@hounslow.gov.uk](mailto:trafficorders@hounslow.gov.uk) quoting the reference TMO/P045/24, to be received by no later than Friday, 17 January 2025.

Dated: 20 December 2024

Melanie Fontinelle  
Acting Director for Environmental Services  
(The Officer appointed for the purpose)



# Traffic Management Order

20\*\* No.\*\*

---

The London Borough of Hounslow (Brook Road South & Brentford Stadium Event Day) (Parking Places) (Amendment No.\*\* ) Order 20\*\*

Made on \*\* \*\*\*\*\* 20\*\*

Coming into operation on \*\* \*\*\*\*\* 20\*\*

---

The Council of the London Borough of Hounslow, having consulted the Commissioner of Police of the Metropolis, in exercise of the powers conferred by sections 45, 46, 49 and 51 and 124 of the Road Traffic Regulation Act 1984<sup>a</sup> as amended, and of all other enabling powers make the following Order:

## Citation and Commencement

1. This Order shall come into operation on \*\* \*\*\*\*\* 20\*\* and may be cited as The London Borough of Hounslow (Brook Road South & Brentford Stadium Event Day) (Parking Places) (Amendment No.\*\* ) Order 20\*\*

## Interpretation

2. (1) In this Order the “Order of 2015” means The London Borough of Hounslow (Brook Road South & Brentford Stadium Event Day) (Parking Places) Order 2015<sup>b</sup>.  
(2) Unless the context otherwise requires, any expression used in this Order which is also used in the Order of 2015 shall have the same meaning as in that Order.  
(3) Any reference in this Order to any enactment shall be construed as a reference to that enactment as amended, applied, consolidated, re-enacted by or as having effect by virtue of any subsequent enactment.

## Revocation and/or Designation of Parking Places

3. Without prejudice to the validity of anything done or to any liability incurred in respect to any act or omission before the coming into operation of this Order, the Order of 2015, shall have effect as though:
  - a) the item numbered 96a in the Schedule to this Order is added to Schedule 7 to that Order.

Dated this \*\*\*\*\* day of \*\*\*\*\* 20\*\*

Melanie Fontinelle  
Acting Director for Environmental Services  
(The Officer appointed for this purpose)

---

a 1984 c. 27

b LBH 2015/06

## Schedule

No. of parking	Designated parking place	Minimum number of parking spaces	Minimum total length in metres not to be occupied by parking spaces	Special manner of standing
1.	2.	3.	4.	5.
96a	Westbury Place, Brentford, north-east side, from a point 6 metres south-east of the south-eastern building line of No.1 Westbury Place, to a point a point 1.0 metres south-east of the south-eastern building line of No.1 Westbury Place.	1	0	2 wheels on the footway

---

### EXPLANATORY NOTE

(This Note is not part of the Order, but is intended to indicate its general purport.)

The London Borough of Hounslow (Brook Road South & Brentford Stadium Event Day) (Parking Places) Order 2015 designates parking places in the Brentford area at which charges may be made by the Council for vehicles authorised by that Order to be left in those parking places during the permitted hours.

This Order amends the Order of 2015/06 to introduce a permit parking bay in Westbury Place, Brentford.

# Traffic Management Order

20\*\* No.\*\*

---

The London Borough of Hounslow (Waiting and Loading Restriction) (Amendment No.\*\*\*) Order 20\*\*

Made on \*\* \*\*\*\*\* 20\*\*

Coming into operation on \*\* \*\*\*\*\* 20\*\*

---

The Council of the London Borough of Hounslow, after consulting the Commissioner of Police of the Metropolis, in exercise of the powers conferred by sections 6 and 124 to the Road Traffic Regulation Act 1984<sup>a</sup> as amended, and of all other enabling powers hereby make the following Order:

## Citation and Commencement

1. This Order shall come into operation on \*\* \*\*\*\*\* 20\*\* and may be cited as The London Borough of Hounslow (Waiting and Loading Restriction) (Amendment No.\*\*\*) Order 20\*\*.

## Interpretation

2. (1) In this Order the “Order of 2008” means The London Borough of Hounslow (Waiting and Loading Restriction) (Civil Enforcement Area) Order 2008<sup>b</sup>.  
(2) Unless the context otherwise requires, any expression used in this Order which is also used in the Order of 2008 shall have the same meaning as in that Order.  
(3) Any reference in this Order to any enactment shall be construed as a reference to that enactment as amended, applied, consolidated, re-enacted by or as having effect by virtue of any subsequent enactment.

## Revocation and/or Substitution and/or Addition of Prohibition and/or Restriction

3. Without prejudice to the validity of anything done or to any liability incurred in respect of any act or omission before the coming into operation of this Order, the Order of 2008 shall have effect as though:
  - a) the item numbered 952(ai) in Schedule 1 to that Order were substituted with the item similarly numbered and set out in the Schedule to this Order.

Dated this \*\*\*\*\* day of \*\*\*\*\* 20\*\*

Melanie Fontinelle  
Acting Director for Environmental Services  
(The Officer appointed for the purpose)

---

a 1984 c. 27

b LBH 2008/24

## Schedule

1 Item Number	2 Street	3 Prescribed hours
952	ai Westbury Place, Brentford, north-west sides, from a point 1 metres south of the southern building line of No. 1 Westbury Place southwards for a distance of 5 metres	GGGG

### EXPLANATORY NOTE

(This Note is not part of the Order, but is intended to indicate its general purport.)

This Order further amends The London Borough of Hounslow (Waiting and Loading Restriction) (Civil Enforcement Area) Order 2008 by amending waiting restrictions in Westbury Place, Brentford, to revoke the vehicle crossover outside No.1A Westbury Place, Brentford.



**London Borough  
of Hounslow**

## **Statement of Reasons**

### **Provision of additional parking bays**

The proposed Order is necessary to facilitate the provision of additional parking bays in Westbury Place, Brentford following the removal of vehicle crossover outside No.1A Westbury Place, Brentford.

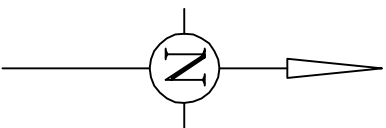
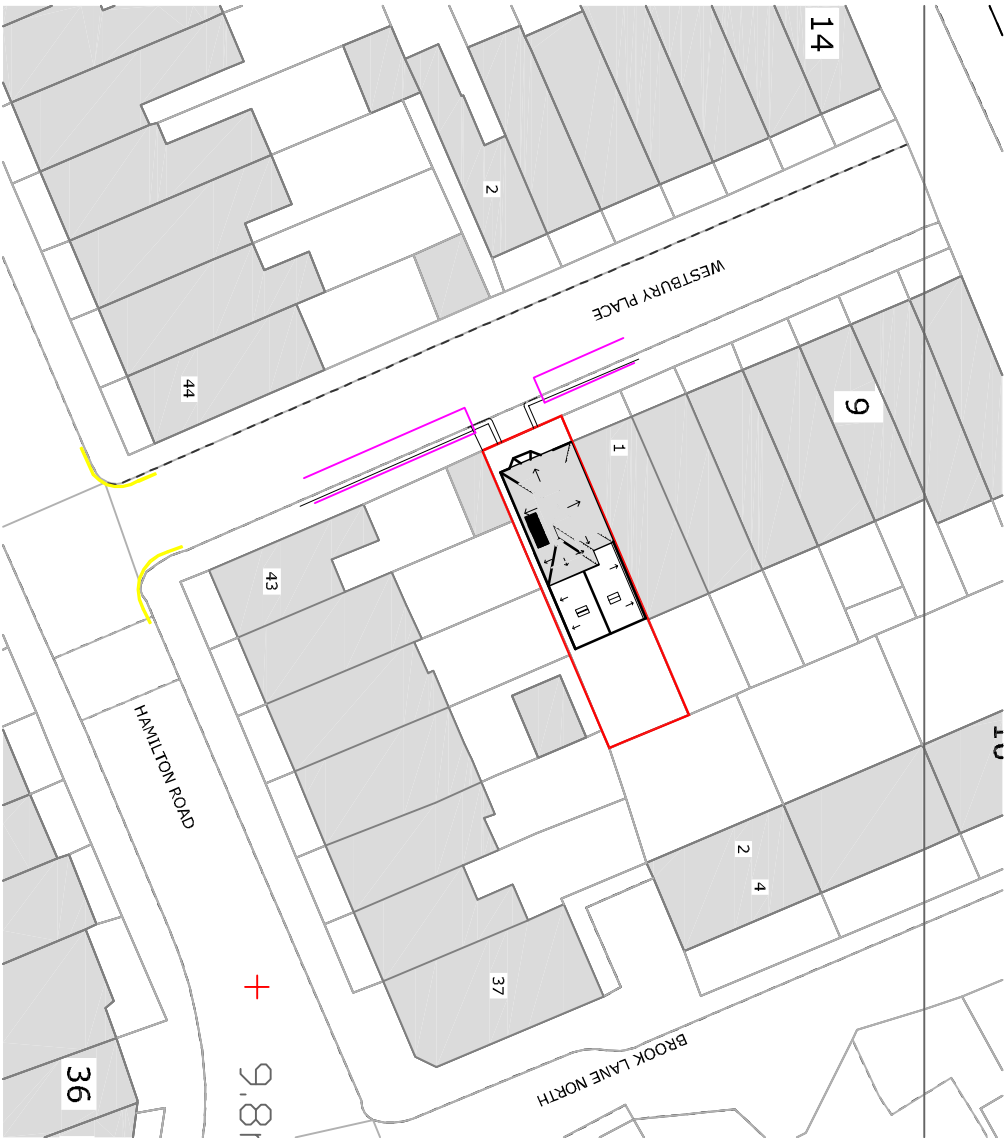
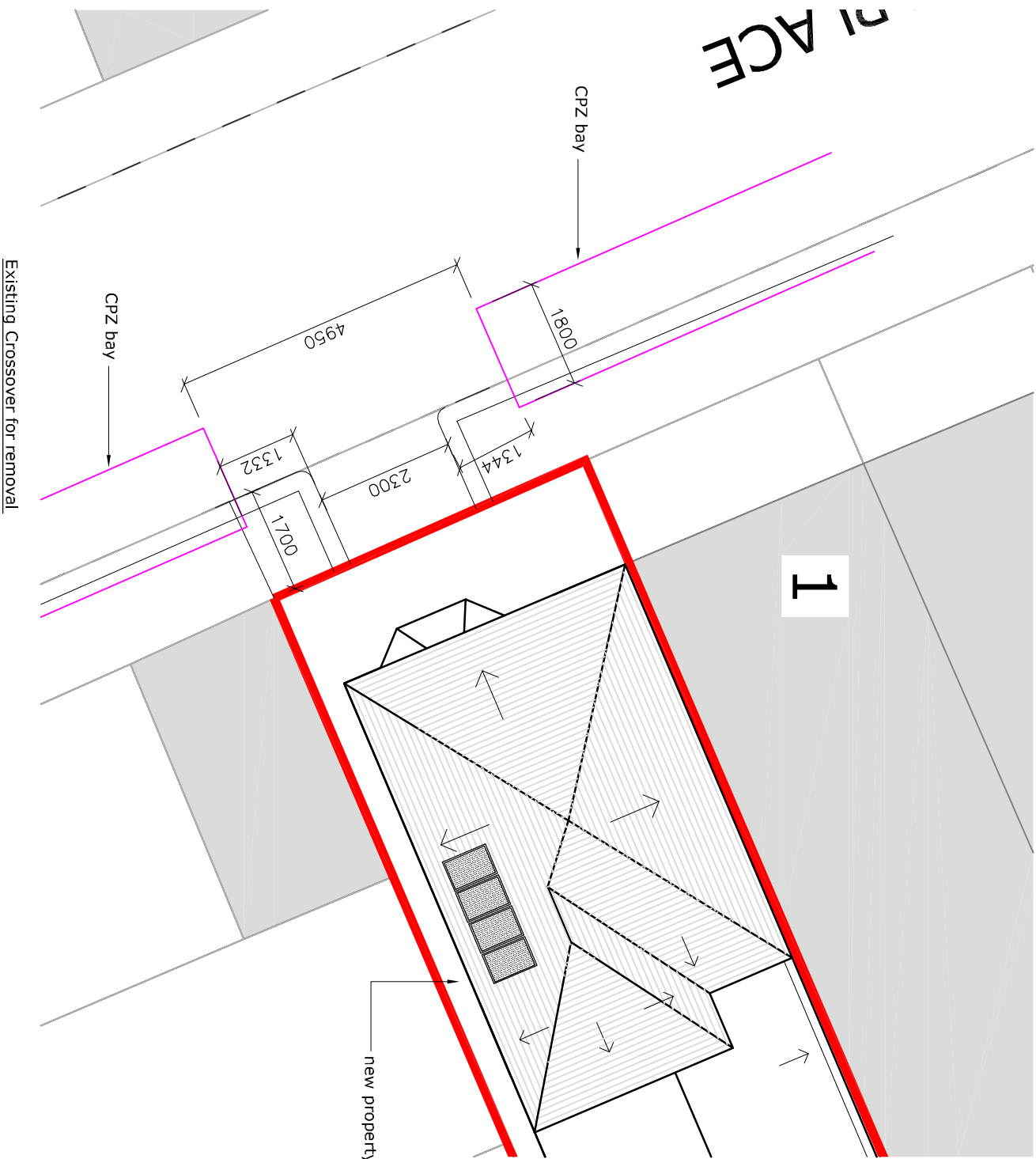

Location Plan 1:1250

Location Plan 1:500

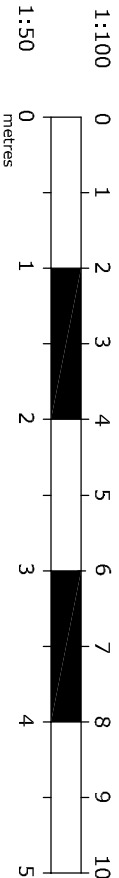

REV	DESCRIPTION	DATE
D	amended for highways	17.12.24
C	amended for highways	12.08.24
B	amended for highways	29.07.24

PROJECT	1a Westbury Place Brentford TW8 0QG
DETAIL	New Dwelling Logistics Plan

SCALE	1:100 @ A3
DRAWN	W/F
DATE	Dec 2023
CONTRACT DRAWING	SO-034-20
REV.	D



# Traffic Management Order

2008 No.24

---

The London Borough of Hounslow (Waiting and Loading Restriction) (Civil Enforcement Area)  
Order 2008

Made on 4 August 2008

Coming into operation on 11 August 2008

---

## ARRANGEMENT OF ARTICLES

### PART I

	Article
Commencement and citation .. .. .	1
Revocation .. .. .	2
Interpretation .. .. .	3
Application of Order .. .. .	4

### PART II

#### RESTRICTIONS

	Article
Restrictions applicable to streets specified in Schedule 1, Schedule 2 or Schedule 6 .. .. .	5
Restrictions applicable to restricted streets Specified in Schedule 4, 4A and 4B . . . . .	6
Restrictions applicable to streets specified in Schedule 5 .. .. .	7

### PART III

#### CONTRAVENTION OF WAITING RESTRICTIONS

	Article
Restriction on vehicles .. .. .	8
Contravention of waiting restrictions .. .. .	9
Manner of payment of penalty charge .. .. .	10
Removal of vehicle from waiting restrictions .. .. .	11

PART IV  
EXCEPTIONS AND EXEMPTIONS FROM RESTRICTIONS

	Article
Persons boarding or alighting from vehicles .. .. .	12
Excepted vehicles .. .. .	13
Furniture removals and other exceptional loading or unloading ..	14
Miscellaneous exemptions .. .. .	15

PART V  
ADDITIONAL PROVISIONS

	Article
Duty to move on .. .. .	16
Restrictions on methods of loading or unloading vehicles .. ..	17
Restriction on street trading .. .. .	18
Restriction on advertising .. .. .	19
Power to suspend the use of a motor cycle parking area .. ..	20

SCHEDULES

	Page
1. Restricted streets referred to in Article 5(1) .. .. .	11
2. Streets referred to in Article 5(2)(a) .. .. .	227
3. Prescribed/restricted hours .. .. .	261
4. Restricted streets referred to in Article 6 .. .. .	265
5. Restricted streets referred to in Article 7 where stopping is restricted. ..	268
6. Streets referred to in Articles 5(2)(b)(i) and 12 .. .. .	270
7. Side streets (adjoining restricted streets specified in Schedule 1) excepted from the definition of restricted street .. .. .	271
8. Motor cycle parking areas .. .. .	278

The London Borough of Hounslow, after consulting the Commissioner of Police of the Metropolis, in exercise of powers conferred by sections 6 and 124 of and Part IV of Schedule 9 to the Road Traffic Regulation Act 1984<sup>a</sup>, as amended by section 8 and Schedule 5 of the Local Government Act 1985<sup>b</sup>, the Road Traffic Act 1991<sup>c</sup> and Part 6 of the Traffic Management Act 2004<sup>d</sup> and of all other powers thereunto enabling hereby make the following Order:

<sup>a</sup> 1984 c.27

<sup>b</sup> 1985 c.51

<sup>c</sup> 1991 c.40

<sup>d</sup> 2004 c.18



## **PART I**

### **Commencement and citation**

1. This Order shall come into operation on 11 August 2008 and may be cited as the London Borough of Hounslow (Waiting and Loading Restriction) (Civil Enforcement Area) Order 2008.

### **Revocation**

2. Without prejudice to the validity of anything done or to any liability incurred in respect of any act or omission before the coming into operation of this Order, the Hounslow (Waiting and Loading Restriction) Order 1977<sup>a</sup> is hereby revoked.

### **Interpretation**

3. (1) In this Order, except where the context otherwise requires:
  - “bus” has the same meaning as in Regulation 22 of the Traffic Signs Regulations and General Directions 2002<sup>b</sup>;
  - “civil enforcement officer” means a person appointed by or on behalf of the Council to enforce the restrictions imposed by this Order;
  - “Council” means the Council of the London Borough of Hounslow;
  - “enactment” means any enactment, whether public general or local, and includes any order, byelaw, rule, regulation, scheme or other instrument having effect by virtue of an enactment;
  - “goods” means goods of any kind whether animate or inanimate and includes postal packets of any description; and “delivering” and “collecting”, in relation to any goods, include checking the goods for the purpose of their delivery or collection;
  - “goods vehicle” has the same meaning as in the Traffic Signs Regulations and General Directions 2002;
  - “motor cycle parking area” means that part of a restricted street specified in Schedule 8;
  - “parking contravention” has the meaning assigned to it in Part 1 of Schedule 7 of the Traffic Management Act 2004;
  - “penalty charge and reduced penalty charge” means the charge set by the Council under the provisions of the Road Traffic Act 1991 or Part 6 of the Traffic Management Act 2004 and following approval of the Secretary of State or the Mayor of London, which is to be paid to the Council, which in the case of a penalty charge is to be paid within 28 days beginning on the date of the Notice, or in the case of a reduced penalty charge is to be paid following the issue of a penalty charge notice within 14 or 21 days of the issue or service of that notice;
  - “prescribed hours”, in relation to a restricted street, means the time specified in column 2 of Schedule 3 in relation to the letter set out in column 1 of the Schedule and which letter is the letter set out in column 3 of Schedule 1 or 4 in relation to that street;
  - “provision of a universal postal service” and “universal service provider” have the same meanings as in Section 126 of the Postal Services Act 2000<sup>c</sup>;
  - “restricted hours”, in relation to any street specified in Schedule 2 means the time specified in column 2 of Schedule 3 and which number set out in column 3 of Schedule 2 in relation to that street;

---

<sup>a</sup> GLC1977/642 – including all amendments up to 2008/15

<sup>b</sup> SI.2002/3113 (as amended)

<sup>c</sup> 2000 c.26

“restricted street” means any street within the London Borough of Hounslow specified in Schedule 1 or 4 (hereinafter referred to as a “scheduled street”) and includes, except where the context otherwise requires, so much of every other street within that London Borough which is not a scheduled street or a street specified in Schedule 5 and which joins any scheduled street specified in Schedule 1 as lies between the kerb-line of the scheduled street and a point 18.29 metres distant there from, and any reference in this Order to any restricted street specified in Schedule 1 shall be construed accordingly:

Provided that the expression “restricted street” shall not for the purpose of this Order include:

- (a) any area on a highway or any place within the London Borough of Hounslow for the time being designated or described as a parking place by any Order made or having effect as if made or having effect as if made under section 6, section 32 (as extended by section 63 thereof) or section 45 of the Road Traffic Regulation Act 1984; or
- (b) in its application to a street specified in column 1 of Schedule 7, that the length of street which extends 18.29 metres measured in the direction specified in column 2 of that Schedule from the kerb-line of the scheduled street specified in column 3 of that Schedule,

and in this definition the expression “kerb-line” in relation to a scheduled street shall mean that imaginary line which is the projection of the lines formed by the edge of the main carriageway of the scheduled street adjacent to its junction with the side in question of any other street”;

“Scheduled” means a Schedule to this Order;

“street” includes any part of the street;

“telecommunications system” has the same meaning as in the Telecommunications Act 1984<sup>a</sup>.

(2) For the purpose of this order a vehicle shall be deemed to wait:

- (a) in a restricted street if any point in that street is below the vehicle or its load (if any) and the vehicle is stationary; or
- (b) for more than a specified period in the same place in a restricted street if any one point in that street is below the vehicle or its load (if any) throughout a period exceeding the specified period whether or not that vehicle is moved during that period.

- (3) Any reference in this Order to any enactment shall be construed as a reference to that enactment as amended, applied, consolidated, re-enacted by or as having effect by virtue of any subsequent enactment.
- (4) Any reference in this Order to a length of street shall, unless otherwise specified, be construed as a reference to the whole width of that length of street.
- (5) The Interpretation Act 1978<sup>b</sup> shall apply for the interpretation of this Order as it applies for the interpretation of an Act of Parliament
- (6) The restrictions, prohibitions and requirements imposed by this Order are in addition to and not in derogation of any restrictions, prohibitions or requirement imposed by any other enactment and any exception for exemption from the provisions of this Order is without prejudice to the provisions of any other enactment.

---

<sup>a</sup> 1984 c.12(b)

<sup>b</sup> 1978 c.30

- (7) For the purposes of this Order a vehicle shall be regarded as displaying a disabled persons' badge and parking disc in the relevant position when it is so regarded for purposes of Regulation 3(1) of the Local Authorities' Traffic Orders (Exemption for Disabled Persons) (England and Wales) Regulations 2000<sup>a</sup> and "relevant position" has the same meaning as in Regulation 4 of those Regulations.

### **Application of Order**

4. The restrictions imposed by Part II of this Order are subject to the exceptions and exemptions set out in Part III of this Order, and any such exceptions or exemptions are subject to the provisions of Part IV of this Order.

## **PART II**

### **RESTRICTIONS**

#### **Restrictions applicable to streets specified in Schedule 1, Schedule 2 or Schedule 6**

5. (1) No person shall cause or permit any vehicle to wait during the prescribed hours in any restricted street specified in Schedule 1 except, subject to the provisions of the next paragraph, for so long as may be necessary for the purpose of delivering or collecting goods or loading or unloading the vehicle at premises adjacent to the street.
- (2) No person shall cause or permit any vehicle to wait for the purpose of delivering or collecting goods or loading or unloading the vehicle –
- (a) in any of the streets specified in Schedule 2 (which consist of restricted streets or parts thereof specified in Schedule 1) during the restricted hours, or
  - (b) without prejudice to the provisions of the last fore-going sub-paragraph –
    - (i) for a period of more than forty minutes in the same place during the prescribed hours in any part of the street in the London Borough of Hounslow specified in Schedule 6 which is a restricted street; or
    - (ii) for a period of more than forty minutes in the same place during the prescribed hours in any other restricted streets specified in Schedule 1.

#### **Restrictions applicable to restricted streets specified in Schedules 4, 4A and 4B**

6. (1) No person shall cause or permit any vehicle to wait during the prescribed hours in any restricted street specified in Schedule 4 –
- (a) for a longer period than 20 minutes or,
  - (b) if a period of less than 20 minutes has elapsed since the termination during the prescribed hours of the last period of waiting (if any) of the vehicle in that street;
- (2) No person shall cause or permit any vehicle to wait during the prescribed hours in any restricted street specified in Schedule 4A –
- (a) for a longer period than 30 minutes or,
  - (b) if a period of less than 1 hour has elapsed since the termination during the prescribed hours of the last period of waiting (if any) of the vehicle in that street;
- (3) No person shall cause or permit any vehicle to wait during the prescribed hours in any restricted street specified in Schedule 4B –

---

<sup>a</sup> SI.2000/683

- (a) for a longer period than 1 hour or,
- (b) if a period of less than an 1 hour has elapsed since the termination during the prescribed hours of the last period of waiting (if any) of the vehicle in that street;

**Provided that**

- (i) for the purposes of sub-paragraphs 1(b), 2(b) or 3(b) of this Article no account shall be taken of any period during which a vehicle is waiting in that street for any purpose specified in Part IV of this Order;
- (ii) nothing in sub-paragraphs 1(b), 2(b) or 3(b) of this Article shall apply in respect of a disabled person's vehicle which displays in the relevant position a disabled person's badge issued by any local authority.

**Restrictions applicable to streets specified in Schedule 5**

- 7. No person shall cause or permit any vehicle to stop or remain at rest in any street specified in Schedule 5

**PART III**

**CONTRAVENTION OF WAITING RESTRICTIONS**

**Restriction on vehicles**

- 8. Without prejudice to the validity of anything done or to any liability incurred in respect of any act or omission before the coming into operation of this Order, no person shall cause or permit any motor vehicle to wait in any prescribed or restricted street during the prescribed hours.

**Contravention of waiting restrictions**

- 9. Except as provided in Article 13 of this Order, if a vehicle waits in any street referred to in the Schedules to this Order during the prescribed hours a parking contravention shall have occurred and a penalty charge shall be payable. A penalty charge notice may then be issued by a civil enforcement officer or served by the Council.

**Manner of payment of the penalty charge**

- 10. The penalty charge shall be paid to the Council by cash, cheque, postal order or other accepted means which shall be delivered or sent by post to the Finance Department of the Council at the address indicated on the penalty charge notice and in accordance with instructions on that notice, to arrive during the hours when such office is open, or to be paid by credit card or debit card by telephone or other means as the Council may from time to time allow -
  - (a) on the fourteenth day in the case of a reduced penalty charge where the notice was issued under Regulation 9 of the Civil Enforcement of Parking Contraventions (England) General Regulations 2007 beginning on the date the notice was served;
  - (b) on the twenty-first day in the case of a reduced penalty charge where the notice was issued under Regulation 10 of those Regulations beginning on the date the notice was served; or
  - (c) on the twenty-eighth day in the case of a penalty charge, beginning on the date the notice was served:-

Provided that, if the said fourteenth, twenty-first or twenty-eighth day falls upon a day on which the said payment office is closed, the period within which payment of the said charge

shall be payable to the Council shall be extended until the next day on which the office is open.

#### **Removal of a vehicle from waiting restrictions**

11. Where a civil enforcement officer is of the opinion that any of the provisions contained in Articles 8 or 9 of this Order have been contravened or not complied with they may, under the provisions of the Road Traffic Act 1991, the Traffic Management Act 2004 and the Removal and Disposal of Vehicles Regulations 1986, remove or cause to be removed the vehicle from the waiting restriction and, where it is so removed, shall provide for its safe custody of the vehicle.

### **PART IV**

#### **EXCEPTIONS AND EXEMPTIONS FROM RESTRICTIONS**

##### **Persons boarding or alighting from vehicles**

12. Nothing in Article 5 or 6 of this Order shall render it unlawful to cause or permit a vehicle to wait in any restricted street for so long as may be necessary for the purpose of enabling any person to board or alight from the vehicle or to load thereon or unload therefrom his personal luggage:

##### **Excepted Vehicles**

13. The restrictions imposed by Part II of this Order shall not apply in relation to the following vehicles, that is to say –
- (a) public service vehicles operated by Transport for London whilst waiting at an authorised stopping place or at a terminal or turning point;
  - (b) vehicles when used for fire brigade, ambulance or police purposes;
  - (c) vehicles when used in the service of a local authority in pursuance of statutory powers or duties provided that in all the circumstances it is reasonably necessary in the exercise of such powers or the performance of such duties for the vehicle to wait in the place in which it is waiting;
  - (d) hackney carriages whilst waiting upon any duly authorised cab rank;
  - (e) vehicles whilst waiting in any restricted street for so long as may be necessary in connection with the taking in of petrol, oil, water or air, if such taking in cannot be effected unless the vehicle waits in that place where it is waiting.
  - (f) a motor cycle propelled by mechanical power, not being an invalid carriage, with less than four wheels and the weight of which does not exceed 410 kilograms whilst waiting wholly within the limits of a motor cycle parking area.

##### **Furniture removals and other exceptional loading or unloading**

- 14 (1) Nothing in Article 5 or 6 of this Order shall apply so as to restrict the loading or unloading of any vehicle while the vehicle is in actual use in any restricted street in connection with the removal of furniture to or from one office, dwelling-house or depository adjacent to that restricted street from or to another office, dwelling-house or depository:

Provided that this paragraph shall not apply to a vehicle waiting in any restricted street to which the provisions of Article 5(2)(a) or 6 of this Order apply unless notice is given twenty-four hours in advance to the London Borough of Hounslow, their consent is obtained, and such reasonable conditions as they may impose are complied with.

- (2) Without prejudice to the provisions of the last foregoing paragraph, nothing in Article 5 or 6 of this Order shall apply so as to restrict the loading or unloading of any vehicle

while the vehicle is in actual use in any restricted street in connection with the collection or delivery of goods from or to premises in or adjacent to that street if those goods cannot reasonably be loaded or unloaded outside the prescribed hours or within the time (if any) allowed in relation to that street, as the case may be, if notice is given twenty-four hours in advance to the London Borough of Hounslow, their consent is obtained, and such reasonable conditions as they may impose are complied with.

### **Miscellaneous exemptions**

- 15 (1) Nothing in Part II of this Order shall render it unlawful to cause or permit a vehicle to wait in any restricted street or remain at rest in any street specified in Schedule 5 –
- (a) while postal packets addressed to premises adjacent to any such street in which a vehicle bearing a livery which is used by a universal service provider and which is waiting for as long as may be necessary for the purpose of the provision of a universal postal service;
  - (b) while the vehicle is being used in connection with any building operation, demolition or excavation in or adjacent to any such street, the removal of any obstruction to traffic in any street, the maintenance, improvement, reconstruction, cleansing or lighting of any street, the laying, erection, alteration or repair in or adjacent to any street of any sewer or of any main, pipe or apparatus for the supply of gas, water or electricity, or of any telegraphic line, or the placing, maintenance or removal of any traffic sign, if the vehicle cannot conveniently and lawfully be used for that purpose in any street not being a street specified in Schedule 5 or a restricted street or outside the prescribed hours;
  - (c) while any gate or other barrier at the entrance to premises, to which the vehicle requires access or from which it has emerged is being opened or closed, if it is not reasonably practicable for the vehicle to wait in any other place while such gate or barrier is being opened or closed.
- (2) Nothing in Part II of this Order shall apply to anything done with the permission or at the direction of a police constable in uniform or where the person in control of the vehicle is required by law to stop, or wait or remain at rest, or is obliged to do so in order to avoid an accident.
- (3) Nothing in Article 5 or 6 of this Order shall render it unlawful for a person who is licensed by the Council of the London Borough of Hounslow to sell goods from a stationary vehicle on a pitch in any restricted street to cause or permit a vehicle to wait on that pitch for that purpose.
- (4) Nothing in Article 7 of this Order shall render it unlawful to cause or permit a vehicle to stop in any street specified in Schedule 5 if that vehicle thereupon remains at rest for any reason specified in paragraph (1) of this Article.

## **PART V**

### **ADDITIONAL PROVISIONS**

#### **Duty to move on**

16. Notwithstanding any exception or exemption contained in this Order, the person in control of a vehicle waiting during the prescribed hours in any restricted street or in any street specified in Schedule 5 shall move the vehicle on the instructions of a police constable in uniform whenever such moving may be reasonably necessary for the purpose of preventing or removing obstructions.

### **Restriction on methods of loading or unloading vehicles**

- 17 (1) No person shall cause any goods to be loaded on to or unloaded from any vehicle in any street in the London Borough of Hounslow otherwise than in accordance with the following conditions, that is to say-
- (d) no such goods shall be deposited on any carriageway or footway except on the carriageway immediately at the rear of the vehicle and no goods shall remain on any carriageway before the arrival of or after the departure of the vehicle;
  - (b) no part of any rope, chain, wire, apparatus or machinery used in connection with such loading or unloading and no load suspended therefrom, shall be less than 4.88 metres above a carriageway, except when over any vehicle being loaded or unloaded, or less than 2.74 metres above the footway;
  - (c) no such goods shall be passed from hand to hand across any part of any carriageway or footway;
- Provided that nothing in this Article shall apply in relation to –
- (i) any vehicle specified in sub-paragraph (b) or sub-paragraph (c) of Article 13 of this Order or any vehicle while it is being used as mentioned in paragraph (1)(c) or Article 15 of this Order; or
  - (ii) anything done with the permission or at the direction of a police constable in uniform.
- (2) Nothing in sub-paragraph (b) of paragraph (1) of this Article shall apply to any pipe, apparatus or machinery being used in connection with loading or unloading of any petrol, water, oil or liquid fuel on to or from any vehicle in any street or from any premises adjacent to any street, provided that all necessary means are taken to give adequate warning of any possible obstruction.

### **Restriction on street trading**

18. No person shall, on any day other than on Sunday, sell, offer or expose for sale goods from a vehicle which is in any restricted street unless –
- (a) that person is licensed by the Council of the London Borough of Hounslow to sell goods from a stationary vehicle on a pitch in that street and sells goods from that pitch; or
  - (b) the goods are immediately delivered at or taken into premises adjacent to the vehicle from which the sale is affected.

### **Restriction on advertising**

19. No person shall in any restricted street or in any street specified in Schedule 5, either wholly or mainly for the purposes of advertisement, ride, drive, conduct, use or employ or cause to be ridden, driven, conducted, used or employed any animal or vehicle of any kind, or wear or cause to be worn any fancy dress or other costume.

### **Power to suspend the use of a motor cycle parking area**

20. (1) Notwithstanding any other provision of this Order, the council of the London Borough of Hounslow or the Commissioner of Police of the Metropolis, on the occasion of any public procession or for other good and sufficient reason, or a civil enforcement officer or a police constable or traffic warden in uniform, in case of an emergency, may suspend the use of any motor cycle parking area or any part thereof during such period as may be reasonably necessary;
- (2) the Council of the London Borough of Hounslow or the Commissioner of Police of the Metropolis, or a civil enforcement officer or a police officer or traffic warden in

uniform suspending the use of a motor cycle parking area or any part thereof in accordance with the provisions of paragraph (1) of this Article, shall thereupon place or cause to be placed in or adjacent to that motor cycle parking area or that part thereof, as the case may be, the use of which is suspended, a traffic sign indicating that the waiting of vehicles is prohibited;

- (3) no person shall cause or permit a vehicle to wait in a motor cycle parking area or any part thereof during such period that there is in or adjacent to that motor cycle parking area or that part thereof, as the case may be, a traffic sign placed in pursuance of paragraph (2) of this Article:

Provided that nothing in this paragraph shall apply to anything done with the permission of the Council of the London Borough of Hounslow or the Commissioner of Police of the Metropolis or a civil enforcement officer or a police constable or traffic warden in uniform or in relation to any vehicle being used for fire brigade, ambulance or police purposes or to any vehicle which is waiting for any reason specified in Article 15(2)

Dated this fourth day of August 2008.



 Director of Environment  
(The officer appointed for this purpose)



# Traffic Management Order

2024 No.51

---

The London Borough of Hounslow (Waiting and Loading Restriction) (Amendment No.347) Order 2024

Made on 15<sup>th</sup> October 2024

Coming into operation on 19<sup>th</sup> October 2024

---

The Council of the London Borough of Hounslow, after consulting the Commissioner of Police of the Metropolis, in exercise of the powers conferred by sections 6 and 124 to the Road Traffic Regulation Act 1984<sup>1</sup> as amended, and of all other enabling powers hereby make the following Order:

## Citation and Commencement

- 1 This Order shall come into operation on 19<sup>th</sup> October 2024 and may be cited as the London Borough of Hounslow (Waiting and Loading Restriction) (Amendment No.347) Order 2024.

## Interpretation

- 2 (1) In this Order the “Order of 2008” means The London Borough of Hounslow (Waiting and Loading Restriction) Order 2008.
- (2) Unless the context otherwise requires, any expression used in this Order which is also used in the Order of 2008 shall have the same meaning as in that Order.
- (3) Any reference in this Order to any enactment shall be construed as a reference to that enactment as amended, applied, consolidated, re-enacted by or as having effect by virtue of any subsequent enactment.

## Revocation and/or Designation of Parking Places

- 3 Without prejudice to the validity of anything done or to any liability incurred in respect of any act or omission before the coming into force of this Order, the Order of 2008 shall have effect as though:
- a. the items numbered 9, 12, 43, 46, 50, 227, 233, 234, 294, 349, 355, 449, 615, 630, 723, 735, 780, 790, 852, 952, 994, 1044, 1335, 1339, 1407, 1499 in Schedule 1 to that Order was substituted with the items similarly numbered and set out in Schedule 1 to this Order;

- b. the items numbered 50 and 232 in Schedule 2 to that Order was substituted with the items similarly numbered and set out in Schedule 2 to this Order;
- c. Schedule 3 to that order there were substituted with Schedule 3 to this Order.

Dated this 15<sup>th</sup> day of October 2024



Assistant Director for Traffic, Transport & Parking  
(the officer appointed for the purpose)

**SCHEDULE 1**  
**RESTRICTED STREETS REFERRED TO IN ARTICLE 5(1)**

1 Item Number	2 Street	3 Prescribed hours - see Schedule 3
9	<p>ai Alexandra Gardens, Chiswick, north-west side north-west side from the junction with Riverside Drive to a point 7.5 metres south-west of the south-western building line of Nos. 1-11 Alexandra Gardens</p> <p>aii Alexandra Gardens, Chiswick, north-west side from a point 4 metres north-east of the north-eastern building line of Nos. 1-11 Alexandra Gardens to the north-eastern extremity of Alexandra Gardens, including the turning head</p> <p>bi Alexandra Gardens, Chiswick, south-east side from the junction with Riverside Drive to a point 17.5 metres south-west of the south-western building line of Nos. 1-11 Alexandra Gardens</p> <p>bii Alexandra Gardens, Chiswick, south-east side from the north-eastern building line of Nos. 1-11 Alexandra Gardens to the north-eastern extremity of Alexandra Gardens</p>	<p>A</p> <p>A</p> <p>A</p> <p>A</p>
12	<p>ai Alexandra Road, Hounslow, north-east side from the junction with Lampton Road to the common boundary of Nos. 39 &amp; 41 Alexandra Road</p> <p>aii Alexandra Road, Hounslow, north-east side from the common boundary of Nos. 39 &amp; 41 Alexandra Road to a point 3 metres south of the common boundary of Nos. 37 &amp; 39 Alexandra Road</p> <p>aiii Alexandra Road, Hounslow, north-east side from a point 14 metres south of the common boundary of Nos. 37 &amp; 39 Alexandra Road to a point a point 4 metres south of the southern boundary of No. 1 Alexandra Road</p> <p>aiv Alexandra Road, Hounslow, north-east side from a point 4 metres north of the northern boundary of No. 2 Alexandra Road to the southern extremity of Alexandra Road, including the turning head</p> <p>bi Alexandra Road, Hounslow, south-west side from a point 5 metres north of the junction with Lansdowne Road to the southern extremity of Alexandra Road</p>	<p>A</p> <p>CC</p> <p>CC</p> <p>A</p> <p>A</p>

	bii Alexandra Road, Hounslow, north-east side from a point 5 metres north of the junction with Lansdowne Road to the northern boundary of No. 2 Alexandra Road	TTT
	biii Alexandra Road, Hounslow, north-east side from the northern boundary of No. 2 Alexandra Road northwards for a distance of 11.5 metres	CC
	biv Alexandra Road, Hounslow, north-east side from a point 7 metres south of the common boundary of Nos. 4 & 6 Alexandra Road southwards for a distance of 5.5 metres	CC

### SCHEDULE 1 (continued)

1 Item Number	2 Street	3 Prescribed hours - see Schedule 3
12 (continued)	biii Alexandra Road, Hounslow, north-east side from the northern boundary of No. 2 Alexandra Road northwards for a distance of 11.5 metres  biv Alexandra Road, Hounslow, north-east side from a point 7 metres south of the common boundary of Nos. 4 & 6 Alexandra Road southwards for a distance of 5.5 metres  bv Alexandra Road, Hounslow north-east side from a point 4 metres south of the common boundary of Nos. 32 & 34 Alexandra Road to a point 2.5 metres north of the common boundary of Nos. 28 & 30 Alexandra Road  bvi Alexandra Road, Hounslow north-east side from a point 3.5 metres north-west of the boundary wall of Nos. 37 & 39 Alexandra Road to a point 17 metres north-west of the boundary wall of Nos. 34 & 36 Alexandra Road  bvii Alexandra Road, Hounslow north-east side from a point 15 metres north-west of the south-eastern building line of No. 41 Alexandra Road to the junction with Lampton Road	CC  CC  CC  CC  A
43	ai Basildene Road, Hounslow, both sides from the junction with the access road fronting Nos. 334-450 Bath Road to the southern building line of No. 440a Bath Road	A

### SCHEDULE 1 (continued)

1 Item Number	2 Street	3 Prescribed hours - see Schedule 3
43 (continued)	bii Basildene Road, Hounslow, both sides, from a point 8 metres north of the junction with Clifford Road to a point 8 metres south of the junction with Clifford Road	A
	bi Basildene Road, Hounslow, west side, from the southern building line of No. 440a Bath Road to a point 1 metre south of the northern boundary of No. 2 Basildene Road	FF
	bii Basildene Road, Hounslow, west side, from a point 4.5 metres south of the common boundary of Nos. 21 & 23 Basildene Road to a point 4 metres south of the common boundary of Nos. 62 & 64 Basildene Road	A
	biii Basildene Road, Hounslow, west side, from a point 10 metres north of the junction with Vincent Road to a point 10 metres south of the junction with Vincent Road	A
	biv Basildene Road, Hounslow, west side, from a point 7 metres north of the junction with Marnell Way to a point 7 metres south of the junction with Marnell Way	A
	bv Basildene Road, Hounslow, west side, from its junction with Beavers Lane northwards for a distance of 10 metres	A
	ci Basildene Road, Hounslow, east side, from the southern building line of No. 438 Bath Road to the southern building line of No. 8 Basildene Road	FF
	cii Basildene Road, Hounslow, east side, from the southern building line of No. 8 Basildene Road to the common boundary of Nos. 1a and 1 Basildene Road	A
	ciii Basildene Road, Hounslow, east side, from a point 1 metre south of the common boundary of Nos. 21 & 23 Basildene Road to a point 3.5 metres south of the common boundary of Nos. 50 & 52 Basildene Road	A
	civ Basildene Road, Hounslow, east side, from the junction with Beavers Lane northwards for a distance of 12.5 metres	A
46	ai Bath Road, Chiswick, north-west side, from the junction with Turnham Green Terrace to a point 12.5 metres east of the eastern building line of No. 7 Bedford Park Corner	A

### SCHEDULE 1 (continued)

1 Item Number	2 Street	3 Prescribed hours - see Schedule 3
	a ii Bath Road, Chiswick, north-west side, from a point 12.5 metres north-east of the eastern building line of No. 7 Bedford Park Corner to a point 21.5 metres south-west of the south-western boundary of No. 4 Bath Road	G
	a iii Bath Road, Chiswick, north-west side, from a point 21.5 metres south-west of the western boundary of No. 4 Bath Road to a point 9.5 metres south-west of the party wall of Nos. 1 & 3 Bath Road	A
	a iv Bath Road, Chiswick, north-west side, from a point 9.5 metres south-west of the common boundary of Nos. 3 & 5 Bath Road to a point 9.5 metres south-west of the north-eastern boundary of No. 1 Rupert Road	G
	a v Bath Road, Chiswick, north west side, from a point 9.5 metres south-west of the eastern boundary of No. 1 Rupert Road to the south-western boundary of No. 28 Bath Road	A
	a vi Bath Road, Chiswick, north-west side, from the south-western boundary of No. 28 Bath Road to the south-western boundary of No. 17 Bath Road	G
	a vii Bath Road, Chiswick, north-west side, from the south-western boundary of No. 17 Bath Road to a point 1.5 metres north-east of the common boundary of Nos. 27 & 29 Bath Road	A
	a viii Bath Road, Chiswick, north-west side, from a point 1.5 metres north-east of the common boundary of Nos. 27 & 29 Bath Road to the common boundary of Nos. 50 & 52 Bath Road	G
	a ix Bath Road, Chiswick, north-west side, from the common boundary of Nos. 50 & 52 Bath Road to the common boundary of Nos. 62 & 64 Bath Road	A
	b i Bath Road, Chiswick, south-east side, from the junction with Turnham Green Terrace to a point 9.5 metres south-west of the common boundary of Nos. 1 & 3 Bath Road	A
	b ii Bath Road, Chiswick, south-east side, from a point 9.5 metres south-west of the common boundary of Nos. 1 & 3 Bath Road to the common boundary of Nos. 34 & 36 Bath Road	G

### SCHEDULE 1 (continued)

1 Item Number	2 Street	3 Prescribed hours - see Schedule 3
50	biii Bath Road, Chiswick, south-east side, from the common boundary of Nos. 34 & 36 Bath Road to a point 1.5 metres north-east of the common boundary of Nos. 27 & 29 Bath Road	A
	biv Bath Road, Chiswick, south-east side, from a point 1.5 metres north-east of the common boundary of Nos. 27 & 29 Bath Road to the common boundary of Nos. 46 & 48 Bath Road	G
	bv Bath Road, Chiswick, south-east side, from the common boundary of Nos. 46 & 48 Bath Road to the common boundary of Nos. 62 & 64 Bath Road	A
	ai Beavers Lane, Hounslow, both sides, from the junction with Martindale Road to the western building line of No. 1 Beavers Lane	A
	aii Beavers Lane, Hounslow, both sides, from a point 10 metres east of the eastern building line of No. 91 Chester Road to a point 6.5 metres west of the western building line of No. 213 Beavers Lane	A
	aiii Beavers Lane, Hounslow, both sides, from a point 1.5 metres south of the southern building line of No. 209 Beavers Lane southwards for a distance of 7 metres	A
	aiv Beavers Lane, Hounslow, both sides, from the northern building line of No. 136 Great South West Road northwards for a distance of 8 metres	A
	av Beavers Lane, Hounslow, both sides, from the western boundary line of No. 215 Beavers Lane westwards to the access to the Church of Good Shepherd car park	A
	bi Beavers Lane, Hounslow, north-east side, from a point 2 metres east of the common boundary of Nos. 20a & 22 Beavers Lane to the common boundary of Nos. 4 & 6 Beavers Lane	A
	bii Beavers Lane, Hounslow, north-east side, from a point 3 metres east of the common boundary of Nos. 82 & 84 Beavers Lane to the common boundary of Nos. 28a & 30 Beavers Lane	A

### SCHEDULE 1 (continued)

1 Item Number	2 Street	3 Prescribed hours - see Schedule 3
50 (continued)	biii Beavers Lane, Hounslow, north-east side, from the party wall of Nos. 90 & 92 Beavers Lane to the eastern boundary of No. 5 Beavers Lane	A
	biv Beavers Lane, Hounslow, north-east side, from a point 10 metres north-west of the western kerb line of Basildene Road to a point 12 metres south-east of the eastern kerb line of Basildene Road	A
	bv Beavers Lane, Hounslow, north-east side, from the western building line of No. 47 Beavers Lane to the party wall of Nos. 37 & 39 Beavers Lane	A
	bvi Beavers Lane, Hounslow, north-east side, from a point 2 metres south-east of the party wall of Nos. 210 & 212 Beavers Lane to a point 7 metres north-west of the north-westernmost building line of Princess Court, Beavers Lane.	A
	ci Beavers Lane, Hounslow, south-west side, from the common boundary of Nos. 6 & 8 Beavers Lane to the common boundary of Nos. 12 & 14 Beavers Lane	A
	cii Beavers Lane, Hounslow, south-west side, from a point 21 metres east of the junction with Barrack Road to a point 17 metres west of the junction with Barrack Road	A
	ciii Beavers Lane, Hounslow, south-west side, from the western building line of No.80 Beavers Lane to the common boundary of Nos. 68 & 70 Beavers Lane	A
	civ Beavers Lane, Hounslow, south-west side, from the boundary wall of Nos. 92 & 94 Beavers Lane, north-westwards to a point 2 metres south-east of the party wall of Nos. 210 & 212 Beavers Lane	A
	cv Beavers Lane, Hounslow, south-west side, from a point 4 metres south-east of the party wall of Nos. 248 & 250 Beavers Lane to a point 18 metres north-west of the party wall of Nos. 109 & 111 Beavers Lane	A
	cvi Beavers Lane, Hounslow, south-west side, from the common boundary of Nos. 137 & 139 Beavers Lane to a point 3.5 metres north of the common boundary of Nos. 143 & 145 Beaver Lane	A



### SCHEDULE 1 (continued)

1 Item Number	2 Street	3 Prescribed hours - see Schedule 3
227	cvii Beavers Lane, Hounslow, south-west side, from a point 1.5 metres south-east of the party wall of Nos. 167 & 169 Beavers Lane to a point 1 metre south-east of the party wall of Nos. 159 & 161 Beavers Lane	A
	di Beavers Lane, Hounslow, south-east & south-west side, from a point 4 metres north-east of the western building line of No. 322 Beavers Lane to the party wall of Nos. 320 & 322 Beavers Lane	A
	ai Field Lane, Brentford, both sides, from the junction with London Road to the south-eastern boundary of Nos. 2-10 London Road	A
	bi Field Lane, Brentford, north-east side, from the south-eastern boundary of Nos. 2-10 London Road to a point 5 metres south-east of the north-western boundary of Nos. 2-10 London Road	D
	bii Field Lane, Brentford, north-east side, from a point 5 metres south-east to the south-eastern kerb line of Brickfield Close	A
	biii Field Lane, Brentford, north-east side, from a point 14 metres north-west of the north-western building line of No.1 Brickfield Close to a point 6 metres north-west of the south-eastern boundary line of No. 46 Mulberry Crescent	A
	biv Field Lane, Brentford, north-east side, from a point 6 metres north-west of the south-eastern boundary of No. 46 Mulberry Crescent north-westwards for a distance of 15.5 metres	CCCC
	bv Field Lane, Brentford, north-east side, from a point 21.5 metres north-west of the south-eastern boundary of No. 46 Field Lane to the north-western extremity of Field Lane, including the turning head	A
	ci Field Lane, Brentford, south-west side, from a point 2.5 metres south-east of the north-western boundary of Nos. 2-10 London Road to a point 7.5 metres north-west of the north-western boundary of Nos. 2-10 London Road	A
	cii Field Lane, Brentford, south-west side, from a point 5.5 metres north-west of the south-easternmost building line of Nos. 1-12 Brickfield Close to a point 8 metres south-east of the south-eastern building line of No. 4 Field Lane	A

### SCHEDULE 1 (continued)

1 Item Number	2 Street	3 Prescribed hours - see Schedule 3
227 (continued)	ciii Field Lane, Brentford, south-west side, from a point 2 metres south-east of the party wall of Nos. 6 & 8 Field Lane to a point 4.5 metres north-west of that party wall	CCCC
	civ Field Lane, Brentford, south-west side, from a point 2.5 metres north-west of the building line of No. 69 Field Lane to a point 5.5 metres north-west of the south-eastern building line of No. 46 Mulberry Crescent	A
	cv Field Lane, Brentford, south-west side, from a point 5.5 metres north-west of the south-eastern boundary line of No. 46 Mulberry Crescent north-westwards for a distance of 15.5 metres	CCCC
	cvi Field Lane, Brentford, south-west side, from a point 21 metres north-west of the south-eastern boundary of No. 46 Mulberry Crescent to the north-western extremity of Field Lane	A
	di Field Lane, Brentford, north-west side, from the north-eastern kerb-line of the main carriageway of Field Lane to the south-western building line of No. 69 Field Lane	A
	ei Field Lane, Brentford, north-east & north-west side, from a point 5.5 metres north-east of the party of Nos. 65 & 57 Field Lane to a point 4 metres north-west of the party of Nos. 41 & 43 Field Lane	A
	fi Field Lane, Brentford, south-east side, from the north-eastern kerb-line of the main carriageway of Field Lane to a point 9 metres south-west of the party wall of Nos. 65 & 67 Field Lane	A
233	ai Frampton Road, Hounslow, north-east side, from the junction with Staines Road to a point 11 metres south of the north-western building line of No. 1 Frampton Road	A
	aii Frampton Road, Hounslow, north-east side, from a point 4 metres north-west of the north-western building line of No. 9 Frampton Road to a point 3.5 metres south-east of the south-western building line of No. 14 Frampton Road	A
	aiii Frampton Road, Hounslow, north-east side, from a point 10.5 metres north-west of the north-western building line of No. 16	A

### SCHEDULE 1 (continued)

1 Item Number	2 Street	3 Prescribed hours - see Schedule 3
234	Frampton Road to a point 8 metres north-west of the south-western building line of No. 26 Frampton Road	
	aiv Frampton Road, Hounslow, north-east side, from the northern building line of No. 1 Beaulieu Close to the northern building line of No. 54 Beaulieu Close	A
	av Frampton Road, Hounslow, north-east side, from the party wall of Nos. 2 & 3 Cauldron Mews, Frampton Road to the party wall of Nos. 36 & 28 Frampton Road	A
	bi Frampton Road, Hounslow, north-east & north-west side, from a point 5 metres south-east of the south-eastern building line of No. 26 Frampton Road to a point 5.5 metres west of the western building line of No. 31 Linslade Close	A
	ci Frampton Road, Hounslow, north & north-east side, from a point 11 metres east of the eastern building line of No. 25 Linslade Close to a point 2.5 metres north-west of the south-eastern building line of No. 1 Bramley Way	A
	di Frampton Road, Hounslow, south-west side, from the junction with Staines Road to a point 2.5 metres west of the western building line of No. 6 Pickwick Close	A
	dii Frampton Road, Hounslow, south-west side, from a point 2 metres south of the northern building line of Flats 7-12 Berry Court to a point 5.5 metres south of the northern building line of No. 37 Frampton Road	A
	ei Frampton Road, Hounslow, south-east side, from a point 10.5 metres west of the western building line of No. 35 Heathlands Way to the south-eastern building line of No. 1 Bramley Way	A
	ai Francis Road, Hounslow, both side, from the junction with Rosemary Avenue to a point 2 metres west of the eastern building line of No. 7 Rosemary Avenue	A
	bi Francis Road, Hounslow, north side, from the junction with Basildene Road eastwards for a distance of 7.5 metres	A
	bii Francis Road, Hounslow, north side, from a point 10 metres west of the common boundary of Nos. 58 & 60 Francis Road to a point 2 metres west of the common boundary of Nos. 59 Francis Road & 1a Manor Avenue	A

**SCHEDULE 1 (continued)**

1 Item Number	2 Street	3 Prescribed hours - see Schedule 3
234 (Continued)	<p>ci Francis Road, Hounslow, south side, from the junction with Basildene Road eastwards for a distance of 10 metres</p> <p>cii Francis Road, Hounslow, south side, from a point 10 metres west of the common boundary of Nos. 58 &amp; 60 Francis Road to a point 3 metres west of the party wall of Nos. 59 &amp; 61 Francis Road</p>	<p>A</p> <p>A</p>
294	<p>ai Hounslow Road, Feltham, north-west side, from a point 1 metre north of the party wall of Nos. 194 &amp; 196 Hounslow Road to the junction with Staines Road</p> <p>a ii Hounslow Road, Feltham, north-west side, from the party wall of Nos. 141 &amp; 143 Hounslow Road to the party wall of Nos. 145 &amp; 147 Hounslow Road</p> <p>a iii Hounslow Road, Feltham, north-west side, from the common boundary of Nos. 117 &amp; 199 Hounslow Road to the party wall of Nos. 125 &amp; 127 Hounslow Road</p> <p>a iv Hounslow Road, Feltham, north-west side, from the party wall of Nos. 31 &amp; 33 Hounslow Road to northern building line of No. 79 Hounslow Road</p> <p>a v Hounslow Road, Feltham, north-west side, from a point 0.5 metres north-east of the party wall of Nos. 27 &amp; 29 Station Parade to a point 6 metres north-east of the common boundary of Nos. 50 &amp; 52 Hounslow Road</p> <p>a vi Hounslow Road, Feltham, north-west side, from a point 12.0 metres north-east of the south-western building line of No. 17 Station Parade to a point 2.0 metres north-east of the south-western building line of No. 23 Station Parade</p> <p>a vii Hounslow Road, Feltham, north-west side, from the junction with High Street to the south-western building line of No. 17 Station Parade</p>	<p>A</p> <p>A</p> <p>A</p> <p>A</p> <p>A</p> <p>A</p> <p>A</p>

**SCHEDULE 1 (continued)**

1 Item Number	2 Street	3 Prescribed hours - see Schedule 3
349       349 (continued)	bi Hounslow Road, Feltham, south-east side, from the junction with Staines Road to a point 8.5 metres south-west of the north-eastern building line of No. 74 Hounslow Road	A
	bii Hounslow Road, Feltham, south-east side, from a point 6 metres north-east of the common boundary of Nos. 50 & 52 Hounslow Road to the junction with High Street	A
	biii Hounslow Road, Feltham, south-east side, the north-west side of the access road fronting Nos. 114-144 Hounslow Road, from the northernmost extent of the access road to the southernmost extent of the access road	A
	biv Hounslow Road, Feltham, south-east side, the south-east side of the access road fronting Nos. 114-144 Hounslow Road, from the southernmost junction with the main carriageway of Hounslow Road to a point 3.5 metres north of the southern building line of No. 122 Hounslow Road	A
	ai Manor Lane, Feltham, north-east side, from the junction with High Street to a point 11 metres north-west of the south-eastern building line of Unit 1 Manor Park, High Street	A
	aii Manor Lane, Feltham, north-east side, from a point 11 metres north-west of the south-eastern building line of Unit 1 Manor Park, High Street to a point 1.5 metres south-east of the south-eastern building line of Feltham Evangelical Church, Manor Lane	H
	aiii Manor Lane, Feltham, north-east side, from a point 1.5 metres south-east of the south-eastern building line of Feltham Evangelical Church, Manor Lane to the north-western extent of Manor Lane	A
	bi Manor Lane, Feltham, south-west side, from the junction with High Street to a point 13 metres south-east of the south-eastern building line of Flats 1-18 Goulding House, Manor Lane	A

### SCHEDULE 1 (continued)

1 Item Number	2 Street	3 Prescribed hours - see Schedule 3
355	bii Manor Lane, Feltham, south-west side, from a point 13 metres south-east of the south-eastern building line of Flats 1-18 Goulding House, Manor Lane to a point 9 metres north-west of that building line	H
	biii Manor Lane, Feltham, south-west side, from a point 9 metres north-west of the south-eastern building line of Flats 1-18 Goulding House, Manor Lane to the north-western extent of Manor Lane, including the turning head	A
	ai Marlborough Road, Chiswick, west side, from the junction with Chiswick High Road to a point 2 metres north of the northern building line of No. 367 Chiswick High Road	A
	aii Marlborough Road, Chiswick, west side, from the southern building line of Flats 1-21 Marlborough Court, No. 1 Marlborough Road to a point 9 metres south of the northern building line of Flats 1-20 Troubridge Court, Marlborough Road	BBBBB
	aiii Marlborough Road, Chiswick, west side, from a point 9 metres south of the northern building line of Nos. 1-20 Troubridge Court, Marlborough Road southwards for a distance of 7 metres	HH
	aiv Marlborough Road, Chiswick, west side, from a point 8 metres north of the northern building line of No. 6 Marlborough Road to a point 3 metres south of that building line	HH
	av Marlborough Road, Chiswick, west side, from a point 5.5 metres south of the party wall of Nos. 12 & 14 Marlborough Road to a point 3 metres south of the party wall of Nos. 21 & 23 Marlborough Road	HH
	avi Marlborough Road, Chiswick, west side, from a point 7 metres north of the party wall of Nos. 28 & 30 Marlborough Road to a point 3 metres south of the southern building line of No. 30 Marlborough Road	HH
	avii Marlborough Road, Chiswick, west side, from a point 0.5 metres north of the southern building line of No. 32 Marlborough Road to the junction with Wellesley Road	A

**SCHEDULE 1 (continued)**

1 Item Number	2 Street	3 Prescribed hours - see Schedule 3
355 (continued)	bi Marlborough Road, Chiswick, east side, from the junction with Chiswick High Road to a point 7 metres south of the northern building line of No. 367 Chiswick High Road	A
	bii Marlborough Road, Chiswick, east side, from a point 2.5 metres north of the southern building line of Flats 1-21 Marlborough Court, No. 1 Marlborough Road to a point 2 metres south of the northern building line of Flats 1-20 Troubridge Court, Marlborough Road	A
	biii Marlborough Road, Chiswick, east side, from a point 2.5 metres north of the southern building line of No. 11 Marlborough Road to a point 1 metre south of the party wall of Nos. 12 & 14 Marlborough Road	A
	biv Marlborough Road, Chiswick, east side, from a point 5.5 metres north of the common boundary of Nos. 15 & 17 Marlborough Road to a point 4.5 metres south of that common boundary	HH
	bv Marlborough Road, Chiswick, east side, from a point 4.5 metres north of the common boundary of Nos. 19 & 21 Marlborough Road to a point 4 metres south of that common boundary	HH
	bvi Marlborough Road, Chiswick, east side, from a point 0.5 metres north of the party wall of Nos. 21 & 23 Marlborough Road to a point 5 metres south of that party wall	HH
	bvii Marlborough Road, Chiswick, east side, from a point 5 metres south of the party wall of Nos. 21 & 23 Marlborough Road to a point 6.5 metres north of the party wall of Nos. 25 & 27 Marlborough Road	A
	bviii Marlborough Road, Chiswick, east side, from a point 0.5 metres north of the party wall of Nos. 25 & 27 Marlborough Road to a point 2 metres north of the party wall of Nos. 29 Marlborough Road & 1 Wellesley Road	HH
	bix Marlborough Road, Chiswick, east side, from a point 4 metres south of the party wall of No. 29 Marlborough Road & No.1 Wellesley Road to the junction with Wellesley Road	A

### SCHEDULE 1 (continued)

1 Item Number	2 Street	3 Prescribed hours - see Schedule 3
449	<p>ai Riverside Walk, Isleworth, both sides, from the junction with Worton Road northwards for a distance of 9 metres</p> <p>bi Riverside Walk, Isleworth, west side, from the junction with Sussex Avenue to a point 15 metres north of the common boundary of Nos. 51 &amp; 52 Riverside Walk</p> <p>bii Riverside Walk, Isleworth, west side, from the north side of the restricted access by Sussex Avenue to a point 8 metres north of the southern boundary of No. 48 Riverside Walk</p> <p>biii Riverside Walk, Isleworth, west side, from a point 8.5 metres north of the junction with Woodland Gardens to a point 13.5 metres south of the junction with Woodland Gardens</p> <p>biv Riverside Walk, Isleworth, west side, from the junction with Woodlands Road southwards for a distance of 20 metres</p> <p>ci Riverside Walk, Isleworth, east side, from the junction with Woodlands Road to a point 6.5 metres south of the northern building line of No. 22 Woodlands Road</p> <p>cii Riverside Walk, Isleworth, east side, from a point 7.5 metres north of the southern boundary of No. 48 Riverside Walk to a point 9 metres south of that boundary, including the turning heads on the north and south sides of the restricted access by Sussex Avenue</p>	<p>A</p> <p>A</p> <p>A</p> <p>A</p> <p>A</p> <p>A</p> <p>A</p>
615	ai Wellesley Road, Chiswick, north side, from a point 5 metres west of common boundary of Nos. 573 & 575 Chiswick High Road to the party wall of Nos. 87 & 87A Wellesley Road	A
	aii Wellesley Road, Chiswick, north side, from the party wall of Nos. 87 & 87A Wellesley Road to a point 2.5 metres west of the party wall of Nos. 83 & 85 Wellesley Road	WWWW
615 (continued)	aiii Wellesley Road, Chiswick, north side, from a point 3 metres west of the common boundary of Nos. 79 & 81 Wellesley Road to a point 3.5 metres east of the common boundary of Nos. 83 & 85 Wellesley Road	WWWW
	aiv Wellesley Road, Chiswick, north side, from a point 2.5 metres west of the common boundary of Nos. 75 & 77 Wellesley Road	WWWW



### SCHEDULE 1 (continued)

1 Item Number	2 Street	3 Prescribed hours - see Schedule 3
	to a point 3 metres east of the common boundary of Nos. 79 & 81 Wellesley Road	
av	Wellesley Road, Chiswick, north side, from a point 6 metres east of the common boundary of Nos. 75 & 77 Wellesley Road to a point 1 metre east of the common boundary of Nos. 71 & 73 Wellesley Road	WWWW
avi	Wellesley Road, Chiswick, north side, from a point 1 metre east of the common boundary of Nos. 71 & 73 Wellesley Road to a point 4 metres east of the common boundary of Nos. 69 & 71 Wellesley Road	A
avii	Wellesley Road, Chiswick, north side, from a point 5 metres east of the common boundary of Nos. 61 & 63 Wellesley Road to a point 1 metres west of the party wall of Nos. 96 & 98 Wellesley Road	A
aviii	Wellesley Road, Chiswick, north side, from a point 6 metres west of the common boundary of Nos. 57 & 59 Wellesley Road to a point 1.5 metres east of that boundary	WWWW
aix	Wellesley Road, Chiswick, north side, from a point 5 metres east of the common boundary of Nos. 55 & 57 Wellesley Road to a point 3 metres east of the eastern building line Nos. 37-39 Wellesley Road	A
ax	Wellesley Road, Chiswick, north side, from a point 7 metres east of the eastern building line of Nos. 37-39 Wellesley Road eastwards for a distance of 11 metres	WWWW
axi	Wellesley Road, Chiswick, north side, from a point 4.5 metres west of the east parapet wall of the M4 flyover eastwards for a distance of 10.5 metres	WWWW
axii	Wellesley Road, Chiswick, north side, from the eastern building line of Nos. 1-3 Oxbridge Court, Oxford Road North to a point 9 metres west of the party wall of Nos. 54 & 56 Wellesley Road	A
axiii	Wellesley Road, Chiswick, north side, a point 9 metres west of the party wall of Nos. 54 & 56 Wellesley Road to a point 1.5 metres west of the party wall of Nos. 44 & 46 Wellesley Road	HH
axiv	Wellesley Road, Chiswick, north side, from the western building line of No. 38 Wellesley Road to a point 10.5 metres west of the common boundary of Nos. 29 & 31 Wellesley Road	HH
axv	Wellesley Road, Chiswick, north side, from a point 1.5 metres west of the common boundary of Nos. 29 & 31 Wellesley Road to a point 12 metres west of the common boundary of Nos. 27 & 29 Wellesley Road	HH

### SCHEDULE 1 (continued)

1 Item Number	2 Street	3 Prescribed hours - see Schedule 3
615 (continued)	axvi Wellesley Road, Chiswick, north side, from a point 6 metres west of the common boundary of Nos. 27 & 29 Wellesley Road to a point 2 metres east of that boundary	HH
	axvii Wellesley Road, Chiswick, north side, from a point 5 metres west of the common boundary of Nos. 23 & 25 Wellesley Road to a point 11.5 metres west of the common boundary of Nos. 26 & 26a Wellesley Road	HH
	axviii Wellesley Road, Chiswick, north side, from a point 8 metres east of the common boundary of Nos. 19 & 21 Wellesley Road to a point 6 metres west of the party wall of Nos. 15 & 17 Wellesley Road	A
	axix Wellesley Road, Chiswick, north side, from a point 6 metres west of the party wall of Nos. 15 & 17 Wellesley Road to a point 2 metres east of the eastern building line of No. 15 Wellesley Road	HH
	axx Wellesley Road, Chiswick, north side, from a point 1 metre west of the western building line of No. 11 Wellesley Road to a point 1.5 metres east of the common boundary of Nos. 9 & 11 Wellesley Road	HH
	axxi Wellesley Road, Chiswick, north side, from a point 6.5 metres east of the eastern wall of No. 9 Wellesley Road to a point 3 metres east of the western wall of No. 31 Burlington Road	A
	axxii Wellesley Road, Chiswick, north side, from a point 13 metres east of the western building line of No. 31 Burlington Road to a point 4 metres west of the western building line of No. 8 Wellesley Road	HH
	axxiii Wellesley Road, Chiswick, north side, from a point 1 metre east of western building line of No. 8 Wellesley Road to a point 5.5 metres west of the eastern building line of No. 7A Wellesley Road	HH
	axxiv Wellesley Road, Chiswick, north side, from a point 0.5 metres west of the eastern building line of No. 7A Wellesley Road to a point 3 metres west of the common boundary of Nos. 3 & 5 Wellesley Road	HH

### SCHEDULE 1 (continued)

1 Item Number	2 Street	3 Prescribed hours - see Schedule 3
615 (continued)	axxv Wellesley Road, Chiswick, north side, from a point 3 metres east of the common boundary of Nos. 3 & 5 Wellesley Road to a point 14.5 metres west of its junction with Marlborough Road	HH
	axxvi Wellesley Road, Chiswick, north side, from a point 5 metres west of its junction with Marlborough Road to a point 0.5 metres east of the western building line of No.1 Wellesley Road	A
	axxvii Wellesley Road, Chiswick, north side, from a point 10.5 metres east of the western building line of No. 1 Wellesley Road to a point 4 metres west of the rear common boundary of Nos. 10 & 12 Walpole Gardens	G
	axxviii Wellesley Road, Chiswick, north side, from a point 4 metres west of the rear common boundary of Nos. 10 & 12 Walpole Gardens to the junction with Sutton Lane North	A
	bi Wellesley Road, Chiswick, south side, from a point 9 metres west of the common boundary of Nos. 146 & 148 Wellesley Road to a point 6.5 metres west of the common boundary of Nos. 142 & 144 Wellesley Road	A
	bii Wellesley Road, Chiswick, south side, from a point 8 metres west of the common boundary of Nos. 132 & 134 Wellesley Road to a point 3 metres east of the common boundary of Nos. 140 & 142 Wellesley Road	WWWW
	biii Wellesley Road, Chiswick, south side, from a point 8 metres east of the common boundary of Nos. 118 & 120 Wellesley Road to a point 2 metres east of the common boundary of Nos. 132 & 134 Wellesley Road	WWWW
	biv Wellesley Road, Chiswick, south side, from the common boundary of Nos. 100 & 102 Wellesley Road to a point 1 metre west of the common boundary of Nos. 114 & 116 Wellesley Road	WWWW
	bv Wellesley Road, Chiswick, south side, from a point 4 metres west of the common boundary of Nos. 86 & 88 Wellesley Road to a point 1 metre west of the common boundary of Nos. 100 & 102 Wellesley Road	WWWW
	bvi Wellesley Road, Chiswick, south side, from a point 3 metres east of the party wall of Nos. 58 & 60 Wellesley Road to a point	A

### SCHEDULE 1 (continued)

1 Item Number	2 Street	3 Prescribed hours - see Schedule 3
	5.5 metres east of the eastern building line of Nos. 37-39 Wellesley Road	
bvii	Wellesley Road, Chiswick, south side, from a point 4.5 metres west of the common boundary of Nos. 58a & 58b Wellesley Road to a point 5 metres west of the western boundary line of No. 58b Wellesley Road	WWWW
bviii	Wellesley Road, Chiswick, south side, from a point 10.5 metres east of the eastern building line of No. 58 Wellesley Road to a point 8 metres east of the common boundary of Nos. 58a & 58b Wellesley Road	WWWW
bix	Wellesley Road, Chiswick, south side, from the eastern building line of No. 24 Oxford Road North to a point 14.5 metres west of the party wall of Nos. 54 & 56 Wellesley Road	A
bx	Wellesley Road, Chiswick, south side, from a point 5 metres west of the party wall of Nos. 54 & 56 Wellesley Road to a point 5.5 metres east of that party wall	HH
bx i	Wellesley Road, Chiswick, south side, from a point 0.5 metres west of the party wall of Nos. 42 & 44 Wellesley Road to a point 5 metres east of that party wall	HH
bxii	Wellesley Road, Chiswick, south side, from a point 6.5 metres east of the common boundary of Nos. 38 & 40 Wellesley Road eastwards for a distance of 11.5 metres	HH
bxiii	Wellesley Road, Chiswick, south side, from the junction with Harvard Road westwards for a distance of 7 metres	A
bxiv	Wellesley Road, Chiswick, south side, from the junction with Harvard Road to a point 6.5 metres east of the common boundary of Nos. 34 & 36 Wellesley Road	HH
bxv	Wellesley Road, Chiswick, south side, from a point 8 metres east of the eastern building line of Nos. 1-12 Heston House, Wellesley Road to a point 1 metre east of the common boundary of Nos. 28 & 28a Wellesley Road	HH
bxvi	Wellesley Road, Chiswick, south side, from a point 8.5 metres east of the common boundary of Nos. 28 & 28a Wellesley Road to a point 2.5 metres east of the western building line of No. 26C Wellesley Road	HH
bxvii	Wellesley Road, Chiswick, south side, from a point 2 metres west of the common boundary of Nos. 26 & 26a Wellesley Road eastwards for a distance of 7.5 metres	HH
bxviii	Wellesley Road, Chiswick, south side, from a point 10.5 metres east of the common boundary of Nos. 26 & 26A Wellesley	HH

### SCHEDULE 1 (continued)

1 Item Number	2 Street	3 Prescribed hours - see Schedule 3
615 (continued)	Road to a point 1 metre east of the common boundary of Nos. 20 & 22 Wellesley Road	
	bxi Wellesley Road, Chiswick, south side, from a point 11 metres east of the common boundary of Nos. 20 & 22 Wellesley Road to a point 10 metres east of the common boundary of Nos. 9 Wellesley Road & 32 Burlington Road	HH
	bxx Wellesley Road, Chiswick, south side, from a point 10 metres east of the common boundary of Nos. 9 Wellesley Road & 32 Burlington Road to a point 10 metres west of the common boundary of Nos. 10 & 12 Wellesley Road	A
	bxxi Wellesley Road, Chiswick, south side, from a point 10 metres west of the common boundary of Nos. 10 & 12 Wellesley Road to the party wall of Nos. 3/5 Wellesley Road	HH
	bxxii Wellesley Road, Chiswick, south side, from the party wall of Nos. 3 & 5 Wellesley Road to a point 7 metres west of the eastern building line of Beverley Court, Wellesley Road	G
	bxxiii Wellesley Road, Chiswick, south side, from a point 45 metres east of the western building line of Nos. 1-42 Belgrave Court, Wellesley Road to the junction with Sutton Lane North	A
630	ai Woodlands Road, Isleworth, north-west side, from the junction with St John's Road to the southern building line No. 41 Woodlands Road	A
	aii Woodlands Road, Isleworth, north-west side, from a point 2 metres west of the common boundary of Nos. 56 & 58 Woodlands Road to a point 3 metres east of the common boundary of Nos. 60 & 62 Woodlands Road	A
	aiii Woodlands Road, Isleworth, north-west side, from the common boundary of Nos. 140 & 142 Woodlands Road to the western extremity of Woodlands Road	A
	bi Woodlands Road, Isleworth, south-east side, from the junction with St John's Road to a point 1 metre south-west of the south-western building line of No. 1 Woodlands Road	A
	bii Woodlands Road, Isleworth, south-east side, from a point 5 metres north-east of the common boundary of Nos. 3 & 5 Woodlands Road to a point 8 metres south-westwards of that boundary	A

### SCHEDULE 1 (continued)

1 Item Number	2 Street	3 Prescribed hours - see Schedule 3
630 (continued)	biii Woodlands Road, Isleworth, south-east side, from a point 3 metres south-west of the common boundary of Nos. 13 & 15 Woodlands Road to its junction with Riverside Drive, excluding the lay-by fronting Nos. 18-22 Woodlands Road	A
	biv Woodlands Road, Isleworth, south-east side, from a point 4 metres north-east of the south-western building line of No. 58 Woodlands Road to a point 4 metres south-west of the north-eastern building line of No. 60 Woodlands Road	A
	bv Woodlands Road, Isleworth, south-east side, from a point 5 metres south-west of the south-westernmost junction with Woodlands Gardens to a point 5 metres north-east of the south-westernmost junction with Woodland Gardens	A
	bvi Woodlands Road, Isleworth, south-east side, from the south-western extremity of Woodlands Road north-eastwards for a distance of 10 metres, including the turning head	A
	ci Woodlands Road, Isleworth, north & north-west side, from a point 10.5 metres south of southern building line of No. 41 Woodlands Road to the common boundary of Nos. 41 & 43 Woodlands Road	A
	di Woodlands Road, Isleworth, north-west & north-east side, from a point 2 metres south-west of the north-eastern boundary of No. 136 Woodlands Road to a point 1 metre south-east of the north-western boundary of No. 134 Woodlands Road	A
	ei Woodlands Road, Isleworth, south-west side, from its junction with Riverside Walk to a point 9.3 metres east of the common boundary of Nos. 22 & 24 Woodlands Road	A
723	ai Myrtle Avenue, Feltham, north-east side, from the junction Hatton Road to the south-eastern building line of No. 2 Myrtle Avenue	A
	aii Myrtle Avenue, Feltham, north-east side, from the common boundary wall of Nos. 30 & 32 Myrtle Avenue to the north-western extremity of Myrtle Avenue, including the turning head	A

### SCHEDULE 1 (continued)

1 Item Number	2 Street	3 Prescribed hours - see Schedule 3
735	bi Myrtle Avenue, Feltham, south-west side, from the junction with Hatton Road to a point 1 metre south-east of the south-eastern building line of No. 359 Hatton Road	A
	bii Myrtle Avenue, Feltham, south-west side, from a point 2 metres north-west of the common boundary of Nos. 30 & 32 Myrtle Avenue to the north-western extremity of Myrtle Avenue	A
	ai Chester Road, Hounslow, both sides, from the junction with Arundel Road to a point 2.5 metres north-west of the south-eastern building line of No. 39 Arundel Road	A
	aii Chester Road, Hounslow, both sides, from a point 14.5 metres north-west of the northern building line of No. 12 Chester Road to a point 14.5 metres south-east of the southern building line of No. 49 Chester Road	A
	bi Chester Road, Hounslow, east side, from a point 3 metres south of the southern building line of No. 2 Warwick Road to a point 5.5 metres south of the southern building line of No. 6 Chester Road	A
	ci Chester Road, Hounslow, west side, from a point 2 metres north of the northern building line of No. 2 Warwick Road to a point 2 metres north of the southern building line of No. 61 Chester Road	A
	cii Chester Road, Hounslow, west side, from the party wall of Nos. 77 & 79 Chester Road to a point 7.5 metres south-west of the south-western building line of No. 360 Beavers Lane	A
780	ai Laburnum Grove, Hounslow, east side, from the junction with Staines Road to a point 7 metres north of the southern boundary of No. 236 Staines Road	A
	bi Laburnum Grove, Hounslow, west side, from the junction with Staines Road to a point 6 metres south of the northern boundary of No. 238 Staines Road	A

### SCHEDULE 1 (continued)

1 Item Number	2 Street	3 Prescribed hours - see Schedule 3
790	ai Swan Close, Feltham, both sides, from the junction with Swan Road to a point 1 metre north-west of the north-western building line of Flats 1-8 Swan Court, Nos. 59-61 Swan Road  bi Swan Close, Feltham, north-east side, from a point 1 metre south-east of the south-eastern building line of Flats 1-8 Swan Court, Nos. 59-61 Swan Road south-eastwards for a distance of 19 metres	A  A
852  852 (Continued)	ai Inverness Road, Hounslow, east side, from the junction with Staines Road to the southern boundary of No. 34 Inverness Road  bi Inverness Road, Hounslow, west side, from the junction with Staines Road to a point 12 metres south of the northern boundary of No. 218 Staines Road  bii Inverness Road, Hounslow, south-west side, from a point opposite the boundary wall of Nos. 24/26 Inverness Road to a point opposite the boundary wall of Nos. 26/28 Inverness Road	A  A  A
952	ai Westbury Place, Brentford, both sides, from a point 1 metres south of the southern building line of No. 1 Westbury Place southwards for a distance of 5 metres  bi Westbury Place, Brentford, north-east side, from the junction with Hamilton Road to a point 5.5 metres north of the southern boundary of No. 44 Hamilton Road  bii Westbury Place, Brentford, north-east side, from a point 1 metres north of the party wall of Nos. 11 & 13 Westbury Place to the northern extremity of Westbury Place  ci Westbury Place, Brentford, south-west side, from the junction with Hamilton Road to a point 5 metres north of the southern boundary of No. 44 Hamilton Road  cii Westbury Place, Brentford, south-west side, from a point 2 metres north of the party wall of Nos. 12 & 14 Westbury Place to the northern extremity of Westbury Place, including the turning head	GGGG  A  GGGG  A  GGGG



### SCHEDULE 1 (continued)

1 Item Number	2 Street	3 Prescribed hours - see Schedule 3
994	<p>ai Meadowbank Gardens, Hounslow, both side, the island fronting Nos. 32-76 Meadowbank Gardens, for the entire length around the island</p> <p>bi Meadowbank Gardens, Hounslow, north side, from the junction with Clevedon Gardens to a point 5.5 metres east of the eastern building line of No. 1 Meadowbank Gardens</p> <p>ci Meadowbank Gardens, Hounslow, south side, from the junction with Clevedon Gardens to the eastern building line of No. 1 Meadowbank Gardens</p> <p>di Meadowbank Gardens, Hounslow, north &amp; north-east side, from a point in line with the eastern building boundary of No. 25 Meadowbank Gardens to a point in line with the common boundary of Nos. 25 &amp; 27 Meadowbank Gardens</p> <p>ei Meadowbank Gardens, Hounslow, east &amp; south-east side, from a point 4.5 metres west of the party wavickerll of Nos. 18 &amp; 20 Meadowbank Gardens to the common boundary of Nos. 20 &amp; 22 Meadowbank Gardens</p> <p>fi Meadowbank Gardens, Hounslow, west side, from a point 1.5 metres north of the northern building line of No. 112 Meadowbank Gardens to the northern building line of No. 100 Meadowbank Gardens</p>	<p>A</p> <p>A</p> <p>A</p> <p>A</p> <p>A</p> <p>A</p>
1044	<p>ai Morris Road, Isleworth, south-west side, from the junction with Unwin Road to a point 4.5 metres south-east of the common boundary of Nos. 1 &amp; 3 Morris Road</p> <p>bi Morris Road, Isleworth, north-west side, from a point 4.5 metres north-east of the common boundary of Nos. 41 &amp; 43 Morris Road to a point 6 metres south-west of the common boundary of Nos. 52 &amp; 54 Morris Road</p> <p>bii Morris Road, Isleworth, north-west side, from a point 3.5 metres north-east of the common boundary of Nos. 105 &amp; 107 Morris Road to a point 9.5 metres south-west of the common boundary of Nos. 1 Wheatley Road &amp; 17 Unwin Road</p> <p>ci Morris Road, Isleworth, south-east side, from the common boundary of Nos. 41 &amp; 43 Morris Road to a point 1 metre south-west of the south-western building line of No. 45 Morris Road</p>	<p>A</p> <p>A</p> <p>A</p> <p>A</p>

### SCHEDULE 1 (continued)

1 Item Number	2 Street	3 Prescribed hours - see Schedule 3
1045	cii Morris Road, Isleworth, south-east side, from a point 1 metre south of the common boundary of Nos. 103 & 105 Unwin Road to the junction with Wheatley Road	A
	di Morris Road, Isleworth, north-east side, from a point 2.5 metres south-east of the common boundary of Nos. 76 & 78 Morris Road to a point 2.5 metres north of the common boundary of Nos. 80 & 82 Morris Road	A
	ai Wheatley Road, Isleworth, north-east side, from the junction with Octavia Road to a point 1 metre south-east of the common boundary of Nos. 1 Octavia Road & 59 Wheatley Road	A
	bi Wheatley Road, Isleworth, south-west side, from a point 2 metres north of the common boundary of Nos. 53 & 55 Wheatley Road to a point 1.5 metres north of the party wall of Nos. 49 & 51 Wheatley Road	A
	ci Wheatley Road, Isleworth, north-west side, from a point 2 metres north-east of the south-western building line of No. 12 Wheatley Road to a point 4 metres south-west of the south-western building line of No. 21 Wheatley Road	A
	cii Wheatley Road, Isleworth, north-west side, from the junction Morris Road to a point 2.5 metres east of the party wall of Nos. 1 & 3 Wheatley Road	A
	di Wheatley Road, Isleworth, south-east side, from the common boundary of Nos. 21 & 23 Wheatley Road to a point 5 metres south-west of the south-western building line of No. 21 Wheatley Road	A
	dii Wheatley Road, Isleworth, south-east side, from the common boundary of Nos. 1 Wheatley Road & 17 Unwin Road to the common boundary of Nos. 1 & 3 Wheatley Road	A
1129	ai Vickers Way, Hounslow, north-east side, from the junction with Frampton Road to the south-eastern building line of No. 6 Raglan Close	A
	aii Vickers Way, Hounslow, north-east side, from a point 4.5 metres north-west of the north-western building line of Nos. 7-12 Sheridan Court to a point 1.5 metres south-east of the south-eastern building line of Nos. 13-18 Sheridan Court	A
	aiii Vickers Way, Hounslow, north-east side, from a point 2 metres north-west of the common boundary of Nos. 43-51 Berry Court & Nos. 18-29 Alliance Close south-eastwards for a distance of 9 metres	A

### SCHEDULE 1 (continued)

1 Item Number	2 Street	3 Prescribed hours - see Schedule 3
1044	aiv Vickers Way, Hounslow, north-east side, from a point 5.5 metres north-west of the south-eastern building line of Nos. 1-17 Alliance Close to the junction with Blackburn Way	A
	bi Vickers Way, Hounslow, south-west side, from the junction with Frampton Road to the junction with Blackburn Way	A
	ai Morris Road, Isleworth, south-west side, from the junction with Unwin Road to a point 4.5 metres south-east of the common boundary of Nos. 1 & 3 Morris Road	A
	bi Morris Road, Isleworth, north-west side, from a point 4.5 metres north-east of the common boundary of Nos. 41 & 43 Morris Road to a point 6 metres south-west of the common boundary of Nos. 52 & 54 Morris Road	A
	bii Morris Road, Isleworth, north-west side, from a point 3.5 metres north-east of the common boundary of Nos. 105 & 107 Morris Road to a point 9.5 metres south-west of the common boundary of Nos. 1 Wheatley Road & 17 Unwin Road	A
	ci Morris Road, Isleworth, south-east side, from the common boundary of Nos. 41 & 43 Morris Road to a point 1 metre south-west of the south-western building line of No. 45 Morris Road	A
	cii Morris Road, Isleworth, south-east side, from a point 1 metre south of the common boundary of Nos. 103 & 105 Unwin Road to the junction with Wheatley Road	A
1045	ai Wheatley Road, Isleworth, north-east side, from the junction with Octavia Road to a point 1 metre south-east of the common boundary of Nos. 1 Octavia Road & 59 Wheatley Road	A
	bi Wheatley Road, Isleworth, south-west side, from a point 2 metres north of the common boundary of Nos. 53 & 55 Wheatley Road to a point 1.5 metres north of the party wall of Nos. 49 & 51 Wheatley Road	A
	ci Wheatley Road, Isleworth, north-west side, from a point 2 metres north-east of the south-western building line of No. 12 Wheatley Road to a point 4 metres south-west of the south-western building line of No. 21 Wheatley Road	A
	cii Wheatley Road, Isleworth, north-west side, from the junction Morris Road to a point 2.5 metres east of the party wall of Nos. 1 & 3 Wheatley Road	A

### SCHEDULE 1 (continued)

1 Item Number	2 Street	3 Prescribed hours - see Schedule 3
	di Wheatley Road, Isleworth, south-east side, from the common boundary of Nos. 21 & 23 Wheatley Road to a point 5 metres south-west of the south-western building line of No. 21 Wheatley Road	A
	dii Wheatley Road, Isleworth, south-east side, from the common boundary of Nos. 1 Wheatley Road & 17 Unwin Road to the common boundary of Nos. 1 & 3 Wheatley Road	A
1335	ai Arundel Road, Hounslow, both sides, from the junction with Beavers Lane to a point 6.5 metres west of the eastern boundary of Beavers Primary School, Arundel Road	
1335 (Continued)	bi Arundel Road, Hounslow, north-west side, from a point 5.5 metres north-east of the common boundary of Nos. 8 & 10 Arundel Road to a point 4 metres west of the western boundary of No. 10 Arundel Road	A
	ci Arundel Road, Hounslow, south side, from a point 2.5 metres east of the party wall of Nos. 41 & 43 Arundel Road to a point 3 metres west of the western boundary of No. 10 Arundel Road	A
1339	ai Blackburn Way, Hounslow, north-west side, from a point 9.5 metres west of the eastern building line of Nos. 26-41 Bennett Close to a point 3.5 metres east of the western building line of Nos. 30-39 Alliance Close	A
	bi Blackburn Way, Hounslow, north-west & south-west side, from a point 5 metres east of the western building line of Nos. 26-41 Bennett Close to the common boundary of Nos. 78 & 79 Blackburn Way, including so much as is public highway leading to Nos. 79-90 Blackburn Way	A
	ci Blackburn Way, Hounslow, south-east side, from the western building line of No. 6 Vimy Close to a point 4 metres west of the eastern building line of No. 53 Vimy Close	A
	cii Blackburn Way, Hounslow, south-east side, from a point 1 metre west of the western building line of Nos. 18-33 Blackburn Way	A

### SCHEDULE 1 (continued)

1 Item Number	2 Street	3 Prescribed hours - see Schedule 3
1407	to a point 1 metre east of the eastern building line of Nos. 34-45 Blackburn Way	
	di Blackburn Way, Hounslow, south-east & north-east side, from a point 4.5 metres east of the western building line of Nos. 34-45 Blackburn Way to a point 3.5 metres south-east of the common boundary of Nos. 74 & 75 Blackburn Way	A
	ai Argyle Avenue, Hounslow, both sides, from the junction with Whitton Road westwards for a distance of 6 metres	A
	bi Argyle Avenue, Hounslow, south-east side, from a point 3 metres south-west of the common boundary of Nos. 48 & 50 Argyle Avenue to a point 4.5 metres north-east of the common boundary of Nos. 52 & 54 Argyle Avenue	A
	bii Argyle Avenue, Hounslow, south-east side, from a point 5.5 metres south-west of the common boundary of Nos. 64 & 66 Argyle Avenue to a point 6.5 metres north-east of the common boundary of Nos. 68 & 70 Argyle Avenue	A
	biii Argyle Avenue, Hounslow, south-east side, from a point 2 metres north-east of the common boundary of Nos. 103 & 105 Argyle Avenue to the common boundary of Nos. 107 & 109 Argyle Avenue	A
	biv Argyle Avenue, Hounslow, south-east side, from the southernmost junction with Park Avenue to the party wall of Nos. 111 & 113 Argyle Avenue	A
1499	bv Argyle Avenue, Hounslow, north-west side, from a point 6 metres north-east of the south-western boundary of No. 21 Argyle Road to a point 6 metres south-west of the north-eastern boundary of No. 23 Argyle Road	A
	i Great South-West Road, Hounslow, both sides, the service road fronting Nos. 116-138 Great South-West Road, from the south-western boundary line of No. 215 Beavers Lane south-	A

### SCHEDULE 1 (continued)

1 Item Number	2 Street	3 Prescribed hours - see Schedule 3
1499 (Continued)	<p>westwards to the access to the Church of Good Shepherd car park</p> <p>bi Great South-west Road, Hounslow, north-west side, the service road fronting Nos. 67-137 Great South-West Road, from a point 22 metres south-west of the common boundary of Nos. 93 &amp; 95 Great South-West Road to a point 21 metres north-east of the common boundary of Nos. 101 &amp; 103 Great South-West Road</p>	A

### SCHEDULE 2 STREETS REFERRED TO IN ARTICLE 5(2)(a)

1 Item Number	2 Street	3 Prescribed hours - see Schedule 3
50	<p>ai Hounslow Road, Feltham, south-east side, from the junction with Staines Road to the party wall of Nos. 208 &amp; 210 Hounslow Road</p> <p>aii Hounslow Road, Feltham, south-east side, from a point 6 metres north-east of the common boundary of Nos. 50 &amp; 52 Hounslow Road to the south-western building line of No. 6 Hounslow Road</p> <p>aiii Hounslow Road, Feltham, south-east side, from a point 12 metres south-west of the south-western building line of No. 6 Hounslow Road to the junction with High Street</p> <p>bi Hounslow Road, Feltham, north-west side, from the junction with Staines Road to a point 1 metre north of the party wall of Nos. 194 &amp; 196 Hounslow Road</p> <p>bii Hounslow Road, Feltham, north-west side, from a point 6 metres north-east of the common boundary of Nos. 50 &amp; 52 Hounslow Road to a point 0.5 metres north-east of the party wall of Nos. 27 &amp; 29 Station Parade</p>	<p>1</p> <p>7</p> <p>1</p> <p>1</p> <p>1</p>

232	biii	Hounslow Road, Feltham, north-west side, from a point 2 metres north-east of the south-western building line of No. 23 Station Parade to a point 12 metres north-east of the south-western building line of No. 17 Station Road	1
	biv	Hounslow Road, Feltham, north-west side, from the south-western building line of No. 17 Station Parade to the junction with High Street	1
	ai	Marlborough Road, Chiswick, west side, from the southern building line of Flats 1-21 Marlborough Court, No. 1 Marlborough Road to a point 9 metres south of the northern building line of Flats 1-20 Troubridge Court, Marlborough Road	105

**SCHEDULE 3**  
**PRESCRIBED/RESTRICTED HOURS**

1 Prescribed hours – see Schedule 1 or 4	2 Times	3 Prescribed hours – see Schedule 2
	Between	N/A
	Between 6.30pm-8am	55
A	At any time	X15
AA	Between Mon-Fri 8am-9.30am and 2.30pm-4pm	27
AAA	Between Mon-Fri 8.30am-9am and 3pm-3.30pm	
AAAA	Between Sat-Sun 8am-8pm	76
AAAAA	Between 6pm-8am	
B	Between 7am-11.30pm	2
BB	Between Mon-Sat 8am-12pm and 2pm-6pm	28
BBB	Between Mon-Fri 8.30am-9.15am and 3pm-4pm	
BBBB	Between Mon-Sat 9am-6pm	N/A1
BBBBB	Between Wednesday 8am-12pm	105
C	Between 10am-11pm	3
CC	Between Mon-Fri 9.30am-6pm and Sat 9.30am-12.30pm	29
CCC	Between Mon-Sat 9.30am-5pm	
CCCC	Between 9.30am-6pm	78
CCCCC	Between Mon-Fri 9am-11am and 5pm-7pm	
D	Between 8am-6.30pm	4

DD	Between 7am-7pm	30
DDD	Between Mon-Fri 9.30am-6.30pm	54
DDDD	Between Tuesday 9am-11am	
E	Between Mon-Sat 7am-7pm	5
EE	Between Mon-Fri 7am-6.30pm	31
EEE	Between Mon-Sat 8am-6pm	
EEEE	Between Mon-Sat 9.30am-6.30pm	80
EXP1	Between the first Sunday of the month 5am-4.30pm	
EXP2	Between 5am-6pm	
F	Between Mon-Sat 7am-6.30pm	6
FF	Between Mon-Fri 9.30am-5.30pm and Sat 9.30am-12.30pm	32
FFF	Between Mon-Fri 8.15am-4.30pm	
FFFF	Between Mon-Fri 9am-9pm and Sat-Sun 5pm-9pm	
G	Between Mon-Sat 8am-6.30pm	7
GG	Between Mon-Sat 9am-7pm	33
GGG	Between Mon-Fri 7am-6pm	57
GGGG	Between Mon-Fri 10am-12pm and 6pm-8pm and Saturdays on Brentford FC event days 2.30pm-3.30pm	82
H	Between Mon-Sat 8.30am-6.30pm	8
HH	Between Mon-Fri 9am-6pm	34
HHH	Between Mon-Fri 7am-10am	58
I	Between Mon-Fri 8am-6.30pm and Sat 8am-1.30pm	9
J	Between Mon-Fri 8.30am-6.30pm and Sat 8.30am-1.30pm	10
JJ	Between Mon-Sat 7am-8pm	35
JJJ	Between Mon-Fri excl Bank Hols 8am-5pm	59
JJJJ	Between Mon-Fri 10am-12pm and 5pm-7pm	85
K	Between Mon-Fri 8am-6.30pm	11
KK	Between Mon-Fri 9.30am-12.30pm and 4.30pm-6.30pm and Sat 9.30am-12.30pm	36
KKK	Between Mon-Fri 8.30am-9.15am and 3pm-5.30pm	60
KKKK	Between Mon-Fri 9.30am-5pm	86
L	Between Mon-Fri 8.30am-6.30pm	12
LL	Between Mon-Fri 8am-6pm	37
LLL	Between Mon-Fri 9am-5.30pm	61
LLLL	Between 7am-11pm	87
M	Between Mon-Sat 7am-9.30am and 4.30pm-7pm	13
MM	Between Mon-Fri 7am-10am and 4pm-7pm and Sat 10am-4pm	38
MMM	Between Mon-Sat 9am-8pm	62
MMMM	Between Mon-Fri 10am-7pm	88
N	Between Mon-Fri 7am-10am and 4.30pm-6.30pm	14
NN	Between Mon-Fri 9am-5pm	39



NNN	Between Mon-Fri 8.15am-4.30pm and the first Sunday of the month 5.30am-1pm	63
NNNN	Between Mon-Fri 9am-11am	89
O	Between Mon-Fri 7am-9.30am and 4.30pm-6.30pm	15
OO	Between 5.30am-1pm	40
OOO	Between Mon-Fri 10am-11am and 3pm-4pm	64
OOOO	Between Mon-Sat 10am-7pm	90
P	Between Mon-Sat 8am-9.30am and 4.30pm-6.30pm	16
PP	Between Mon-Fri 9.30am-5.30pm	41
PPP	Between Mon-Sat 2pm-3pm	65
PPPP	Between Mon-Sat 1pm-3pm	91
Q	Between Mon-Fri 8am-9.30am and 4.30pm-6.30pm	17
QQ	Between Mon-Fri 7am-7pm	42
QQQ	Between 9am-7pm	66
QQQQ	Between Mon-Fri 8am-5pm	
R	Between Mon-Fri 8am-9.30am and 5pm-6.30pm	18
RR	Between 7am-10am and 4pm-7pm	43
RRR	Between on Community Stadium event days 9am-midnight	68
RRRR	Between Fri 7am-12pm	93
S	Between 8am-midnight	19
SS	Between Mon-Fri 7am-10am and 4pm-7pm	44
SSS	Between Mon-Fri 7am-9am and 3pm-5.30pm and on Community Stadium event days 9am-midnight	67
SSSS	Between Wednesday 9am-11am	94
T	Between Mon-Sat 8am-midnight	20
TT	Between Fri 10am-4pm	45
TTT	Between Mon-Fri 7am-11pm and Sat 9.30am-12.30pm	69
TTTT	Between Mon-Fri 10am-12pm and the first Sunday of the month 5.30am-1pm	95
U	Between Mon-Sat 8am-8pm	21
UU	Between Mon-Fri 9.30am-11.30am and 3.30pm-5.30pm	46
UUU	Between Mon-Fri 7am-11pm	70
UUUU	Between Mon-Fri 7am-9am and 3pm-5.30pm	96
V	Between Mon-Sat 8am-9pm	22
VV	Between 7am-9.30am and 4.30pm-7.30pm	47
VVV	Between Mon-Fri 10am-11am and 7pm-8pm and Saturdays on Brentford FC event days 2.30pm-3.30pm	71
VVVV	Between Mon-Sat 8am-10am and 4pm-6pm	97
W	Between 8am-10pm	23
WW	Between 9am-5pm	48
WWW	Between on a Brentford FC event day 10am-10pm	72

### SCHEDULE 3 (continued)

1 Prescribed hours – see Schedule 1 or 4	2 Times	3 Prescribed hours – see Schedule 2
LL	Between Mon-Fri 8am-6pm	37
LLL	Between Mon-Fri 9am-5.30pm	61
LLLL	Between 7am-11pm	87
M	Between Mon-Sat 7am-9.30am and 4.30pm-7pm	13
MM	Between Mon-Fri 7am-10am and 4pm-7pm and Sat 10am-4pm	38
MMM	Between Mon-Sat 9am-8pm	62
MMMM	Between Mon-Fri 10am-7pm	88
N	Between Mon-Fri 7am-10am and 4.30pm-6.30pm	14
NN	Between Mon-Fri 9am-5pm	39
NNN	Between Mon-Fri 8.15am-4.30pm and the first Sunday of the month 5.30am-1pm	63
NNNN	Between Mon-Fri 9am-11am	89
O	Between Mon-Fri 7am-9.30am and 4.30pm-6.30pm	15
OO	Between 5.30am-1pm	40
OOO	Between Mon-Fri 10am-11am and 3pm-4pm	64
OOOO	Between Mon-Sat 10am-7pm	90
P	Between Mon-Sat 8am-9.30am and 4.30pm-6.30pm	16
PP	Between Mon-Fri 9.30am-5.30pm	41
PPP	Between Mon-Sat 2pm-3pm	65
PPPP	Between Mon-Sat 1pm-3pm	91
Q	Between Mon-Fri 8am-9.30am and 4.30pm-6.30pm	17
QQ	Between Mon-Fri 7am-7pm	42
QQQ	Between 9am-7pm	66

QQQQ	Between Mon-Fri 8am-5pm	
R	Between Mon-Fri 8am-9.30am and 5pm-6.30pm	18
RR	Between 7am-10am and 4pm-7pm	43
RRR	Between on Community Stadium event days 9am-midnight	68
RRRR	Between Fri 7am-12pm	93
S	Between 8am-midnight	19
SS	Between Mon-Fri 7am-10am and 4pm-7pm	44
SSS	Between Mon-Fri 7am-9am and 3pm-5.30pm and on Community Stadium event days 9am-midnight	67
SSSS	Between Wednesday 9am-11am	94
T	Between Mon-Sat 8am-midnight	20
TT	Between Fri 10am-4pm	45
TTT	Between Mon-Fri 7am-11pm and Sat 9.30am-12.30pm	69
TTTT	Between Mon-Fri 10am-12pm and the first Sunday of the month 5.30am-1pm	95
U	Between Mon-Sat 8am-8pm	21
UU	Between Mon-Fri 9.30am-11.30am and 3.30pm-5.30pm	46
UUU	Between Mon-Fri 7am-11pm	70
UUUU	Between Mon-Fri 7am-9am and 3pm-5.30pm	96
V	Between Mon-Sat 8am-9pm	22
VV	Between 7am-9.30am and 4.30pm-7.30pm	47
VVV	Between Mon-Fri 10am-11am and 7pm-8pm and Saturdays on Brentford FC event days 2.30pm-3.30pm	71
VVVV	Between Mon-Sat 8am-10am and 4pm-6pm	97
W	Between 8am-10pm	23
WW	Between 9am-5pm	48
WWW	Between on a Brentford FC event day 10am-10pm	72

**SCHEDULE 3 (continued)**

1 Prescribed hours – see Schedule 1 or 4	2 Times	3 Prescribed hours – see Schedule 2
WWWW	Between Mon-Fri 10am-12pm and 6pm-8pm and Sat-Sun 2pm-4pm	99
X	Between 7am-midnight	24
X2	Between 5.30pm-1am	X3
XX	Between Mon-Fri 7am-10am and 4pm-7pm and Sat-Sun 10am-4pm	49
XXX	Between Mon-Fri 10am-12pm and 6pm-8pm	
XXXX	Between 9am-11am and 5pm-7pm	100
Y	Between Mon-Fri 1pm-2pm	25
YY	Between Mon-Fri 10am-12pm	50
YYY	Between 9am-8pm	74

YYYY	Between Mon-Fri 9am-11am and 5pm-7pm and Sat-Sun 2pm-4pm	
Z	Between Mon-Sat 7am-10am and 4pm-7pm	26
ZZ	Between 10am-3pm	73
ZZZ	Between Mon-Sat 9am-9pm and Sun 5pm-9pm	77

# Traffic Management Order

2015 No.6

---

The London Borough of Hounslow (Brook Road South & Brentford Stadium Event Day)  
(Parking Places) Order 2015

Made on 16 March 2015

Coming into operation on 7 April 2015

---

## ARRANGEMENT OF ARTICLES

### PART I - PRELIMINARY

	Article
Citation and commencement	1
Revocations	2
Interpretation	3

### PART II - DESIGNATION OF PARKING PLACES

	Article
Designation of parking places	4
Number and situation of parking spaces	5
Manner of standing in a parking place	6
Vehicles for which parking places are designated	7
Display of permits and tickets	8
Charge for parking places	9
Payment of the charge at parking places with ticket machines	10
Exemption from charges	11
Contravention	12
Movement of a vehicle in a parking place in an emergency	13

## **PART III - SUPPLEMENTARY PROVISIONS**

<b>Section 1 – General</b>	<b>Article</b>
Period for which a vehicle may be left after the penalty charge has been incurred	14
Restriction on the removal of tickets and permits	15
Indications and evidence by the telephone payment parking system	16
No tickets to be displayed other than those obtained on payment of the parking charge	17
Interval before a vehicle may again be left in a parking place	18
Power to suspend the use of a parking place	19
Restriction on the use of a parking place	20
Restriction on waiting by a vehicle in a parking place	21
Manner of waiting in a parking place	22
Installation of ticket parking meters, placing of traffic signs, etc	23
<b>Section 2 - Permits</b>	
Application for and issue of residents' permits for the use of parking places	24
Refund of charge paid in respect of residents' permit	25
Application for and issue of business permits for the use of parking places	26
Refund of charge in respect of business permits	27
Surrender, withdrawal and validity of permits	28
Application for and issue of duplicate permits	29
Form of permits	30
<b>Section 3 - Residents' Visitor Parking Cards</b>	
Application for and issue of residents' visitor parking cards for the use of parking places	31
Refund of charge paid in respect of a residents' visitor parking card	32
Surrender, withdrawal and validity of residents' visitor parking card	33
Application for the issue of replacement residents' visitor parking cards	34
Form of residents' visitor parking cards	35

## **SCHEDULES**

Schedule 1 - Pay by phone parking places

Schedule 2 - Pay by phone and Business Permit parking places

Schedule 3 - Pay by phone, Resident Permit and Residents' Visitor Parking Card parking places

Schedule 4 - Pay by phone, Business Permit, Resident Permit and Residents' Visitor Parking Card parking places parking places

Schedule 5 - Business Permit parking places

Schedule 6 - Business Permit, Resident Permit and Residents' Visitor Parking Card parking places

Schedule 7 - Resident Permit and Residents' Visitor Parking Card parking places

Schedule 8 - Resident Permit parking places

Schedule 9 - Streets or parts of streets for the purpose of the definition of business user

Schedule 10 - Streets or parts of streets for the purpose of the definition of resident

Schedule 11 - On-Street pay by phone parking charges

Schedule 12 - Business Permit charges

Schedule 13 - Resident Permit charges

Schedule 14 - Residents' Visitors Parking Card Charges

The Council of the London Borough of Hounslow, having consulted the Commissioner of Police of the Metropolis, in exercise of the powers conferred by sections 6, 45, 46, 49 and 51 and 124 of and Part III and Part IV of Schedule 9 to the Road Traffic Regulation Act 1984<sup>a</sup> as amended and the Traffic Management 2004<sup>b</sup> and of all other enabling powers hereby make the following Order:

---

<sup>a</sup> 1984 c.27

<sup>b</sup> 2004 c.18

## **PART I - PRELIMINARY**

### **1. Citation and Commencement**

- (1) This Order may be cited as The London Borough of Hounslow (Brook Road South & Brentford Stadium Event Day) (Parking Places) Order 2015 and shall come into operation for all purposes on 7 April 2015.

### **2. Revocation**

- (1) Without prejudice to the validity of anything done or to any liability incurred in respect of any act or omission before the coming into operation of this Order the following Orders are hereby revoked:
  - (a) None

### **3. Interpretation**

- (1) In this Order, except where the context otherwise requires, the following expressions have the meanings hereby respectively assigned to them:

"business permit" means a business permit issued under the provisions of Article 26;

"business user" means a person who occupies premises the postal address of which is in any street or part of street described in Schedule 9 and who uses such premises for non-residential purposes;

"civil enforcement officer" has the same meaning as in the Traffic Management Act 2004;

"Council" means the Council of the London Borough of Hounslow;

"disabled person" and "disabled person's badge" have the same meanings as in the Disabled Persons (Badges for Motor Vehicles) (England) Regulations 2000<sup>a</sup>;

"disabled person's vehicle" has the same meaning as in the Local Authorities' Traffic Orders (Exemptions for Disabled Persons) (England and Wales) Regulations 2000<sup>b</sup>;

"driver" in relation to a vehicle waiting in a parking place means the person driving the vehicle at the time it was left in the parking place;

"enactment" means any enactment, whether public, general or local, and includes any order, byelaw, rule, regulation, scheme or other instrument having effect by virtue of an enactment;

"event days" means a Saturday when events are being held at the Brentford Football Club ground Griffin Park, Braemar Road, Brentford and when the relevant signs are displayed;

---

<sup>a</sup> SI.2000/882

<sup>b</sup> SI.2000/683



"goods" means goods of any kind whether animate or inanimate and includes postal packets of any description; and "delivering" and "collecting" in relation to any goods includes checking the goods for the purpose of their delivery or collection;

"goods vehicle" has the same meaning as in The Traffic Signs Regulations and General Directions 2002<sup>a</sup>;

"hand-held device" means a wireless hand-held computer used by a civil enforcement officer, which is programmed to interface with the telephone payment parking systems;

"householder" means either one person living alone or a group of people (who may or may not be related) living or staying at the same address with common housekeeping and who is a resident for the purposes of this Order;

"location identification number" means the unique number assigned to the parking place where the telephone payment parking system is operational;

"motor cycle and invalid carriage" have the same meaning respectively as in Section 136 of the Road Traffic Regulation Act 1984;

"owner", has the same meaning as in the Civil Enforcement of Parking Contraventions (England) General Regulations 2007<sup>b</sup>;

"parking contravention" has the meaning as assigned to it in Part 1 of Schedule 7 of the Traffic Management Act 2004;

"parking place" means any area on a highway designated as such by this Order;

"parking space" means a space in a parking place referred to in Schedules 1, 2, 3, 4, 5, 6, 7 and 8 which is provided for the leaving of vehicles;

"passenger vehicle" means a motor vehicle (other than a motor cycle or invalid carriage) constructed or adapted solely for the carriage of not more than eight passengers (exclusive of the driver) and their effects and not drawing a trailer;

"penalty charge" has the same meaning as in the Civil Enforcement of Parking Contraventions (England) General Regulations 2007

"penalty charge and reduced penalty charge" means a charge set by the Council under the provisions of Part 6 of the Traffic Management 2004 and with the approval of the Secretary of State for Transport which is to be paid to the Council within 28 days beginning on the date of the Notice, or in 14 days in the case of a reduced penalty charge, following the issue of the penalty charge notice;

"penalty charge notice" has the same meaning as in the Civil Enforcement of Parking Contraventions (England) General Regulations 2007;

"permitted hours", in relation to a parking place, means the period specified at the beginning of the Schedule relating to that parking place;

---

<sup>a</sup> SI.2002/3113

<sup>b</sup> SI.2007/3483

“resident” means a person whose usual place of abode is at the premises the postal address of which is in any street or part of a street described in Schedule 10;

“residents’ permit” means a residents’ permit issued under the provisions of Article 24;

“residents’ permit holder” means a person to whom a residents’ permit has been issued under the provisions of Article 24;

“residents’ visitor parking card” means a residents’ visitor parking card issued under the provisions of Article 31;

“service provider” means the company authorised and appointed by the Council to operate, administer and maintain the payment of parking charges using the telephone payment parking system;

“service charge” means any charge which may be payable to the service provider (in addition to the parking charge in accordance with the provisions of Article 9) for vehicles using the telephone payment parking system;

“Schedule” means a Schedule to this Order;

“telecommunications system” has the same meaning as in the Telecommunications Act 1984<sup>a</sup>;

“telephone payment parking system” means a system to facilitate and monitor the payment of parking charges using telephone communication with the service provider in accordance with instructions indicated on signs located at each parking place where the system is operational;

“user”, in relation to a vehicle, means the person by whom such a vehicle is kept and used;

“valid residents’ visitor parking card” means a residents’ visitor parking card validated by entering the following indications by or on behalf of the driver:

- (a) the registration mark of the vehicle;
- (b) the month and the date in the month;
- (c) the time of arrival.

- (2) Any reference in this Order to any enactment shall be construed as a reference to that enactment as amended, applied, consolidated, re-enacted by or as having effect by virtue of any subsequent amendment.
- (3) For the purposes of this Order a vehicle shall be regarded as displaying a disabled person's badge in the relevant position when it is so regarded for the purposes of Regulation 3 of the Local Authorities' Traffic Orders (Exemptions for Disabled Persons) (England and Wales) Regulations 2000<sup>b</sup>.

---

<sup>a</sup> 1984 c.12

<sup>b</sup> SI 2000/683

## **PART II - DESIGNATION OF PARKING PLACES**

### **4. Designation of parking places**

- (1) The areas of highway as described in column 2 of Schedules 1, 2, 3, 4, 5, 6, 7 and 8 are designated as parking places.
- (2) The limits of each parking place and the limits of each parking space within a parking place shall be indicated on the highway in accordance with Section 64 of the Road Traffic Regulation Act 1984.

### **5. Number and situation of parking spaces**

- (1) The number and situation of parking spaces in each parking place shall be determined by the Council.

### **6. Manner of standing in a parking place**

- (1) Every vehicle left in a parking place shall stand so that every part of the vehicle is wholly within the limits of any parking space or parking place.
- (2) Every vehicle left in a parking place in relation to which special provisions as to the manner of standing of a vehicle in that parking place is specified in column 4 of Schedules 2, 3, 4, 5, 6, 7 and 8 shall stand so that as to be in accordance with those provisions.

### **7. Vehicles for which parking places are designated**

- (1) Each parking place referred to in Schedules 1, 2, 3, 4, 5, 6, 7 and 8 may be used subject to the provisions of this Order for the leaving during the permitted hours of such vehicles as are passenger vehicles, goods vehicles, motor cycles, or invalid carriages.
- (2) Subject to the provisions of this Order, a person leaving a vehicle in a parking place referred to in Schedule 1 during the permitted hours shall make payment through the telephone payment parking system.
- (3) Subject to the provisions of this Order, a person leaving a vehicle in a parking place referred to in Schedule 2 during the permitted hours shall either:
  - (a) the telephone payment parking system; or
  - (b) cause to be displayed a valid business permit.
- (4) Subject to the provisions of this Order, a person leaving a vehicle in a parking place referred to in Schedule 3 during the permitted hours shall either:
  - (a) make payment through the telephone payment parking system; or
  - (b) cause to be displayed a valid residents' permit; or
  - (c) cause to be displayed a valid residents' visitors parking card.
- (5) Subject to the provisions of this Order, a person leaving a vehicle in a parking place referred to in Schedule 4 during the permitted hours shall either:
  - (a) make payment through the telephone payment parking system; or
  - (b) cause to be displayed a valid business permit; or
  - (c) cause to be displayed a valid residents' permit; or
  - (d) cause to be displayed a valid residents' visitors parking card.

- (6) Subject to the provisions of this Order, a person leaving a vehicle in a parking place referred to in Schedule 5 during the permitted hours shall cause to be displayed a valid business permit.
- (7) Subject to the provisions of this Order, a person leaving a vehicle in a parking place referred to in Schedule 6 during the permitted hours shall either:
  - (a) cause to be displayed a valid business permit;
  - (b) cause to be displayed a valid residents' permit; or
  - (c) cause to be displayed a valid residents' visitors parking card
- (8) Subject to the provisions of this Order, a person leaving a vehicle in a parking place referred to in Schedule 7 during the permitted hours shall either:
  - (a) cause to be displayed a valid residents' permit; or
  - (b) cause to be displayed a valid residents' visitors parking card
- (9) Subject to the provisions of this Order, a person leaving a vehicle in a parking place referred to in Schedule 8 during the permitted hours shall cause to be displayed a valid residents' permit.

## **8. Display of permits and visitor parking cards**

- (1) At all times during which a vehicle is left in a parking place during the permitted hours and where required to do so by Article 7, the driver shall cause either a valid permit, or a valid residents' visitor parking card, issued for that vehicle, to be displayed on the front or kerb side of the vehicle so that either:
  - (a) all of the particulars of the residents' permit referred to in Article 30(1) are clearly visible from the front or kerb side of the vehicle; or
  - (b) all of the particulars of the business permit referred to in Article 30(2) are clearly visible from the front or kerb side of the vehicle; or
  - (c) all of the particulars of the residents' visitor parking card referred to in Article 35(1) are clearly visible from the front or kerb side of the vehicle and have been duly completed.

## **9. Charge for use of parking places**

- (1) A charge shall be paid for the leaving of a vehicle in a parking place described in Schedule 1 during the permitted hours, such charge being as specified in Schedule 11.
- (2) A charge shall be paid for the leaving of a vehicle in a parking place described in Schedules 2, 3 and 4 during the permitted hours, such charge being either:
  - (a) as specified in Schedule 11; or
  - (b) a business permit fee as specified in Schedule 12; or
  - (c) a residents' permit fee as specified in Schedule 13; or
  - (d) a residents' visitors parking card fee as specified in Schedule 14.
- (3) A charge shall be paid for the leaving of a vehicle in a parking place described in Schedules 5, 6 7 and 8 during the permitted hours, such charge being either:
  - (a) a business permit fee as specified in Schedule 12; or
  - (b) a residents' permit fee as specified in Schedule 13; or
  - (c) a residents' visitors parking card fee as specified in Schedule 14.

- (4) For users of the telephone payment system the parking charge will be the same as specified in Schedule 11 plus the payment of an additional twenty (20) pence convenience fee.
- (5) No period for a vehicle left in a parking place referred to in Schedule 1, 2, 3 and 4 shall exceed the allocated time as stated in the permitted hours.

#### **10. Payment of parking charge at parking places with ticket machines**

- (1) A person leaving a vehicle in a parking place referred to in Schedules 1, 2, 3 and 4, can use the telephone payment parking system to pay the parking charge, imposed by this Order, for the period they wish to park by making telephone communication with the service provider in accordance with instructions indicated on signs located at the parking place.

#### **11. Exemption from charges**

- (1) Notwithstanding the foregoing provisions of this Order any disabled person's vehicle displaying in the relevant position a disabled person's badge may be left in any part of a parking place described in Schedules 1 to 8 if the use of that part has not been suspended.
- (2) Notwithstanding the foregoing provisions of this Order any motor cycle may be left in any part of a parking place described in Schedules 5, 6 and 7.

#### **12. Contravention**

- (1) If a vehicle is left in a parking place at any time during the permitted hours without complying with the provisions of this Order, then a contravention of this Order and a parking contravention within Part 1 of Schedule 7 to the Traffic Management Act 2004, shall deemed to have occurred.
- (2) Where a vehicle is left in a parking place without complying with the provisions of this Order, the vehicle may be removed or caused to be removed from that parking place as provided for by Regulations made under section 99 of the Road Traffic Regulation Act 1984.

#### **13. Movement of a vehicle in a parking place in an emergency**

- (1) A police constable in uniform, a traffic warden or Civil Enforcement Officer may move or cause to be moved a vehicle from a parking place in an emergency.

### **PART III - SUPPLEMENTARY PROVISIONS**

#### **Section 1 - General**

#### **14. Period a vehicle may be left after the penalty charge has been incurred**

- (1) The period for which a vehicle may be left in a parking place during the permitted hours after the penalty charge has been incurred shall not exceed one hour.

#### **15. Restriction on the removal of permits**

- (1) Where a permit has been displayed on a vehicle, no person, not being the driver of the vehicle, shall remove the permit from the vehicle unless authorised to do so by the driver.

#### **16. Indications and evidence by the telephone payment parking system**

- (1) Where a vehicle has been left in a parking place referred to in Schedules 1, 2, 3 and 4 using the telephone payment parking system, an indication that payment has been made and the parking period for which payment has been made shall either:
  - a) appear on a hand-held device; or
  - b) be obtained by a civil enforcement officer contacting the service provider.
- (2) Without prejudice to the provisions of this Order, if at any time while a vehicle is left in a parking place referred to in the Schedule and no indication that payment of the parking charge has been made using the telephone payment parking system, or an indication that the parking period for which payment was made has expired, it shall be presumed, unless the contrary is proved, that either:
  - (a) the parking charge has not been duly paid in respect of that vehicle; or
  - (b) the parking period for which payment was made had already expired.

#### **17. No tickets to be displayed other than those obtained on payment of the parking charge**

- (1) No person shall display on a vehicle left in a parking place referred to in Schedule 1, 2, 3 and 4 during the permitted hours any ticket other than the ticket issued by the ticket machine relating to that parking place upon payment of the parking charge in respect of that vehicle.

#### **18. Interval before a vehicle may again be left in a parking place**

- (1) Without prejudice to the provisions of Article 20, no vehicle which has been taken away from a parking place during the permitted hours, after the charge has been incurred, shall until the expiration of one hour from the time it was taken away again be left in the parking place during the permitted hours.

#### **19. Power to suspend the use of a parking place**

- (1) A Civil Enforcement Officer duly authorised by the council or by the Commissioner of Police of the Metropolis may suspend the use of a parking place or any part thereof whenever he considers such suspension reasonably necessary:
  - (a) for the purpose of facilitating the movement of traffic or promoting its safety;
  - (b) for the purpose of any building operation, demolition or excavation adjacent to the parking place, the maintenance, improvement or reconstruction of the highway or the cleansing of gullies in or adjacent to the parking place, the laying, erection, alteration or repair in or adjacent to the parking place of any sewer or of any main, pipe or apparatus for the supply of gas, water or electricity or any telecommunication system or the placing, maintenance or removal of any traffic sign;
  - (c) for the convenience of occupiers of premises adjacent to the parking place on any occasion of the removal of furniture to or from one office or dwelling house

adjacent to the parking place from or to a depository, another office or dwelling house;

- (d) on any occasion on which it is likely by reason some special attraction that any street will be thronged or obstructed; or
  - (e) for the convenience of occupiers of premises adjacent to the parking place at times of weddings or funerals, or on other special occasions.
- (2) A police constable in uniform or traffic warden may suspend for not longer than twenty four hours the use of a parking place or any part thereof whenever they consider suspension reasonably necessary for the purposes of facilitating the movement of traffic or promoting its safety.
  - (3) A Civil Enforcement Officer, police constable or traffic warden suspending the use of a parking place or any part thereof in accordance with the provisions of paragraph (1), or as the case may be, paragraph (2) of this Article shall thereupon place or cause to be placed in or adjacent to any part of that parking place which is suspended a traffic sign of any size, colour and type prescribed or authorised under Section 64 of the Road Traffic Regulation Act 1984 indicating that waiting by vehicles is prohibited.
  - (4) No person shall cause or permit a vehicle to wait in a parking place or part thereof during such period as there is in or adjacent to that part of the parking place a traffic sign placed in pursuance of paragraph (3) of this Article. Provided that nothing in this paragraph shall apply to:
    - (a) any vehicle being used for fire brigade, ambulance or police purposes or any vehicle which is waiting for any reason specified in Article 21(1) (c) (e) or (f); or
    - (b) anything done with the permission of the person suspending the use of the parking place or part thereof in pursuance of paragraph (1) of this Article.

## **20. Restriction on use of a parking place**

- (1) During the permitted hours no person shall use any parking place or any vehicle while it is in a parking place in connection with the sale or offering for sale of any goods to any person in or near the parking place or in connection with the selling or offering for sale of his skill in handicraft or his services in any other capacity. Provided that nothing in this Article shall prevent the sale of goods from a vehicle:
  - (a) if the goods are immediately delivered at or taken into premises adjacent to the vehicle from which the sale effected; or
  - (b) if the vehicle is one to which provisions of Article 21(1)(i) apply.

## **21. Restriction on waiting by a vehicle in a parking place**

- (1) Any vehicle may wait during the permitted hours anywhere in any part of a parking place if the use of that part has not been suspended and if the vehicle is waiting:
  - (a) for so long as is necessary to enable a person to board or alight from the vehicle and to load thereon or unload therefrom their personal luggage;
  - (b) for so long as is necessary to enable goods to be loaded onto the vehicle from premises adjacent to the parking place or unloaded from the vehicle to premises adjacent to the parking place;
  - (c) for so long as is necessary for postal packets to be collected from or delivered to premises or posting boxes adjacent to the parking place in which the vehicle is waiting;

- (d) whilst being used for fire brigade, ambulance or police purposes or, not being a passenger vehicle, is being used in the service of a local authority in pursuance of statutory powers or duties provided that in all the circumstances it is reasonably necessary in the exercise of such powers or in the performance of such duties for the vehicle to wait in the place in which it is waiting;
  - (e) the vehicle is waiting only for so long as may be necessary to enable it to be used in connection with the removal of any obstruction to traffic;
  - (f) owing to the driver being prevented from proceeding by circumstances beyond his control or to such waiting being necessary in order to avoid an accident;
  - (g) the vehicle not being a passenger vehicle is waiting only for so long as may be reasonably necessary to enable it to be used for any purpose specified in Article 19(1) (b);
  - (h) the vehicle is in actual use in connection with the removal of furniture to or from one office or dwelling house adjacent to the parking place from or to a depository, another office or dwelling house; or
  - (i) the vehicle is waiting otherwise than in a parking bay or parking space if goods are being sold or offered or exposed for sale from the vehicle by a person who is licensed by the Council to sell goods from a stationary vehicle on a pitch situated in a parking space.
- (2) No charge specified in the foregoing provisions of this Order shall be payable in respect of any vehicle waiting in a parking place in accordance with the foregoing provisions of this Article.
- (3) Nothing in the foregoing provisions of this Order shall be taken as authorising anything which would be a contravention of any Regulations made or having effect as if made under Section 25 of the Road Traffic Regulation Act 1984.

## **22. Manner of waiting in a parking place**

- (1) Every vehicle waiting in a parking place by virtue of the provisions of Article 21(1) (c), (g), (h) or (i) shall stand so that every part of the vehicle is wholly within the limits of the parking place unless the width of the vehicle precludes compliance with this paragraph.
- (2) If the width of the vehicle does preclude compliance with paragraph (1) of this Article the vehicle waiting in the parking place shall stand so that the longitudinal axis of the vehicle is parallel to the edge of the carriageway and the distance between the said edge and the nearest wheel of the vehicle is not more than 300 millimetres.
- (3) Every vehicle left in a parking place in relation to which special provisions as to the manner of standing of a vehicle in that parking place is specified in column 4 of Schedules 1 to 8 shall stand so that as to be in accordance with those provisions.

## **23. Installation of ticket machines, placing of signs etc**

- (1) The Council shall:
- (a) cause the limits of each parking place and of each parking space to be indicated on the carriageway by placing and maintaining thereon traffic signs (road markings) of any size, colour and type prescribed or authorised under Section 64 of the Road Traffic Regulation Act 1984; and



- (b) place and maintain in or in the vicinity of each parking place traffic signs of any size, colour and type prescribed by or authorised under the Road Traffic Regulation Act 1984; and
- (c) carry out such other work as is reasonably required for the purpose of the satisfactory operation of a parking place.

## **Section 2 - Residents' Permits**

### **24. Application for and issue of residents' permits for the use of parking places**

- (1) Any resident who is the user of a vehicle of the following class, that is to say a passenger vehicle, a goods vehicle the overall height of which does not exceed 2.28 metres and the overall length of which does not exceed 5.25 metres, a motor cycle or an invalid carriage, may apply to the Council for the issue of a residents' permit in respect of that vehicle and any such application shall be made on a form issued by and obtainable from the Council and shall include the particulars and information required by such form to be supplied.
- (2) The Council may at any time require an applicant for a residents' permit or a residents' permit holder to produce to an officer of the Council such evidence in respect of an application for a residents' permit made to them as they may reasonably call for to verify any particulars of information given to them or in respect of any residents' permit issued by them as they may reasonably call for to verify that the residents' permit is valid.
- (3) In receipt of an application duly made under the foregoing provisions of this Article and upon receipt of the charge specified in Schedule 13, the Council, upon being satisfied that the applicant is a resident and is the user of a vehicle of the class specified in paragraph (1) of this Article, shall issue to the applicant one residents' permit for the leaving during the permitted hours in a parking place referred to in Schedules 3, 4, 6, 7 and 8 of the vehicle to which such residents' permit relates by the owner of such vehicle or by any person using such with the consent of the owner other than a person to whom such vehicle has been let for hire or reward. Provided that, subject to the provisions of Article 25, the Council shall not issue a residents' permit to any resident which would be valid during any period during Which any other residents' permit issued to that resident is or would be valid.
- (4) Subject to the provisions of this Order a residents' permit shall be valid for a period of twelve months running from the beginning of the month in which the residents' permit first became valid.

### **25. Refund of charge paid in respect of a residents' permit**

- (1) A residents' permit holder who surrenders a residents' permit to the Council before it becomes valid shall be entitled to a refund of the charge paid in respect thereof less an administration charge of £15.
- (2) A residents' permit holder who surrenders a residents' permit to the Council after it has become valid shall be entitled to a refund of a part of the charge paid less an administration charge of £15. The refund will be paid pro rata for any complete months which remain unexpired at the time when the residents' permit is surrendered to the Council.

## **26. Application for and issue of business permits for the use of parking places**

- (1) Any business user who is the owner of a vehicle of the following class, that is to say a passenger vehicle, a goods vehicle the overall height of which does not exceed 2.50 metres and the overall length of which does not exceed 5.25 metres or a motor cycle may apply to the Council for the issue of a business permit in respect of that vehicle and any such application shall be made on a form issued by and obtainable from the Council and shall include the particulars and information required by such form to be supplied.
- (2) The Council may at any time require an applicant for a business permit or a business permit holder to produce to an officer of the Council such evidence in respect of an application for a business permit made to them as they may reasonably call for to verify any particulars or information given to them or in respect of any business permit issued by them as they may reasonably call for to verify that the business permit is valid.
- (3) Upon receipt of an application duly made under the foregoing provisions of this Article and upon receipt of the charge specified in Schedule 12 of this Article, the Council upon being satisfied that the applicant is a business user is the owner of a vehicle of the class specified in paragraph (1) of this Article, shall issue to the applicant one business permit for the leaving during the permitted hours in a parking space in any parking place referred to in Schedule 2, 4, 5 and 6 to this Order of the vehicle to which such business permit relates by the owner of such vehicle or by any person using such vehicle with the consent of the owner other than a person to whom such vehicle has been let for hire or reward.
- (4) Subject to the provisions of this Order a business permit shall be valid for a period of twelve months running from the date on which the business permit first becomes valid.

## **27. Refund of charge paid in respect of business permits**

- (1) A business permit holder who surrenders a business permit to the Council before it becomes valid shall be entitled to a refund of the charge paid in respect thereof less an administration charge of £15.
- (2) A business permit holder who surrenders a business permit to the Council after it has become valid shall be entitled to a refund of the charge paid less an administration charge of £15. The refund will be paid pro rata for any complete months which remain unexpired at the time when the residents' permit is surrendered to the Council.
- (4) The Council may at its absolute discretion limit the number of business permits that are issued at any one time in respect of businesses.

## **28. Surrender, withdrawal and validity of permits**

- (1) A permit holder may surrender a permit to the Council at any time and shall surrender a permit to the Council on the occurrence of any one of the events set out in paragraph (3) of this Article or in accordance with the provisions of paragraph (5) of this Article.
- (2) The Council may, by notice in writing served on the permit holder by sending the same by recorded delivery service to the residents' permit holder at the address shown by that person on the application for the permit or at any other address believed to be that person's place of abode, withdraw a residents' permit if it appears to the Council that any one of the events set out in paragraph (3)(a), (b) or (d) of this Article has occurred and

the residents' permit holder shall surrender the residents' permit to the Council within 48 hours of the receipt of the afore-mentioned notice.

- (3) The events referred to in the foregoing provisions of this Article are:
- (a) the permit holder ceasing to be a resident or a business user;
  - (b) the permit holder ceasing to be the owner of the vehicle in respect of which the permit was issued;
  - (c) the withdrawal of such permit by the Council under the provisions of paragraph (2) of this Article;
  - (d) the vehicle in respect of which such permit was issued being adapted or used in such a manner that it is not a vehicle of the class specified in respect of the parking place;
  - (e) the issue of the duplicate permit by the Council under the provisions of Article 29;
  - (f) the permit ceasing to be valid pursuant to the provisions of paragraph (4) of this Article.
- (4) Without prejudice to the foregoing provisions of this Article, a permit shall cease to be valid at the expiration of the period specified thereon or the occurrence of any one of the events set out in paragraph (3) (a), (b), (c), (d), (e) or (f) of this Article, whichever is the earlier.
- (5) Where a permit is issued to any person upon receipt of a cheque and the cheque is subsequently dishonoured, the permit shall cease to be of any effect and the Council shall by notice in writing served on the person to whom the permit was issued by sending the same by recorded delivery service to him at the address shown by that person on the application for the permit or any other address believed to be that person's place of abode, require that person to surrender the permit to the Council within 48 hours of the receipt of the afore-mentioned notice.

## **29. Application for and issue of a duplicate permit**

- (1) If a permit is mutilated or accidentally defaced or the figures or particulars thereon have become illegible or the colour of the permit has become altered by fading or otherwise, the permit holder shall either surrender it to the Council or apply to the Council for the issue to him of a duplicate permit and the Council upon the receipt of the permit, shall issue a duplicate permit so marked and upon such issue the permit shall become valid.
- (2) If a permit is lost or destroyed, the permit holder may apply to the Council for the issue to him of a duplicate permit and the Council, upon being satisfied as to the loss or destruction, shall issue a duplicate permit so marked and upon such issue the permit shall become valid.
- (3) The provisions of this Order shall apply to a duplicate permit and an application therefore as if it were a permit or, as the case may be, an application therefor.

## **30. Form of permit**

- (1) A residents' permit shall be in writing and shall include the following particulars:
- (a) the registration mark of the vehicle in respect of which the permit is issued;
  - (b) the period during which, subject to the provisions of Article 26(4), the residents' permit shall remain valid;

- (c) the zone to which the permit applies;
  - (d) an indication that the residents' permit has been issued by the Council; and
  - (e) permit type.
- (2) A business permit shall be in writing and shall include the following particulars:
- (a) the registration mark of the vehicle in respect of which the permit has been issued or the name of the company to which the permit has been issued;
  - (b) the period during which, subject to the provisions of Article 28(4), the business permit shall remain valid;
  - (c) the zone to which the permit applies;
  - (d) an indication that the business permit has been issued by the Council; and
  - (e) permit type.

### **Section 3 - Residents' Visitor Parking Cards**

#### **31. Application for the issue of residents' visitor parking cards for the use of parking places**

- (1) Any householder may apply to the Council for the issue of up to ten residents' visitor parking cards for a vehicle of the class described in Article 24(1) and belonging to a person visiting that household and any such application shall be made on a form issued by and obtainable from the Council and shall include the particulars and information required by such form to be supplied.
- (2) The Council may at any time require an applicant for residents' visitor parking cards to produce to an officer of the Council such evidence in respect of an application for such a residents' visitor parking cards made to them as they may reasonably call for to verify any particulars or information given to them.
- (3) On receipt of an application duly made under the foregoing provisions of this Article and upon receipt of the charge specified in Schedule 14, the Council upon being satisfied that the applicant is a householder, shall issue to the applicant thereof a maximum of ten residents' visitors parking cards in any 12 month period.

#### **32. Refund of charge paid in respect of a residents' visitor parking card**

- (1) A householder who surrenders a wholly unused residents' visitor parking card to the Council shall be entitled to a refund of the charge paid.

#### **33. Surrender, withdrawal and validity of a residents' visitor parking card**

- (1) A householder may surrender a residents' visitor parking card to the Council at any time and shall surrender a residents' visitor parking card to the Council on the occurrence of the event set out in paragraph (3) of this Article or in accordance with the provisions of paragraph (5) of this Article.
- (2) The Council may, by notice in writing served on the householder by sending the same by recorded delivery service to the householder at the address shown by that person on the application for the residents' visitor parking card or any other address believed to be that person's place of abode, withdraw a residents' visitor parking card if it appears to the Council that the event set out in paragraph (3)(a) of this Article has occurred and the

householder shall surrender the residents' visitor parking card to the Council within 48 hours of the receipt of the afore-mentioned notice.

- (3) The events referred to in the foregoing provisions of this Article are:
  - (a) the householder ceasing to be a resident;
  - (b) the withdrawal of such a residents' visitor parking card by the Council under the provisions of paragraph (2) of this Article;
  - (c) the residents' visitor parking card ceasing to be valid pursuant to the provisions of paragraph (4) of this Article.
- (4) Without prejudice to the foregoing provisions of this Article, a residents' visitor parking card shall cease to be valid at the expiration of the period specified thereon or on the occurrence of any one of the events set out in paragraph (3) (a) or (b) of this Article, whichever is the earlier.
- (5) Where residents' visitor parking cards are issued to any person upon receipt of a cheque and the cheque is subsequently dishonoured, the residents' visitor parking cards shall cease to be of any effect and the Council shall by notice in writing served on the person to whom the residents' visitor parking cards were issued by sending the same by recorded delivery service to him at the address shown by that person on the application for the residents' visitor parking cards or at any other address believed to be that person's place of abode, require that person to surrender the residents' visitor parking cards to the Council within 48 hours of the receipt of the afore-mentioned notice.

#### **34. Application for and issue of replacement residents' visitor parking cards**

- (1) If a residents' visitor parking card is mutilated or accidentally defaced or the figures or particulars thereon have become illegible or the colour of the residents' visitor parking card has become altered by fading or otherwise, the householder shall either surrender it to the Council or apply to the Council for the issue of a replacement residents' visitor parking card and the Council, upon receipt of the residents' visitor parking card, shall issue a replacement residents' visitor parking card.
- (2) The provisions of this Order shall apply to a replacement residents' visitor parking card and an application therefor as if it were a residents' visitor parking card or, as the case may be, an application therefor.

#### **35. Form of residents' visitor parking card**

- (1) A residents' visitor parking card shall be in writing and shall include the following particulars:
  - (a) the year;
  - (b) the month;
  - (c) the date in the month;
  - (d) the time of arrival;
  - (e) the vehicle registration mark;
  - (f) the period during which, subject to the provisions of Article 31(3), the residents' visitor parking card may remain valid;
  - (g) the zone to which the residents' visitors parking card applies;
  - (h) an indication that the residents' visitor parking card has been issued by the Council.

- (2) The details required by paragraph (1)(a), (1)(b), (1)(c), (1)(d) and (1)(e) shall be written in on the residents' visitors parking card in ink in the spaces provided.

Dated this sixteenth day of March 2015

A handwritten signature in black ink, appearing to read "M. J. Brown", is written above the title.

Director of Regeneration, Economic Development & Environment  
(the officer appointed for the purpose)

**SCHEDULE 1**  
**Pay by phone parking places**

No. of parking place	Designated parking place	Minimum number of parking bays	Special manner of standing
1.	2.	3.	4.
No items			

**SCHEDULE 2**  
**Pay by phone and Business Permit parking places**

No. of parking place	Designated parking place	Minimum number of parking bays	Special manner of standing
1.	2.	3.	4.
No items.			



### SCHEDULE 3

#### Pay by phone, Resident Permit and Residents' Visitor Parking Card parking places

No. of parking place	Designated parking place	Minimum number of parking bays	Special manner of standing
1.	2.	3.	4.

No items

## SCHEDULE 4

### Pay by phone, Business Permit, Resident Permit and Residents' Visitor Parking Card parking places

In relation to a parking place referred to in this Schedule, the expression "permitted hours" means the period between 10am to 11am and 7pm to 8pm Mondays to Fridays inclusive and between 2.30pm and 3.30pm on an event day, and any such day not being Christmas Day, Good Friday or a Bank Holiday –maximum stay 30 minutes

No. of parking place	Designated parking place	Minimum number of parking bays	Special manner of standing
1.	2.	3.	4.
1	<b>Braemar Road, Brentford</b> , the south-east side, from a point 7.3 metres north-east of the north-eastern building line of No.32 Braemar Road to a point 11.0 metres south-west of the south-western kerb-line of Ealing Road	1	-
2	<b>Clifden Road, Brentford</b> , the south-east side, from a point 12.0 metres north-east of the north-eastern kerb-line of Windmill Road to a point 5.2 metres south-west of the south-western building line of Parr Cottage, Clifden Road	1	-
3	<b>Hamilton Road, Brentford</b> , the south-east side, from a point 3.5 metres south-west of the boundary wall of Nos. 33/34 Hamilton Road to a point 0.5 metres north-west of the boundary wall of Nos. 36/36A Hamilton Road	1	-
4	<b>Lateward Road, Brentford</b> , the south-east & north-east side, from a point 0.7 metres south-west of the north-eastern building line of No.38 Brook Road South to a point 6.0 metres north-east of the north-eastern building line of Nos. 3 – 6 Lateward Road	1	-
5	<b>Lateward Road, Brentford</b> , the south-east & North-east side, from a point opposite a point 2.6 metres south-west of the boundary of wall of Nos. 25 / 26 Lateward Road to a point opposite the boundary wall of Nos. 41/42 Lateward Road	1	-

## SCHEDULE 4 (continued)

No. of parking place	Designated parking place	Minimum number of parking bays	Special manner of standing
1.	2.	3.	4.
6	<b>Lateward Road, Brentford</b> , south-east & North-east side, from a point opposite the boundary wall of Nos. 42 / 43 Lateward Road to a point opposite the boundary wall of Nos. 56 / 57 Lateward Road	1	-
7	<b>Lateward Road, Brentford</b> , south-east & North-east side, from a point opposite the boundary line of Nos. 62 / 63 Lateward Road to a point 3.7 metres south-east of the boundary line of Nos. 71 / 72 Lateward Road	1	-
8	<b>Lateward Road, Brentford</b> , the north-west & south-west side, from a point 0.5 metres south-west of the north-eastern building line of No.40 Brook Road South to a point 11.0 metres south-west of the north-eastern building line of No.40 Brook Road South	1	-
9	<b>New Road, Brentford</b> , north-west side, from a point 1.5 metres north-east of the boundary wall of Nos.42 / 43 New Road to a point 7.3 metres north-east of the north-eastern kerb-line of Brook Road South	1	-

**SCHEDULE 5**  
**Business Permit parking places**

No. of parking place	Designated parking place	Minimum number of parking bays	Special manner of standing
1.	2.	3.	4.
No items.			

## SCHEDULE 6

### Business Permit, Resident Permit and Residents' Visitor Parking Card parking places

No. of parking place	Designated parking place	Minimum number of parking bays	Special manner of standing
1.	2.	3.	4.

No items.

**SCHEDULE 7**  
**Resident Permit and Residents' Visitor Parking Card parking places**

In relation to a parking place referred to in this Schedule, the expression "permitted hours" means the period between 10am to 11am and 7pm to 8pm Mondays to Fridays inclusive and between 2.30pm and 3.30pm on an event day, and any such day not being Christmas Day, Good Friday or a Bank Holiday

No. of parking place	Designated parking place	Minimum number of parking bays	Special manner of standing
1.	2.	3.	4.
10	<b>Braemar Road, Brentford</b> , the south-east side, from a point 7.0 metres north-east of the north-eastern kerb-line of Brook Road South to a point 0.3 metres north-east of the north-eastern building line of No.32 Braemar Road	1	
11	<b>Braemar Road, Brentford</b> , the north-west side, from a point 3.0 metres north-east of the south-western building line of No.59 Brook Road South to a point 1.3 metres north-east of the north-eastern building line of No.59A Brook Road South	1	
12	<b>Braemar Road, Brentford</b> , the north-west side, from a point 2.0 metres south-west of the south-western building line of No.64 Braemar Road to a point 1.3 metres south-west of the common boundary of Nos.53/54 Braemar Road	1	
13	<b>Braemar Road, Brentford</b> , the north-west side, from the boundary wall of Nos. 52/53 Braemar Road to a point 11.8 metres north-east of the north-eastern building line of No.46 Braemar Road	1	
14	<b>Braemar Road, Brentford</b> , the north-west side, from a point 15.7 metres south-west of the south-western building line of No.36 Braemar Road to a point 11.0 metres south-west of the south-western kerb-line of Ealing Road	1	
15	<b>Brook Lane North, Brentford (south of the railway line)</b> , the south-west side, from a point 5.0 metres north-west of the north-western kerb-line of Hamilton Road north-westwards for a distance of 8.0 metres	1	

## SCHEDULE 7 (continued)

No. of parking place	Designated parking place	Minimum number of parking bays	Special manner of standing
1.	2.	3.	4.
16	<b>Brook Lane North, Brentford (south of the railway line)</b> , the south-west side, from a point 0.8 metres north-west of the south-eastern building line of No.2 Brook Lane North north-west for a distance of 14.4 metres	1	
17	<b>Brook Lane North, Brentford (south of the railway line)</b> , the south-west side, from a point 11.1 metres south-east of the north-western building line of No.12 Brook Lane North to a point 2.7 metres north-west of the north-western building line of No.12 Brook Lane North	1	
18	<b>Brook Road South, Brentford</b> , the north-east side, from a point 2.8 metres north-west of the south-eastern building line of No.1 Brook Road South to a point 3.8 metres south-east of the north-western building line of No.43 Brook Road South	1	
19	<b>Brook Road South, Brentford</b> , the north-east side, from a point 4.0 metres north-west of the south-eastern building line of No.45 Brook Road South to the common boundary of Nos. 53 / 55 Brook Road South	1	
20	<b>Brook Road South, Brentford</b> , the north-east side, from the common boundary of Nos. 55/57 Brook Road South to a point opposite the boundary wall of Nos. 52/54 Brook Road South	1	

### SCHEDULE 7 (continued)

No. of parking place	Designated parking place	Minimum number of parking bays	Special manner of standing
1.	2.	3.	4.
21	<b>Brook Road South, Brentford</b> , the north-east side, from a point 2.0 metres north-west of the south-eastern building line of No.59 Brook Road South to a point 1.0 metre south-east of the north-western building line of No.79 Brook Road South	1	
22	<b>Brook Road South, Brentford</b> , the north-east side, from a point 2.4 metres north-west of the south-eastern building line of Nos.1 to 24 Brook Court, Brook Road South to a point 7.3 metres south-east of the north-western building line of Nos. 1 to 24 Brook Court, Brook Road South	1	
23	<b>Brook Road South, Brentford</b> , the north-east side, from a point 6.0 metres north-west of the south-eastern building line of Nos.25 to 48 Braemar Court, Brook Road South to a point 1.8 metres north-west of the north-western building line of Nos. 25 to 48 Braemar Court, Brook Road South	1	
24	<b>Brook Road South, Brentford</b> , the north-east side, from a point opposite the boundary wall of Nos. 110 / 112 Brook Road South to a point 3.6 metres south-east of the north-western building line of No.38 New Road (The Royal Oak PH)	1	
25	<b>Brook Road South, Brentford</b> , the south-west side, from a point 1.8 metres north-west of the south-eastern building line of No.2 Albany Road to a point 4.0 metres south-east of the south-eastern kerb-line of Grosvenor Road	1	
26	<b>Brook Road South, Brentford</b> , the south-west side, from the south-eastern building line of No.14 Brook Road South to a point 5.8 metres south-east of the south-eastern building line of No.22 Brook Road South	1	



## SCHEDULE 7 (continued)

No. of parking place	Designated parking place	Minimum number of parking bays	Special manner of standing
1.	2.	3.	4.
27	<b>Brook Road South, Brentford</b> , the south-west side, from a point 1.6 metres north-west of the south-eastern building line of No.22 Brook Road South to a point 2.4 metres south-east of the north-western building line of No.38 Brook Road South	1	
28	<b>Brook Road South, Brentford</b> , the south-west side, from a point 2.0 metres north-west of the south-eastern building line of No.40 Brook Road South to a point 2.0 metres north-west of the boundary wall of Nos. 54 / 56 Brook Road South	1	
29	<b>Brook Road South, Brentford</b> , the south-west side, from a point 1.0 metre south-east of the boundary wall of Nos. 62 / 64 Brook Road South to a point 1.5 metres south-east of the north-western building line of No.96 Brook Road South	1	
30	<b>Brook Road South, Brentford</b> , the south-west side, from a point 5.0 metres north-west of the north-western kerb-line of Clifton Road to a point 1.4 metres south-east of the common boundary of Nos. 106 / 108 Brook Road South	1	
31	<b>Brook Road South, Brentford</b> , the south-west side, from a point 4.3 metres north-west of the common boundary of Nos. 106 / 108 Brook Road South to a point 4.2 metres south-east of the common boundary of Nos. 110 / 112 Brook Road South	1	
32	<b>Brook Road South, Brentford</b> , the south-west side, from a point 1.5 metres north-west of the common boundary of Nos. 110 / 112 Brook Road South to a point 3.0 metres south-east of a point opposite the north-western building line of No.38 New Road (The Royal Oak PH)	1	

### SCHEDULE 7 (continued)

No. of parking place	Designated parking place	Minimum number of parking bays	Special manner of standing
1.	2.	3.	4.
33	<b>Clifden Road, Brentford</b> , the south-east side, from a point 1.2 metres north-east of the south-western building line of Parr Cottage, Clifden Road to a point 0.6 metres north-east of the boundary wall of Nos.14 / 16 Clifden Road	1	
34	<b>Clifden Road, Brentford</b> , the south-east side, from the north-eastern building line of No.16 Clifden Road to a point 1.9 metres south-west of the north-eastern wall of No.36A Clifden Road	1	
35	<b>Clifden Road, Brentford</b> , the south-east side, from a point 0.5 metres north-east of the south-western building line of No.38 Clifden Road to a point 1.4 metres south-west of the boundary wall of Nos.44 / 46 Clifden Road	1	
36	<b>Clifden Road, Brentford</b> , the south-east side, from a point 2.6 metres south-west of the boundary wall of Nos.46 / 48 Clifden Road to a point 2.5 metres south-west of the north-eastern building line of No.98 Brook Road South	1	
37	<b>Clifden Road, Brentford</b> , the north-west side, from a point 12.0 metres north-east of the south-eastern kerb-line of Windmill Lane to a point 1.0m north-east of the north-eastern building line of No.12 Clifden House, Clifden Road	1	
38	<b>Clifden Road, Brentford</b> , the north-west side, from a point 14.3 metres north-east of the north-eastern building line of No.12 Clifden House, Clifden Road to a point 6.8 metres south-west of the south-western building line of No.1 Clifden Road	1	

### SCHEDULE 7 (continued)

No. of parking place	Designated parking place	Minimum number of parking bays	Special manner of standing
1.	2.	3.	4.
39	<b>Clifden Road, Brentford</b> , the north-west side, from a point 0.7 metres south-west of the south-western building line of No.1 Clifden Road to a point 0.6 metres north-east of the boundary wall of Nos.1 / 3 Clifden Road	1	
40	<b>Clifden Road, Brentford</b> , the north-west side, from a point 0.5 metres south-west of the boundary wall of Nos.5 / 7 Clifden Road to a point opposite the boundary wall of Nos.14 / 16 Clifden Road	1	
41	<b>Clifden Road, Brentford</b> , the north-west side, from a point 0.7 metres south-west of the boundary wall of Nos.21 / 23 Clifden Road to a point 4.8 metres north-east of the boundary wall of Nos.21 / 23 Clifden Road	1	
42	<b>Clifden Road, Brentford</b> , the north-west side, from a point 4.0 metres south-west of the boundary wall of Nos.25 / 27 Clifden Road to a point 4.0 metres north-east of the boundary wall of Nos.25 / 27 Clifden Road	1	
43	<b>Clifden Road, Brentford</b> , the north-west side, from the boundary wall of Nos.29 / 31 Clifden Road north-eastwards for a distance of 4.5 metres	1	
44	<b>Clifden Road, Brentford</b> , the north-west side, from the boundary wall of Nos.33 / 35 Clifden Road to the south-western building line of No.39 Clifden Road	1	
45	<b>Clifden Road, Brentford</b> , the north-west side, from a point 0.8 metres north-east of the boundary wall of Nos.41 / 43 Clifden Road to a point 0.7 metres south-west of the boundary wall of Nos.45 / 47 Clifden Road	1	

## SCHEDULE 7 (continued)

No. of parking place	Designated parking place	Minimum number of parking bays	Special manner of standing
1.	2.	3.	4.
46	<b>Clifden Road, Brentford</b> , the north-west side, from a point 2.5 metres north-east of the north-eastern building line of No.47 Clifden Road to a point 2.5 metres north-east of the south-western building line of No.53 Clifden Road	1	
47	<b>Clifden Road, Brentford</b> , the north-west side, from a point 3.3 metres south-west of the south-western building line of No.98 Brook Road South to a point 6.0 metres south-west of the south-western kerb-line of Brook Road South	1	
48	<b>Ealing Road, Brentford</b> , the south-west side, from a point 2.0 metres north-west of the boundary wall of Nos.151 / 153 Ealing Road to the south-eastern building line of No.143 Ealing Road	1	
49	<b>Ealing Road, Brentford</b> , the south-west side, from a point 2.5 metres south-east of the north-western building line of No.129 Ealing Road to the boundary wall of Nos.107/109 Ealing Road	1	
50	<b>Ealing Road, Brentford</b> , the south-west side, from a point 2.3 metres north-west of the boundary wall of Nos.83 / 85 Ealing Road to a point 3.3 metres north-west of the south-eastern building line of No.37 Ealing Road	1	
51	<b>Ealing Road, Brentford</b> , the north-east side, the service road fronting Nos.48 to 64 Ealing Road, the south-west side, from a point 1.2 metres south-east of the boundary wall of Nos.48 / 50 Ealing Road to a point 1.6 metres north-west of the north-western building line of No.62 Ealing Road	1	

### SCHEDULE 7 (continued)

No. of parking place	Designated parking place	Minimum number of parking bays	Special manner of standing
1.	2.	3.	4.
52	<b>Ealing Road, Brentford</b> , the north-east side, the service road fronting Nos. 48 to 64 Ealing Road, the north-east side, from a point 10.0 metres north-east of the north-eastern kerb-line of Ealing Road to a point 0.4 metres north-west of the south-eastern building line of No.64 Ealing Road	1	
53	<b>Ealing Road, Brentford</b> , the north-east side, the service road fronting Nos. 48 to 64 Ealing Road, the north-east side, from the north-western building line of No.62 Ealing Road to the boundary wall of No.48 / 50 Ealing Road	1	
54	<b>Ealing Road, Brentford</b> , the north-east side, the service road fronting Nos. 48 to 64 Ealing Road, the north-east side, from the south-eastern building line of No.48 Ealing Road to a point 12.0 metres north-east of the north-eastern kerb-line of Ealing Road	1	
55	<b>Grosvenor Road, Brentford</b> , the north-west side, from a point 5.0 metres south-west of the south-western kerb-line of Brook Road South south-westwards for a distance of 9.0 metres	1	
56	<b>Grosvenor Road, Brentford</b> , the north-west side, from a point 4.4 metres north-east of the boundary wall of No 1 Grosvenor Road and No.14 Brook Road South to the south-western building line of No.22 Grosvenor Road	1	
57	<b>Grosvenor Road, Brentford</b> , the south-east side, from a point 4.5 metres south-west of the south-western kerb-line of Brook Road South to the boundary wall of Nos. 23/24 Grosvenor Road	1	

## SCHEDULE 7 (continued)

No. of parking place	Designated parking place	Minimum number of parking bays	Special manner of standing
1.	2.	3.	4.
58	<b>Hamilton Road, Brentford</b> , the south-east side, from a point 0.5 metres north-east of the south-western building line of No. 1 Hamilton Road to a point 1.5 metres south-west of the boundary wall of Nos. 11/12 Hamilton Road	1	
59	<b>Hamilton Road, Brentford</b> , the south-east side, from a point 4.5 metres north-east of the boundary wall of Nos. 11/12 Hamilton Road to a point 1.9 metres south-west of the north-eastern building line of No. 16 Hamilton Road	1	
60	<b>Hamilton Road, Brentford</b> , the south-east side, from a point 3.2 metres south-west of the boundary wall of Nos. 17/18 Hamilton Road to a point 3.5 metres south-west of the boundary wall of Nos. 33/34 Hamilton Road	1	
61	<b>Hamilton Road, Brentford</b> , the north-west side, from a point 3.0 metres south-west of the north-eastern building line of No. 37 Hamilton Road to a point 4.6 metres north-east of the north-eastern kerb-line of Westbury Place	1	
62	<b>Hamilton Road, Brentford</b> , the north-west side, from a point 2.0 metres north-east of the boundary wall of Nos. 44/45 Hamilton Road to the boundary wall of Nos. 48/49 Hamilton Road	1	
63	<b>Hamilton Road, Brentford</b> , the north-west side, from the boundary wall of Nos. 49/50 Hamilton Road to a point 0.6 metres north-east of the north-eastern building line of No. 56 Hamilton Road	1	
64	<b>Hamilton Road, Brentford</b> , the north-west side, from the boundary wall of Nos. 56/57 Hamilton Road to the boundary wall of Nos. 57/58 Hamilton Road	1	

## SCHEDULE 7 (continued)

No. of parking place	Designated parking place	Minimum number of parking bays	Special manner of standing
1.	2.	3.	4.
65	<b>Hamilton Road, Brentford</b> , the north-west side, from a point 5.5 metres south-west of the boundary wall of Nos. 57/58 Hamilton Road to a point 0.5 metres north-east of the boundary wall of Nos. 63/64 Hamilton Road	1	
66	<b>Hamilton Road, Brentford</b> , the north-west side, from a point 0.5 metres south-west of the boundary wall of Nos. 64/65 Hamilton Road to a point 1.5 metres south-west of the south-western building line of No. 71 Hamilton Road	1	
67	<b>Hamilton Road, Brentford</b> , the north-west side, from a point 8.8 metres north-east of the north-eastern kerb-line of Windmill Road, north-eastwards for a distance of 5.0 metres	1	
68	<b>Lateward Road, Brentford</b> , the south-east & north-east side, from a point 2.0 metres south-west of north-eastern building line of Nos. 3 – 6 Lateward Road to a point opposite the boundary wall of Nos. 24 / 25 Lateward Road	1	
69	<b>Lateward Road, Brentford</b> , the north-west & south-west side, from a point opposite a point 3.0 metres south-west of north-eastern building line of Nos.3 – 6 Lateward Road to a point 1.5 metres north-east of the south-western building line of No.22 Lateward Road	1	
70	<b>Lateward Road, Brentford</b> , the north-west & south-west side, from a point 1.3 metres south-west of the north-eastern building line of No.23 Lateward Road to the boundary wall of Nos.24 / 25 Lateward Road	1	
71	<b>Lateward Road, Brentford</b> , the north-west & south-west side, from a point 0.5 metres south-west of the boundary wall of Nos.25 / 26 Lateward Road to the boundary wall of Nos.41 / 42 Lateward Road	1	

## SCHEDULE 7 (continued)

No. of parking place	Designated parking place	Minimum number of parking bays	Special manner of standing
1.	2.	3.	4.
72	<b>Lateward Road, Brentford</b> , the north-west & south-west side, from the boundary wall of Nos. 42 / 43 Lateward Road to a point 0.5 metres north-east of the boundary wall of Nos. 54 / 55 Lateward Road	1	
73	<b>Lateward Road, Brentford</b> , the north-west & south-west side, from a point 0.5 metres south-west of the boundary wall of Nos. 55 / 56 Lateward Road to the boundary wall of Nos. 58 / 59 Lateward Road	1	
74	<b>Lateward Road, Brentford</b> , the north-west & south-west side, from a point 1.5 metres north-west of the boundary wall of Nos. 60 / 61 Lateward Road to a point 1.5 metres north-west of the south-eastern building line of No.72 Lateward Road	1	
75	<b>Mafeking Avenue, Brentford</b> , north-east & north-west side, from a point 2.2 metres north-west of the south-eastern building line of No.4 Market Terrace, Albany Road to a point 1.2 metres north-west of the boundary wall of Nos. 37/39 Mafeking Avenue	1	
76	<b>Mafeking Avenue, Brentford</b> , north-east & north-west side, from a point 0.5 metres south-west of the boundary wall of Nos. 49/51 Mafeking Avenue to a point 1.1 metres south-west of the boundary wall of Nos.71 / 73 Mafeking Avenue	1	
77	<b>Mafeking Avenue, Brentford</b> , north-east & north-west side, from a point 1.0 metre south-west of the north-eastern building line of No.45 Brook Road South to a point 0.6 metres north-east of the south-western building line of No.45 Brook Road South	1	



## SCHEDULE 7 (continued)

No. of parking place	Designated parking place	Minimum number of parking bays	Special manner of standing
1.	2.	3.	4.
78	<b>Mafeking Avenue, Brentford</b> , south-east & south-west side, from a point 1.5 metres north-west of the south-eastern building line of No.5 Market Terrace, Albany Road to the north-western building line of No.5 Market Terrace, Albany Road	1	
79	<b>Mafeking Avenue, Brentford</b> , south-east & south-west side, from the south-eastern building line of No.2 Mafeking Avenue to the boundary wall of Nos. 34/36 Mafeking Avenue	1	
80	<b>Mafeking Avenue, Brentford</b> , south-east & south-west side, from a point opposite the boundary wall of Nos. 53/55 Mafeking Avenue to a point 0.3 metres north-east of the south-western building line of No.43 Brook Road South	1	
81	<b>New Road, Brentford</b> , the north-west side, from a point 7.5 metres south-west of the south-western kerb-line of Ealing Road to a point opposite a point 1.2 metres north-east of the boundary wall of Nos.76 / 77 New Road	1	
82	<b>New Road, Brentford</b> , the north-west side, from the north-eastern building line of No.2 New Road to a point 1.3 metres north-east of the south-western building line of No.7 New Road	1	
83	<b>New Road, Brentford</b> , the north-west side, from a point 1.9 metres north-east of the south-western building line of No.9 New Road to a point 1.2 metres north-east of the south-western building line of No.19 New Road	1	
84	<b>New Road, Brentford</b> , the north-west side, from the north-eastern building line of No.20 New Road to a point 1.4 metres north-east of the south-western building line of No.24 New Road	1	

## SCHEDULE 7 (continued)

No. of parking place	Designated parking place	Minimum number of parking bays	Special manner of standing
1.	2.	3.	4.
85	<b>New Road, Brentford</b> , the north-west side, from a point 2.1 metres north-east of the boundary wall of Nos.25 / 26 New Road to a point 1.4 metres north-east of the south-western building line of No.26 New Road	1	
86	<b>New Road, Brentford</b> , the north-west side, from the north-eastern building line of No.27 New Road to a point opposite a point 1.4 metres north-east of the boundary wall of Nos.44 / 45 New Road	1	
87	<b>Westbury Place, Brentford</b> , the south-west side, from a point 4.5 north-west of the north-western kerb-line of Hamilton Road to a point 6.3 metres south-east of the south-eastern building line of No. 2 Westbury Place	1	
88	<b>Westbury Place, Brentford</b> , the south-west side, from a point 1.0 metres south-east of the south-eastern building line of No. 2 Westbury Place to a point 1.0 metres north-west of the boundary wall of Nos. 6/8 Westbury Place	1	
89	<b>Westbury Place, Brentford</b> , the south-west side, from a point 7.0 metres north-west of the boundary wall of Nos. 6/8 Westbury Place to a point 2.1 metres north-west of the boundary wall of Nos. 12/14 Westbury Place	1	
90	<b>Westbury Place, Brentford</b> , the north-east side, from a point 1.0 metres north-west of the boundary wall of Nos. 11/13 Westbury Place to a point 1.0 metres south-east of the south-eastern building line of No. 1 Westbury Place	1	
91	<b>Westbury Place, Brentford</b> , the north-east side, from a point 6.0 metres south-east of the south-eastern building line of No. 1 Westbury Place to a point 4.5 metres north-west of the north-western kerb-line of Hamilton Road	1	

**SCHEDULE 8**  
**Resident Permit parking places**

No. of parking place	Designated parking place	Minimum number of parking bays	Special manner of standing
1.	2.	3.	4.
No items.			

## **SCHEDULE 9**

### **Streets or parts of streets for the purpose of the definition of “business”**

Braemar Road, Brentford  
Brook Lane North, Brentford - Nos 2 – 14 (evens) Brook Lane North  
Brook Road South, Brentford  
Clifden Road, Brentford  
Ealing Road, Brentford - Nos 48 – 82 (evens) & 23 – 155 (odds) Ealing Road  
Grosvenor Road, Brentford  
Hamilton Road, Brentford  
Lateward Road, Brentford  
Mafeking Avenue, Brentford  
New Road, Brentford  
Tunstall Walk, Brentford  
Westbury Place, Brentford

## **SCHEDULE 10**

### **Streets or parts of streets for the purpose of the definition of “resident”**

Braemar Road, Brentford  
Brook Lane North, Brentford - Nos 2 – 14 (evens) Brook Lane North  
Brook Road South, Brentford  
Clifden Road, Brentford  
Ealing Road, Brentford - Nos 48 – 82 (evens) & 23 – 155 (odds) Ealing Road  
Grosvenor Road, Brentford  
Hamilton Road, Brentford  
Lateward Road, Brentford  
Mafeking Avenue, Brentford  
New Road, Brentford  
Tunstall Walk, Brentford  
Westbury Place, Brentford

**SCHEDULE 11**  
**On-Street Pay by Phone Parking Charges (excluding service charge)**

Charge	Period (Minutes)
£ 0.10	3
£ 0.20	6
£ 0.30	9
£ 0.40	12
£ 0.50	15
£ 0.60	18
£ 0.70	21
£ 0.80	24
£ 0.90	27
<b>£ 1.00</b>	<b>30</b>
£ 1.10	33
£ 1.20	36
£ 1.30	39
£ 1.40	42
£ 1.50	45
£ 1.60	48
£ 1.70	51
£ 1.80	54
£ 1.90	57
£ 2.00	60
£ 2.10	63
£ 2.20	66
£ 2.30	69
£ 2.40	72
£ 2.50	75
£ 2.60	78
£ 2.70	81
£ 2.80	84
£ 2.90	87
£ 3.00	90
£ 3.10	93
£ 3.20	96
£ 3.30	99
£ 3.40	102
£ 3.50	105
£ 3.60	108
£ 3.70	111
£ 3.80	114
£ 3.90	117
£ 4.00	120
£ 4.10	123
£ 4.20	126

Charge	Period (Minutes)
£ 4.30	129
£ 4.40	132
£ 4.50	135
£ 4.60	138
£ 4.70	141
£ 4.80	144
£ 4.90	147
£ 5.00	150
£ 5.10	153
£ 5.20	156
£ 5.30	159
£ 5.40	162
£ 5.50	165
£ 5.60	168
£ 5.70	171
£ 5.80	174
£ 5.90	177
£ 6.00	180
£ 6.10	183
£ 6.20	186
£ 6.30	189
£ 6.40	192
£ 6.50	195
£ 6.60	198
£ 6.70	201
£ 6.80	204
£ 6.90	207
£ 7.00	210
£ 7.10	213
£ 7.20	216
£ 7.30	219
£ 7.40	222
£ 7.50	225
£ 7.60	228
£ 7.70	231
£ 7.80	234
£ 7.90	237
£ 8.00	240
£ 8.10	243
£ 8.20	243
£ 8.30	249
£ 8.40	252

Charge	Period (Minutes)
£ 8.50	255
£ 8.60	258
£ 8.70	261
£ 8.80	264
£ 8.90	267
£ 9.00	270
£ 9.10	273
£ 9.20	276
£ 9.30	279
£ 9.40	282
£ 9.50	285
£ 9.60	288
£ 9.70	291
£ 9.80	294
£ 9.90	297
£ 10.00	300
£ 10.10	303
£ 10.20	306
£ 10.30	309
£ 10.40	312
£ 10.50	315
£ 10.60	318
£ 10.70	321
£ 10.80	324
£ 10.90	327
£ 11.00	330
£ 11.10	333
£ 11.20	336

**SCHEDULE 12**  
**Business Permit Charges**

	<b>12-month permit</b>
<b>Goods vehicle</b>	£450
<b>Passenger vehicle</b>	£670

**SCHEDULE 13**  
**Resident Permit Charges**

	<b>12 month permit</b> Band A and B * vehicles registered on or after 1 March 2001	<b>12 month permit</b> All other vehicles
<b>First vehicle</b>	£30	£60
<b>Second vehicle</b>	£100	£100
<b>Third &amp; subsequent vehicles</b>	£165	£165

\* Vehicles whose CO<sub>2</sub> emissions figure does not exceed 110 g/km

**SCHEDULE 14**  
**Residents' Visitors Parking Card Charges**

	<b>Each card</b>
<b>Residents' visitors parking card</b>	£20

---

**EXPLANATORY NOTE**

(This note is not part of the Order, but is intended to indicate its general purport)

This Order designates parking places in certain lengths of street in the vicinity of Brook Road South and the Brentford Football Club, Braemar Road, Brentford in the London Borough of Hounslow at which vehicles displaying a valid business permit, residents permit or a valid residents visitors parking card or evidence of payment for a pay and display parking bay issued by London Borough of Hounslow may be left in designated areas. The controlled parking zone will be known as Brook Road South.

# Traffic Management Order

2018 No.77

---

The London Borough of Hounslow (Parking Places) (Parking Charges) Order 2018

Made on 29 October 2018

Coming into operation on 3 November 2018

---

The Council of the London Borough of Hounslow, having consulted the Commissioner of Police of the Metropolis, in exercise of the powers conferred by sections 46 and 124 of the Road Traffic Regulation Act 1984<sup>a</sup> as amended, and of all other powers thereunto enabling hereby make the following Order:

1. This Order may be cited as the London Borough of Hounslow (Parking Places) (Parking Charges) Order 2018 and shall come into operation for all purposes on 3 November 2018.
2. Without prejudice to the validity of anything done or to any liability incurred by the coming into operation of this Order, each of the Orders specified in Schedule 1 to this Order is hereby varied so that:

- a. in Article 3(1) the expression “householder” is removed.

- b. in Article 3(1) there were added the following definitions:

“diesel vehicle” means a vehicle in which the motive power is wholly or partially derived directly or indirectly from a compression ignition engine.”

“electric vehicle” means a vehicle in which the electrical motive power is derived from an electrical storage battery which is not connected to any source of power derived from fossil fuel when the vehicle is in motion.

“household” means either one person living alone or a group of people (related or not) living together in a room, or rooms, or flat or house having an individual postal address.

“low emission vehicle” means a Band A or B vehicle registered between 1 March 2001 and 31 March 2017, or a vehicle registered on or after 1 April 2017 whose carbon dioxide emissions figure does not exceed 50 grams per kilometre driven.

“Band A or B vehicle” means a vehicle whose carbon dioxide emissions figure does not exceed 110 grams per kilometre driven.

“carbon dioxide emissions figure” has the same meaning as in the Vehicle Excise and Registration Act 1994<sup>b</sup>, as amended. For the avoidance of doubt, this is intended to have the same meaning as that used by DVLA for the purpose of vehicle excise duty at the time when this order was made. If there should be any future amendment to the meaning as used by DVLA, such amendment will not, of itself, be binding on the Council for the purposes of this order.

---

<sup>a</sup> 1984 c. 27

<sup>b</sup> 1994 c. 22

- c. in Article 26 there were added the following paragraphs:
  - (5) Notwithstanding the foregoing provisions of this Order, no permit shall be issued to a resident of a housing unit subject to a planning consent to which has been appended an Informative or which is restricted by a planning obligation made under section 106 of the Town and Country Planning Act 1990<sup>a</sup> indicating that such resident will not be entitled to a residents' parking permit.
  - (6) The carbon dioxide emissions figure of any vehicle is that which is recorded as the engine emissions in the vehicle's registration document or registration certificate. If the registration document or certificate in respect of the vehicle for which the permit is being issued does not contain a statement as to the carbon dioxide emissions figure then the low emission vehicles rates will not apply.
  - (7) Permits issued for low emission vehicles, whether also diesel vehicles or not, will always be counted first when counting the total number of residents' permits issued to a household. Where permits have previously been issued to any member of a household then any permits subsequently issued for low emission vehicles will be counted first when permits previously issued are renewed.
- d. the heading for Article 27 is amended to "Refund of charge paid and change of vehicle in respect of a residents' permit"
- e. in Article 27 there were added the following paragraphs:
  - (3) On a change of vehicle where the replacement vehicle is a low emission vehicle and the Council issues a replacement permit the resident shall be entitled to a refund of the charge paid less an administration charge as set by the Council. The refund will be paid pro rata for any complete months which remain unexpired at the time when the change of vehicle is notified to the Council.
  - (4) On a change of vehicle where the replacement vehicle is not a low emissions vehicle but is replacing a low emissions vehicle, then the resident shall be required to pay the residents' permit charge as specified in Schedule 13 according to the number of residents' permits issued to the household.
- f. in Article 33 the word "householder" is substituted with the word "resident".
- g. in Article 33(1) the word "household" is substituted with the word "resident".
- h. in Article 33 paragraph (3) is substituted with the following paragraph:
  - (3) On receipt of an application duly made under the foregoing provisions of this Article and upon receipt of the charge specified in Schedule 14, the Council upon being satisfied that the applicant is a resident, shall issue to the applicant the residents' visitors parking cards.
- i. in Article 33 there were added the following paragraph:
  - (4) The number of residents' visitor parking cards shall be restricted to a maximum of ten residents' visitor parking cards per household in any 12 month period.
- j. Schedule 13 of those Orders is substituted with Schedule 2 to this Order.

---

<sup>a</sup> 1990 c.8



Dated this twenty-ninth day of October 2018



Mark Frost  
Head of Traffic, Transport & Environmental Strategy  
(The officer appointed for this purpose)

### **Schedule 1**

The London Borough of Hounslow (Capital Interchange Way) (Parking Places) Order 2009  
The London Borough of Hounslow (Hounslow West) (Parking Places) (No.2) Order 2009  
The London Borough of Hounslow (East Chiswick) (Parking Places) (No.3) Order 2009  
The London Borough of Hounslow (Bedford Park) (Parking Places) (No.5) Order 2009  
The London Borough of Hounslow (East Chiswick 1) (Parking Places) (No.6) Order 2009  
The London Borough of Hounslow (Central Chiswick) (Parking Places) (No.7) Order 2009  
The London Borough of Hounslow (Chiswick Mall) (Parking Places) (No.9) Order 2009  
The London Borough of Hounslow (Osterley Station) (Parking Places) (No.10) Order 2009  
The London Borough of Hounslow (Brentford Station) (Parking Places) (No.12) Order 2009  
The London Borough of Hounslow (West Chiswick) (Parking Places) (No.13) Order 2009  
The London Borough of Hounslow (Hatton Green) (Parking Places) (No.14) Order 2009  
The London Borough of Hounslow (Spring Grove) (Parking Places) (No.15) Order 2009  
The London Borough of Hounslow (Gunnersbury Estate) (Parking Places) (No.16) Order 2009  
The London Borough of Hounslow (Chiswick Inner Core) (Parking Places) (No.17) Order 2009  
The London Borough of Hounslow (Hounslow Town Centre) (Parking Places) (No.18) Order 2009  
The London Borough of Hounslow (Stile Hall Area) (Parking Places) (No.19) Order 2009  
The London Borough of Hounslow (Feltham Inner Core) (Parking Places) (No.21) Order 2009  
The London Borough of Hounslow (The Butts) (Parking Places) (No.22) Order 2009  
The London Borough of Hounslow (North Feltham) (Parking Places) (No.24) Order 2009  
The London Borough of Hounslow (Brentford Exemplar) (Parking Places) (No.25) Order 2009  
The London Borough of Hounslow (Jersey Road) (Parking Places) (No.27) Order 2009  
The London Borough of Hounslow (Bedfont Lane) (Parking Places) (No.29) Order 2009  
The London Borough of Hounslow (Boston Manor) (Parking Places) (No.30) Order 2009  
The London Borough of Hounslow (Syon Lane) (Parking Places) (No. 1) Order 2010  
The London Borough of Hounslow (Mid Chiswick) (Parking Places) (No. 1) Order 2011  
The London Borough of Hounslow (London Road) (Parking Places) Order 2011  
The London Borough of Hounslow (South Street) (Parking Places) Order 2011  
The London Borough of Hounslow (Thornbury Road) (Parking Places) Order 2011  
The London Borough of Hounslow (Twickenham Road) (Parking Places) Order 2011  
The London Borough of Hounslow (Vicarage Farm Road) (Parking Places) Order 2011  
The London Borough of Hounslow (Hamilton Road) (Parking Places) Order 2012  
The London Borough of Hounslow (Brentford Inner Core) (Parking Places) Order 2013  
The London Borough of Hounslow (Bath Road) (Parking Places) Order 2013  
The London Borough of Hounslow (West Middlesex Hospital) (Parking Places) Order 2014  
The London Borough of Hounslow (Mill Way & River Gardens) (Parking Places) Order 2014  
The London Borough of Hounslow (Osborne Road) (Parking Places) Order 2014  
The London Borough of Hounslow (Brook Road South & Brenford FC Event Days) (Parking Places) Order 2015  
The London Borough of Hounslow (Islay Gardens) (Parking Places) Order 2015  
The London Borough of Hounslow (Tilley Road) (Parking Places) Order 2016

The London Borough of Hounslow (Wyke Estate) (Parking Places) Order 2016  
 The London Borough of Hounslow (Spencer Road) (Parking Places) Order 2017  
 The London Borough of Hounslow (Thornbury Avenue) (Parking Places) Order 2017  
 The London Borough of Hounslow (Haverfields Area) (Parking Places) Order 2017  
 The London Borough of Hounslow (Kings Road) (Parking Places) Order 2017  
 The London Borough of Hounslow (Brenford East) (Parking Places) Order 2017  
 The London Borough of Hounslow (Burlington Road, Isleworth) (Parking Places) Order 2017  
 The London Borough of Hounslow (Chiswick Riverside) (Parking Places) Order 2017  
 The London Borough of Hounslow (Brenford West) (Parking Places) Order 2018  
 The London Borough of Hounslow (Chiswick Riverside 2) (Parking Places) Order 2018

## Schedule 2

1.	2. First residents' permit per household	3. Second residents' permit per household	4. Third residents' permit per household	5. Fourth residents' permit per household	6. Fifth and subsequent residents' permits per household
12 month permit for a low emission vehicle.	£0	£0	£0	£0	£0
12 month permit for a low emission vehicle which is also a diesel vehicle.	£50	£50	£50	£50	£50
12 month permit for all other diesel vehicles	£130	£210	£290	£370	£450
12-month permit for all other vehicles	£80	£160	£240	£320	£400

### EXPLANATORY NOTE

(This Note is not part of the Order, but is intended to indicate its general purport.)

The London Borough of Hounslow Parking Places Orders designates parking places on streets in the London Borough of Hounslow at which charges may be made by the Council of the Borough for vehicles authorised by that Order to be left in those parking places during the permitted hours.

This Order amends those Parking Places Orders by amending the charges for low emission vehicles, diesel vehicles and households with multiple vehicles.

# Traffic Management Order

2019 No.28

---

The London Borough of Hounslow (Brook Road South & Brentford Stadium Event Day)  
(Parking Places) (Amendment No.4) Order 2019

Made on 15 July 2019

Coming into operation on 20 July 2019

---

The Council of the London Borough of Hounslow, having consulted the Commissioner of Police of the Metropolis, in exercise of the powers conferred by sections 45, 46, 49 and 51 and 124 of the Road Traffic Regulation Act 1984<sup>a</sup> as amended, and of all other powers thereunto enabling hereby make the following Order:

1. This Order may be cited as the London Borough of Hounslow (Brook Road South & Brentford Stadium Event Days) (Parking Places) (Amendment No.4) Order 2019 and shall come into operation for all purposes on 20 July 2019.
2. In this Order:  
  
“the Order of 2009” means the London Borough of Hounslow (Brook Road South & Brentford Stadium Event Day) (Parking Places) Order 2015<sup>b</sup>.
3. Without prejudice to the validity of anything done or to any liability incurred in respect of any act of omission before the coming into operation of this Order, the Order of 2015 shall have effect as though:
  - a) in Article 3(1) the definition of “parking space” is substituted with the following definition:  
  
“parking space” means a space in a parking place referred to in the Schedules to this Order which is provided for the leaving of vehicles;
  - b) in Articles 4(1), 6(2) and 7(1) the text “4A,” is inserted into the list of Schedules.
  - c) in Article 7(5) the words “Schedule 4” are substituted with the words “Schedule 4 and 4A”.
  - d) in Article 9(2) the words “Schedules 2, 3 and 4” are substituted with the words “Schedules 2, 3, 4 and 4A”.
  - e) in Articles 10(1), 16(1) and 17(1) the words “Schedules 1, 2, 3 and 4” are substituted with the words “Schedules 1, 2, 3, 4 and 4A”
  - f) Schedule 4 to that Order is replaced with Schedule 1 to this Order;
  - g) a Schedule 4A was added to that Order as detailed in Schedule 2 to this Order; and
  - h) Schedule 7 to that Order is replaced with Schedule 3 to this Order.

---

<sup>a</sup> 1984 c. 27

<sup>b</sup> LBH 2015/06

Dated this fifteenth day of July 2019



Mark Frost  
Head of Transport & Environmental Services  
(the officer appointed for the purpose)

### Schedule 1

Pay by phone & Business permit & Resident Permit Holders Mon-Fri 10am-12pm and 6pm-8pm  
and Saturdays on Brentford FC event days 2.30pm-3.30pm Max stay 30 minutes

1 No. of parking place	2 Designated parking place	3 Maximum number of parking bays	4 Special manner of standing
1.	Lateward Road, Brentford, the south-east side, from a point opposite a point 2.6 metres south-west of the boundary wall of Nos.25 and 26 Lateward Road to a point opposite the boundary wall of Nos.41 and 42 Lateward Road	-	-
2.	Lateward Road, Brentford, the south-east side, from a point opposite the boundary wall of Nos.42 and 43 Lateward Road to a point opposite the boundary wall of Nos.56 and 57 Lateward Road	-	-
3.	Lateward Road, Brentford, the north-east side, from a point opposite the boundary wall of Nos.63 and 63 Lateward Road to a point 3.7 metres south-east of the boundary wall of Nos.71 and 72 Lateward Road	-	-

### Schedule 2

Resident & Business Permit holders & Pay by phone Mon-Fri 10am-12pm and 6pm-8pm and  
Saturdays on Brentford FC event days 2.30pm-3.30pm - Max stay 1 hour

1 No. of parking place	2 Designated parking place	3 Maximum number of parking bays	4 Special manner of standing
---------------------------------	-------------------------------	--	---------------------------------------

4.	Albany Place, Brentford, the north-east side, from a point 5.2 metres south-east of the south-eastern kerb-line of Albany Road south-eastwards for a distance of 15.0 metres	-	-
5.	Albany Road, Brentford, the north-west side, from a point 1.8 metres north-east of the south-western building line of No.4 Market Terrace, Albany Road to a point 6.5 metres south-west of the south-western kerb-line of Ealing Road	-	-
6.	Albany Road, Brentford, the north-west side, from a point 2.9 metres south-west of the common boundary of No 1 Brook Road South and No.8 Market Terrace to a point 2.6 metres south-west of the north-eastern building line of No.5 Market Terrace, Albany Road	-	-
7.	Albany Road, Brentford, the north-west side, from a point 9.5 metres north-east of the north-easternmost building line of Nos 1-28 Berkeley House, Albany Road to a point 1.5 metres south-west of the south-western boundary of No.58 Albany Road	-	-
8.	Albany Road, Brentford, the north-west side, from a point 2.7 metres south-west of the north-easternmost building line of Nos 1-28 Berkeley House, Albany Road south-westwards for a distance of 21.0 metres	-	-
9.	Albany Road, Brentford, the south-east side, from a point 7.0 metres south-west of the south-western kerb-line of Ealing Road to a point 1.6 metres north-east of the party wall of Nos 3 and 4 Market Terrace, Albany Road	-	-
10.	Braemar Road, Brentford, the south-east side, from a point 7.3 metres north-east of the north-eastern building line of No.32 Braemar Road to a point 11.0 metres south-west of the south-western kerb-line of Ealing Road	-	-
11.	Brook Road South, Brentford, the north-east side, from a point 2 metres north-west of the common boundary of Nos. 46 & 48 Brook Road South to a point 1.5 metres north-west of the common boundary of Nos.52 and 54 Brook Road South	-	-
12.	Clifden Road, Brentford, the south-east side, from a point 12.0 metres north-east of the south-eastern kerb-line of Windmill Road to a point 5.2 metres south-west of the south-western building line of Parr Cottage, Clifden Road	-	-
13.	Hamilton Road, Brentford, the south-east side, from a point 3.5 metres south-west of the boundary wall of Nos.33 and 34 Hamilton Road to a point 0.5 metres north-west of the boundary wall of Nos.36 and 36A Hamilton Road	-	-

14.	Lateward Road, Brentford, the north-west side, from a point 0.5 metres south-west of the north-eastern building line of No.40 Brook Road South to a point 11.0 metres south-west of the north-eastern building line of No.40 Brook Road South	-	-
15.	Lateward Road, Brentford, the south-east side, from a point 0.7 metres south-west of the north-eastern building line of No.38 Brook Road South to a point 6.0 metres north-east of the north-eastern building line of Nos.3 to 6 Lateward Road	-	-
16.	New Road, Brentford, the north-west side, from a point 7.5 metres south-west of the south-western kerb-line of Ealing Road to the north-eastern building line of No.2 New Road	-	-
17.	New Road, Brentford, the north-west side, from a point opposite a point 1.5 metres north-east of the boundary wall of Nos.42 and 43 New Road to a point 7.0 metres north-east of the north-eastern kerb-line of Brook Lane North	-	-

### Schedule 3

Resident Permit Holders Mon-Fri 10am-12pm and 6pm-8pm and Saturdays on Brentford FC event days 2.30pm-3.30pm Except Christmas Day, Good Friday or a Bank Holiday

1 No. of parking place	2 Designated parking place	3 Maximum number of parking bays	4 Special manner of standing
18.	Albany Road, Brentford, the north-west side, from a point 1.7 metres north-east of the south-western building line of No.1 Brook Road South to a point 9.7 metres north east of the south-western building line of No.1 Brook Road South	-	-
19.	Albany Road, Brentford, the north-west side, from a point 4.5 metres north-east of the common boundary of Nos 30 and 32 Albany Road to a point 1.8 metres south-west of the north-eastern building line of No.2 Albany Road	-	-
20.	Albany Road, Brentford, the north-west side, from a point 3.6 metres south-west of the north-eastern building line of No.58 Albany Road to a point 1.0 metres south-west of the common boundary of Nos 32 and 32a Albany Road	-	-

21.	Albany Road, Brentford, the south-east side, from a point 7.7 metres south-west of the south-western kerb-line of Charlton House to a point 5.7 metres south-west of the south-western building line of No.1 Brook Road South	-	-
22.	Albany Road, Brentford, the south-east side, from a point 2.7 metres south-west of the north-eastern building line of No.2 Albany Road to a point 1.4 metres north-east of the common boundary of Nos 8 and 10 Albany Road	-	-
23.	Albany Road, Brentford, the south-east side, from a point 3.9 metres south-west of the south-western kerb-line of Wilkes Road to a point 3.8 metres north-east of the north-eastern kerb-line of Albany Place	-	-
24.	Albany Road, Brentford, the south-east side, from a point 5.0 metres south-west of the south-western kerb-line of Albany Place to a point 0.7 metres south-west of the common boundary of Nos 34 and 36 Albany Road	-	-
25.	Albany Road, Brentford, the south-east side, from the north-eastern building line of No.39 Albany Road to a point 0.6 metres south-west of the north-eastern building line of No.58 Albany Road	-	-
26.	Albany Road, Brentford, the south-east side, from a point 28.0 metres south-west of the north-eastern building line of No.58 Albany Road to a point 32.5 metres south-west of the north-eastern building line of No.58 Albany Road	-	-
27.	Albany Road, Brentford, the south-east side, from point 39.7 metres south-west of the north-eastern building line of No.58 Albany Road to a point 5.3 metres north-east of the north-easternmost building line of Nos 1-28 Berkeley House, Albany Road	-	-
28.	Braemar Road, Brentford, the north-west side, from a point 15.7 metres south-west of the south-western building line of No.36 Braemar Road to a point 11.0 metres south-west of the south-western kerb-line of Ealing Road	-	-
29.	Braemar Road, Brentford, the north-west side, from a point 2.0 metres south-west of the south-western building line of No.64 Braemar Road to a point 11.8 metres north-east of the north-eastern building line of No.46 Braemar Road	-	-
30.	Braemar Road, Brentford, the north-west side, from a point 3.0 metres north-east of the south-western building line of No.59 Brook Road South to a point 1.3 metres north-east of the north-eastern building line of No.59A Brook Road South	-	-

31.	Braemar Road, Brentford, the south-east side, from a point 1.0 metre north-east of the south-western building line of No.1 Braemar Road a point 0.3 metres north-east of the north-eastern building line of No.32 Braemar Road	-	-
32.	Braemar Road, Brentford, the south-east side, from a point 3 metres south-west of the north-eastern building line of 59 Brook Road South to a point 1.5 metres north-east of the south-western building line of 64 Braemar Road	-	-
33.	Brook Lane North, Brentford, the south-west side, from a point 11.1 metres south-east of the north-western building line of No.12 Brook Lane North to a point 2.7 metres north-west of the north-western building line of No.12 Brook Lane North	-	-
34.	Brook Lane North, Brentford, the south-west side, from a point 0.8 metres north-west of the south-eastern building line of No.2 Brook Lane North north-westwards for a distance of 14.4 metres	-	-
35.	Brook Lane North, Brentford, the south-west side, from a point 5.0 metres north-west of the north-western kerb-line of Hamilton Road north-westwards for a distance of 8.0 metres	-	-
36.	Brook Road South, Brentford, the north-east side, from a point opposite the boundary wall of Nos.110 and 112 Brook Road South to a point 3.6 metres south-east of the north-western building line of No.38 New Road	-	-
37.	Brook Road South, Brentford, the north-east side, from a point 6.0 metres north-west of the south-eastern building line of Nos.25 to 48 Braemar Court, Brook Road South to a point 1.8 metres north-west of the north-western building line of Nos.25 to 48 Braemar Court, Brook Road South	-	-
38.	Brook Road South, Brentford, the north-east side, from a point 2.4 metres north-west of the south-eastern building line of Nos.1 to 24 Brook Court, Brook Road South to a point 7.3 metres south-east of the north-western building line of Nos.1 to 24 Brook Court, Brook Road South	-	-
39.	Brook Road South, Brentford, the north-east side, from a point 2.0 metres north-west of the south-eastern building line of No.59 Brook Road South to a point 1.0 metre south-east of the north-western building line of No.79 Brook Road South	-	-



40.	Brook Road South, Brentford, the north-east side, from a point 4.0 metres north-west of the south-eastern building line of No.45 Brook Road South to a point 1 metre north-west of the common boundary of Nos 44 & 46 Brook Road South	-	-
41.	Brook Road South, Brentford, the north-east side, from a point 2.8 metres north-west of the south-eastern building line of No.1 Brook Road South to a point 3.8 metres south-east of the north-western building line of No.43 Brook Road South	-	-
42.	Brook Road South, Brentford, the south-west side, from a point 1.5 metres north-west of the common boundary of Nos.110 and 112 Brook Road South to a point opposite a point 3.0 metres south-east of the north-western building line of No,38 New Road	-	-
43.	Brook Road South, Brentford, the south-west side, from a point 4.3 metres north-west of the common boundary of Nos.106 and 108 Brook Road South to a point 4.2 metres south-east of the common boundary of Nos.110 and 112 Brook Road	-	-
44.	Brook Road South, Brentford, the south-west side, from a point 5.0 metres north-west of the north-western kerb-line Clifden Road to a point 1.4 metres south-east of the boundary line of Nos.106 and 108 Brook Road South	-	-
45.	Brook Road South, Brentford, the south-west side, from a point 1.0 metre south-east of the boundary wall of Nos.62 and 64 Brook Road South to a point 1.5 metres south-east of the north-western building line of No.96 Brook Road South	-	-
46.	Brook Road South, Brentford, the south-west side, from a point 2.0 metres north-west of the south-eastern building line of No.40 Brook Road South to a point 2.0 metres north-west of the boundary wall of Nos.54 and 56 Brook Road South	-	-
47.	Brook Road South, Brentford, the south-west side, from a point 1.6 metres north-west of the south-eastern building line of No.22 Brook Road South to a point 2.4 metres south-east of the north-west building line of No.38 Brook Road South	-	-
48.	Brook Road South, Brentford, the south-west side, from the south-eastern building line of No.14 Brook Road South to a point 5.8 metres south-east of the south-eastern building line of No.22 Brook Road South	-	-

49.	Brook Road South, Brentford, the south-west side, from a point 1.8 metres north-west of the south-eastern building line of No.2 Albany Road to a point 4.0 metres south-east of the south-eastern kerb-line of Grosvenor Road	-	-
50.	Grosvenor Road, Brentford, the north-west side, from a point 5.0 metres south-west of the south-western kerb-line of Brook Road South south-westwards for a distance of 9.0 metres	-	-
50.	Clifden Road, Brentford, the north-west side, from a point 3.3 metres south-west of the south-western building line of No.98 Brook Road South to a point 6.0 metres south-west of the south-western kerb-line of Brook Road South	-	-
51.	Clifden Road, Brentford, the north-west side, from a point 2.5 metres north-east of the north-eastern building line of No.47 Clifden Road to a point 2.5 metres north-east of the south-western building line of No.53 Clifden Road	-	-
52.	Clifden Road, Brentford, the north-west side, from the boundary wall of Nos.33 and 35 Clifden Road to a point 0.7 metres south-west of the boundary wall of Nos.45 and 47 Clifden Road	-	-
53.	Clifden Road, Brentford, the north-west side, from the south-western building line of No 29 Clifden Road to a point 4.5 metres north-east of the boundary wall of Nos. 29 and 31 Clifden Road	-	-
54.	Clifden Road, Brentford, the north-west side, from a point 4.0 metres south-west of the boundary wall of Nos.25 and 27 Clifden Road to a point 4.0 metres north-east of the boundary wall of Nos.25 and 27 Clifden Road	-	-
55.	Clifden Road, Brentford, the north-west side, from a point 0.7 metres south-west of the boundary wall of Nos.21 and 23 Clifden Road to a point 4.8 metres north-east of the boundary wall of Nos.21 and 23 Clifden Road	-	-
56.	Clifden Road, Brentford, the north-west side, from a point 0.5 metres south-west of the boundary wall of Nos.5 and 7 Clifden Road to a point opposite the boundary wall of Nos.14 and 16 Clifden Road	-	-
57.	Clifden Road, Brentford, the north-west side, from a point 0.7 metres south-west of the south-western building line of No.1 Clifden Road to a point 0.6 metres north-east of the boundary wall of Nos.1 and 3 Clifden Road	-	-

58.	Clifden Road, Brentford, the north-west side, from a point 13.3 metres north-east of the north-eastern building line of No.12 Clifden House, Clifden Road to a point 6.8 metres south-west of the south-western building line of No.1 Clifden Road	-	-
59.	Clifden Road, Brentford, the north-west side, from a point 12.0 metres north-east of the south-eastern kerb-line of Windmill Road to a point 1.0 metre north-east of the north-eastern building line of No.12 Clifden House, Clifden Road	-	-
60.	Clifden Road, Brentford, the south-east side, from a point 2.6 metres south-west of the boundary wall of Nos.46 and 48 Clifden Road to a point 2.5 metres south-west of north-eastern building line of No.96 Brook Road South	-	-
61.	Clifden Road, Brentford, the south-east side, from a point 0.5 metres north-east of the south-western building line of No.38 Clifden Road to a point 1.4 metres south-west of the boundary wall of Nos.44 and 46 Clifden Road	-	-
62.	Clifden Road, Brentford, the south-east side, from the north-eastern building line of No.16 Clifden Road to a point 1.9 metres south-east of the north-western building line of No.36A Clifden Road	-	-
63.	Clifden Road, Brentford, the south-east side, from a point 1.2 metres north-east of the south-western building line of Parr Cottage, Clifden Road to a point 0.6 metres north-east of the boundary wall of Nos.14 and 16 Clifden Road	-	-
64.	Ealing Road, Brentford, the south-west side, from the south-eastern building line of No.143 Ealing Road to a point 2.0 metres north-west of the boundary wall of Nos.151 and 153 Ealing Road	-	-
65.	Ealing Road, Brentford, the south-west side, from the boundary wall of Nos.107 and 109 Ealing Road to a point 2.5 metres south-east of the north-western building line of No.129 Ealing Road	-	-
66.	Ealing Road, Brentford, the south-west side, from a point 3.3 metres north-west of the south-eastern building line of No.37 Ealing Road to a point 2.3 metres north-west of the boundary wall of Nos.83 and 85 Ealing Road	-	-
67.	Ealing Road, Brentford, the south-west side, service road fronting Nos.48 to 64 Ealing Road, from a point 1.2 metres south-east of the boundary wall of Nos.48 and 50 Ealing Road to a point 1.6 metres north-west of the north-western building line of No.62 Ealing Road	-	2 wheels on the footway

68.	Ealing Road, Brentford, the north-east side, the service road fronting Nos.48 to 64 Ealing Road, from a point 10.0 metres south-east of the north-eastern kerb-line of Ealing Road to a point 0.4 metres north-west of the south-eastern building line of No.64 Ealing Road	-	-
69.	Ealing Road, Brentford, the north-east side, service road fronting Nos.48 to 64 Ealing Road, from the boundary wall of Nos.48 and 50 Ealing Road to a point 12.0 metres east of the north-eastern kerb-line of Ealing Road	-	-
71.	Grosvenor Road, Brentford, the north-west side, from a point 4.4 metres north-east of the boundary wall of No.1 Grosvenor Road and No.14 Brook Road South to the south-western building line of No.22 Grosvenor Road	-	-
72.	Grosvenor Road, Brentford, the south-east side, from a point 4.5 metres south-west of the south-western kerb-line of Brook Road South to the boundary wall of Nos. 23 and 24 Grosvenor Road	-	-
73.	Hamilton Road, Brentford, the north-west side, from a point 4.6 metres north-east of the north-eastern kerb-line of Hamilton Road to a point 3.0 metres south-west of the north-eastern building line of No.37 Hamilton Road	-	-
74.	Hamilton Road, Brentford, the north-west side, from a point 1.5 metres south-west of the south-western building line of No.71 Hamilton Road to the boundary wall of Nos.48 and 49 Hamilton Road	-	-
75.	Hamilton Road, Brentford, the north-west side, from a point 8.8 metres north-east of the north-eastern kerb-line of Windmill Road north-eastwards for a distance of 5.0 metres	-	-
76.	Hamilton Road, Brentford, the south-east side, from a point 3.2 metres south-west of the boundary wall of Nos.17 and 18 Hamilton Road to a point 3.5 metres south-west of the boundary wall of Nos.33 and 34 Hamilton Road	-	-
77.	Hamilton Road, Brentford, the south-east side, from a point 4.5 metres north-east of the boundary wall of Nos.11 and 12 Hamilton Road to a point 1.9 metres south-west of the north-eastern building line of No.16 Hamilton Road	-	-
78.	Hamilton Road, Brentford, the south-east side, from a point 0.5 metres north-east of the south-western building line of No.1 Hamilton Road to a point 1.5 metres south-west of the boundary wall of Nos.11 and 12 Hamilton Road	-	-

79.	Lateward Road, Brentford, the north-west side, from a point opposite a point 3.0 metres south-west of the north-eastern building line of Nos.3 to 6 Lateward Road to a point 1.5 metres north-east of the south-western building line of No.22 Lateward Road	-	-
80.	Lateward Road, Brentford, the north-west side, from a point 1.3 metres south-west of the north-eastern building line of No.23 Lateward Road to the boundary wall of Nos.41 and 42 Lateward Road	-	-
81.	Lateward Road, Brentford, the north-west side, from the boundary wall of Nos.42 and 43 Lateward Road to the boundary wall of Nos.58 and 59 Lateward Road	-	-
82.	Lateward Road, Brentford, the south-west side, from a point 1.5 metres north-west of the boundary wall of Nos.60 and 61 Lateward Road to a point 1.5 metres north-west of the south-eastern building line of No.72 Lateward Road	-	-
83.	Lateward Road, Brentford, the south-east side, from a point 2.0 metres south-west of the north-eastern building line of Nos. 3 to 6 Lateward Road to a point opposite the boundary wall of Nos.24 and 25 Lateward Road	-	-
84.	Mafeking Avenue, Brentford, the north-east side, from a point 2.2 metres north-west of the south-eastern building line of No.4 Market Terrace, Albany Road to a point 1.2 metres north-west of the boundary wall of Nos.37 and 39 Mafeking Avenue	-	-
85.	Mafeking Avenue, Brentford, the north-west side, from a point 0.5 metres south-west of the boundary wall of Nos.49 and 51 Mafeking Avenue to a point 1.1 metres south-west of the boundary wall of Nos.71 and 73 Mafeking Avenue	-	-
86.	Mafeking Avenue, Brentford, the north-west side, from a point 1.0 metre south-west of the north-eastern building line of No.45 Brook Road South to a point 0.6 metres north-east of the south-western building line of No.45 Brook Road South	-	-
87.	Mafeking Avenue, Brentford, the south-west side, from a point 1.5 metres north-west of the south-eastern building line of No.5 Market Terrace, Albany Road to the boundary wall of Nos.34 and 36 Mafeking Avenue	-	-
88.	Mafeking Avenue, Brentford, the south-east side, from a point opposite the boundary wall of Nos.53 and 55 Mafeking Avenue to a point 0.3 metres north-east of the south-western building line of No.43 Brook Road South	-	-

89.	New Road, Brentford, the north-west side, from the north-eastern building line of No.2 New Road to a point 1.3 metres north-east of the south-western building line of No.7 New Road	-	-
90.	New Road, Brentford, the north-west side, from a point 0.5 metres south-west of the north-eastern building line of No.8 New Road to a point 1.2 metres north-east of the south-western building line of No.19 New Road	-	-
91.	New Road, Brentford, the north-west side, from the north-eastern building line of No.20 New Road to a point 1.4 metres north-east of the south-western building line of No.24 New Road	-	-
92.	New Road, Brentford, the north-west side, from a point 2.1 metres north-east of the boundary wall of Nos.25 and 26 New Road to a point 1.4 metres north-east of the south-western building line of No.26 New Road	-	-
93.	New Road, Brentford, the north-west side, from the north-eastern building line of No.27 New Road to a point opposite a point 1.4 metres north-east of the boundary wall of Nos.44 and 45 New Road	-	-
94.	Pump Alley, Brentford, the north-east side, from a point 5.0 metres north-west of the north-western building line of No.1 Pump Alley to a point 4.6 metres north-west of the south-eastern building line of No.4 Pump Alley	-	-
95.	Westbury Place, Brentford, the north-east side, from a point 4.5 metres north-west of the north-western kerb-line of Hamilton Road to a point 6.0 metres south-east of the south-eastern building line of No.1 Westbury Place	-	2 wheels on the footway
96.	Westbury Place, Brentford, the north-east side, from a point 1.0 metres south-east of the south-eastern building line of No.1 Westbury Place to a point 1.0 metres north-west of the boundary wall of Nos.11 and 13 Westbury Place	-	2 wheels on the footway
97.	Westbury Place, Brentford, the south-west side, from a point 4.5 metres north-west of the north-western kerb-line of Hamilton Road to a point 6.3 metres south-east of the south-eastern building line of No.2 Westbury Place	-	2 wheels on the footway
98.	Westbury Place, Brentford, the south-west side, from a point 1.0 metres south-east of the south-eastern building line of No.2 Westbury Place to a point 2.1 metres north-west of the boundary wall of Nos.12 and 14 Westbury Place	-	2 wheels on the footway

99.	Wilkes Road, Brentford, the north-east side, from a point 5.0 metres north-west of the north-western building line of Nos 37-45 Watermans Court to a point 18.0 metres north-west of the north-western kerb-line of High Street	-	-
100.	Wilkes Road, Brentford, the north-east side, from a point 6.0 meters south-east of the south-eastern kerb-line of Albany Road to a point 3.7 metres south-east of the north-western building line of No.3 Wilkes Road	-	-

---

### **EXPLANATORY NOTE**

(This Note is not part of the Order, but is intended to indicate its general purport.)

The Hounslow (Brook Road South & Brentford Stadium Event Day) (Parking Places) Order 2015 designates parking places in streets in the vicinity of Brook Road South in the London Borough of Hounslow at which charges may be made by the Council of the Borough for vehicles authorised by that Order to be left in those parking places during the permitted hours.

This Order updates the descriptions of the parking places to correct anomalies within the Order as amended.