

### **Appendix 8 – Proposed micromobility locations within the Heston East Ward**

For the Heston East ward, there are a total of 7 micromobility locations proposed. All bays are proposed on the carriageway unless otherwise identified in the location description.

<b>Street Name</b>	<b>Location Description</b>	<b>Length of Bay</b>
<a href="#"><u>Alderney Avenue, adjacent to No. 65 Heston Road</u></a>	Section of unrestricted carriageway on the north side of Alderney Avenue, west of the junction with Heston Road	7 metres (of unrestricted carriageway)
<a href="#"><u>Channel Close, adjacent to No. 42 Sutton Road</u></a>	Section of unrestricted carriageway on the east side of Channel Close, south of the junction with Sutton Road	6 metres (of unrestricted carriageway)
<a href="#"><u>Crosslands Avenue, adjacent to No. 3 Crosslands Parade</u></a>	Section of unrestricted footway on the west side of Crosslands Avenue, north of the junction with Fern Lane	5 metres (of footway)
<a href="#"><u>Lampton Road, adjacent to Nos. 1-22 Kestrel Court</u></a>	Section of unrestricted footway on the west side of Lampton Road, south of the junction with Lampton Avenue	7 metres (of footway)
<a href="#"><u>Sutton Hall Road, adjacent to No. 61 Upper Sutton Lane</u></a>	Section of unrestricted carriageway on the north side of Sutton Hall Road, east of the junction with Upper Sutton Lane	7 metres (of unrestricted carriageway)
<a href="#"><u>Walnut Tree Road, adjacent to No. 9 New Heston Road</u></a>	Section of unrestricted carriageway on the east side of Walnut Tree Road, north of the junction with New Heston Road	7 metres (of unrestricted carriageway)
<a href="#"><u>Winchester Avenue, adjacent to Nos. 1-16 The Gables</u></a>	Section of unrestricted carriageway on the south side of Winchester Avenue, west of the junction with Heston Road	6 metres (of unrestricted carriageway)

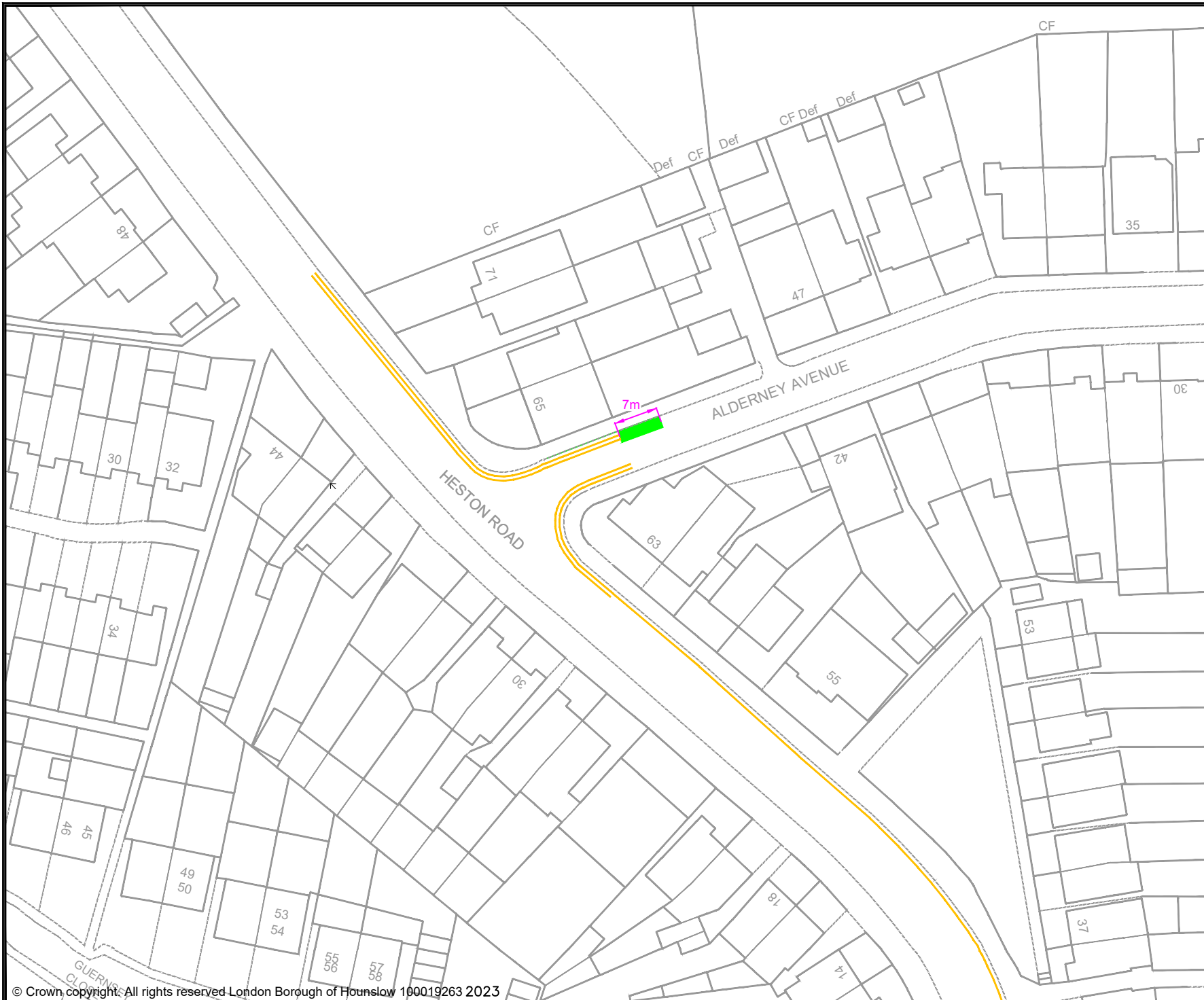

- KEY**
- MICRO-MOBILITY BAY
  - EXISTING PERMIT HOLDERS BAY
  - EXISTING PERMIT HOLDERS / 'PAY TO PARK' BAY
  - EXISTING 'PAY TO PARK' BAY
  - EXISTING BLUE BADGE HOLDER BAY
  - EXISTING ELECTRIC VEHICLE CHARGING OR CAR CLUB BAY
  - EXISTING LOADING ONLY BAY
  - EXISTING MOTOR - CYCLE ONLY BAY
  - EXISTING DOUBLE YELLOW LINES
  - EXISTING SINGLE YELLOW LINE
  - EXISTING RED ROUTE RESTRICTION

Rev	Date	Description

Jefferson Nwokeoma  
 Assistant Director of Traffic, Transport & Parking  
 Hounslow House, 7 Bath Road,  
 Hounslow, TW3 3EB

**Client**

**Project**

PROPOSED MICRO-MOBILITY  
 PARKING BAY

**Drawing Title**

ALDERNEY AVENUE, HESTON

**Drawing Status**

PROPOSED

Drawn	Approved	Date	Scale	Size
BJ	AH	JULY-2023	1:500	A4

Dwg No	Rev

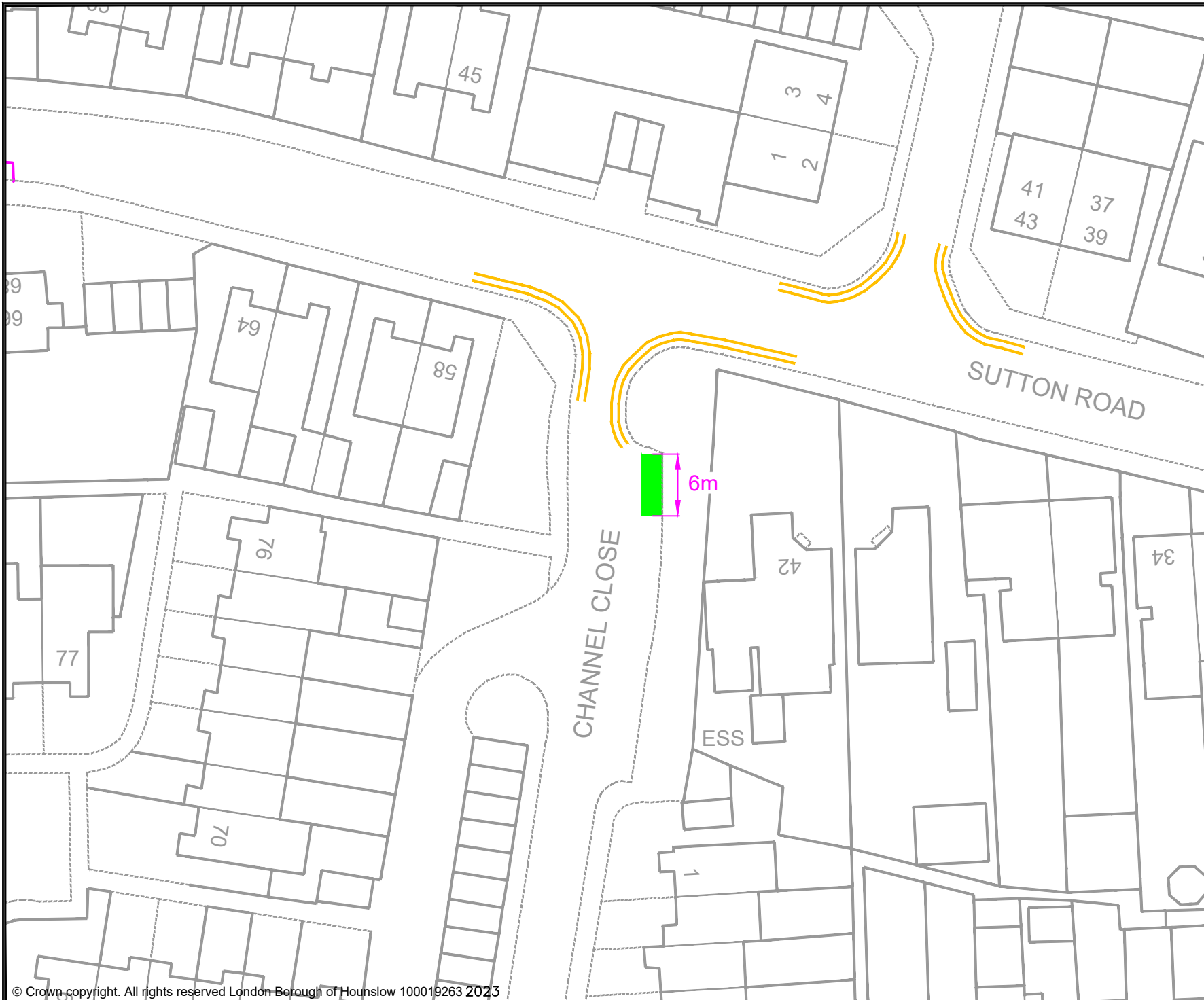

- KEY**
- MICRO-MOBILITY BAY
  - EXISTING PERMIT HOLDERS BAY
  - EXISTING PERMIT HOLDERS / 'PAY TO PARK' BAY
  - EXISTING 'PAY TO PARK' BAY
  - EXISTING BLUE BADGE HOLDER BAY
  - EXISTING ELECTRIC VEHICLE CHARGING OR CAR CLUB BAY
  - EXISTING LOADING ONLY BAY
  - EXISTING MOTOR - CYCLE ONLY BAY
  - EXISTING DOUBLE YELLOW LINES
  - EXISTING SINGLE YELLOW LINE
  - EXISTING RED ROUTE RESTRICTION

Rev	Date	Description

Jefferson Nwokeoma  
 Assistant Director of Traffic, Transport & Parking  
 Hounslow House, 7 Bath Road,  
 Hounslow, TW3 3EB

Client

Project  
 PROPOSED MICRO-MOBILITY PARKING BAY

Drawing Title  
 CHANNEL CLOSE, HESTON

Drawing Status  
 PROPOSED

Drawn	Approved	Date	Scale	Size
BJ	AH	JULY-2023	1:500	A4

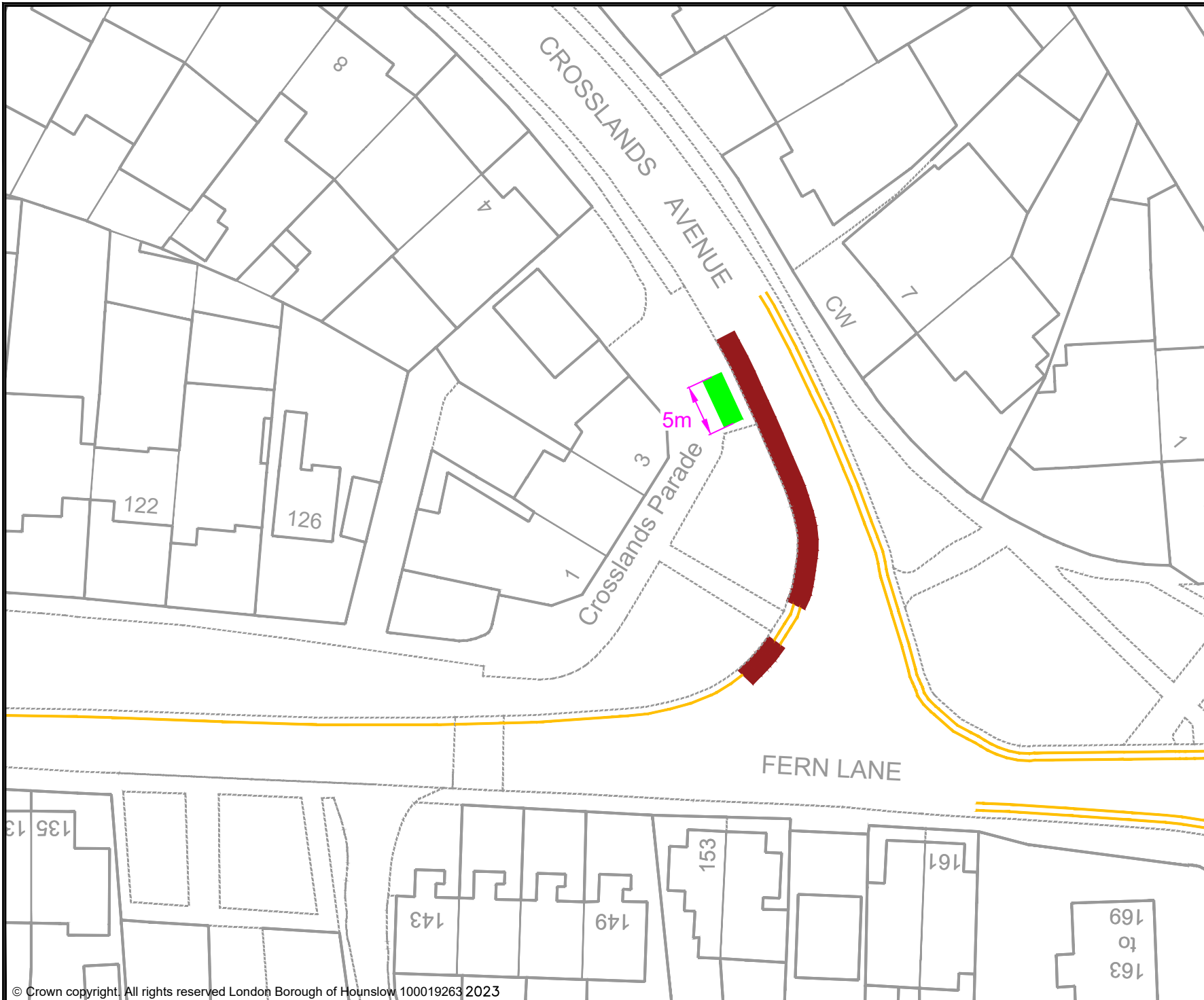

Dwg No	Rev



- KEY**
-  MICRO-MOBILITY BAY
  -  EXISTING PERMIT HOLDERS BAY
  -  EXISTING PERMIT HOLDERS / 'PAY TO PARK' BAY
  -  EXISTING 'PAY TO PARK' BAY
  -  EXISTING BLUE BADGE HOLDER BAY
  -  EXISTING ELECTRIC VEHICLE CHARGING OR CAR CLUB BAY
  -  EXISTING LOADING ONLY BAY
  -  EXISTING MOTOR - CYCLE ONLY BAY
  -  EXISTING DOUBLE YELLOW LINES
  -  EXISTING SINGLE YELLOW LINE
  -  EXISTING RED ROUTE RESTRICTION

Rev	Date	Description

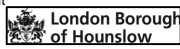
Jefferson Nwokeoma  
 Assistant Director of Traffic, Transport & Parking  
 Hounslow House, 7 Bath Road,  
 Hounslow, TW3 3EB

Client  

Project  
 PROPOSED MICRO-MOBILITY PARKING BAY

Drawing Title  
 CROSSLANDS AVENUE, HESTON

Drawing Status  
 PROPOSED

Drawn	Approved	Date	Scale	Size
BJ	AH	JULY-2023	1:500	A4

Dwg No	Rev
-	-

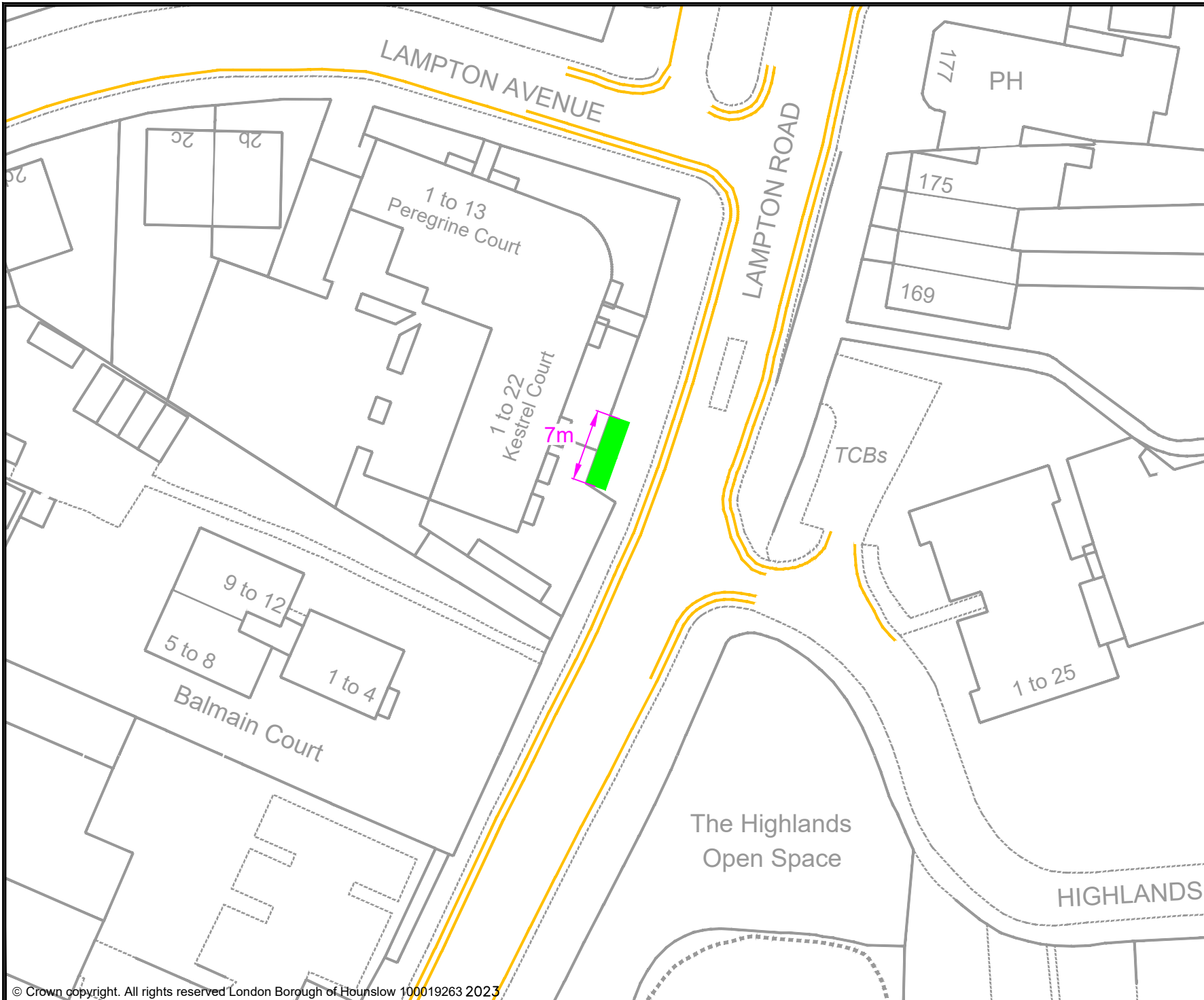

- KEY
- MICRO-MOBILITY BAY
  - EXISTING PERMIT HOLDERS BAY
  - EXISTING PERMIT HOLDERS / 'PAY TO PARK' BAY
  - EXISTING 'PAY TO PARK' BAY
  - EXISTING BLUE BADGE HOLDER BAY
  - EXISTING ELECTRIC VEHICLE CHARGING OR CAR CLUB BAY
  - EXISTING LOADING ONLY BAY
  - EXISTING MOTOR - CYCLE ONLY BAY
  - EXISTING DOUBLE YELLOW LINES
  - EXISTING SINGLE YELLOW LINE
  - EXISTING RED ROUTE RESTRICTION

Rev	Date	Description

Jefferson Nwokeoma  
 Assistant Director of Traffic, Transport & Parking  
 Hounslow House, 7 Bath Road,  
 Hounslow, TW3 3EB

Client

Project  
 PROPOSED MICRO-MOBILITY PARKING BAY

Drawing Title  
 LAMPTON ROAD, HESTON

Drawing Status  
 PROPOSED

Drawn	Approved	Date	Scale	Size
BJ	AH	JULY-2023	1:500	A4

Dwg No	Rev

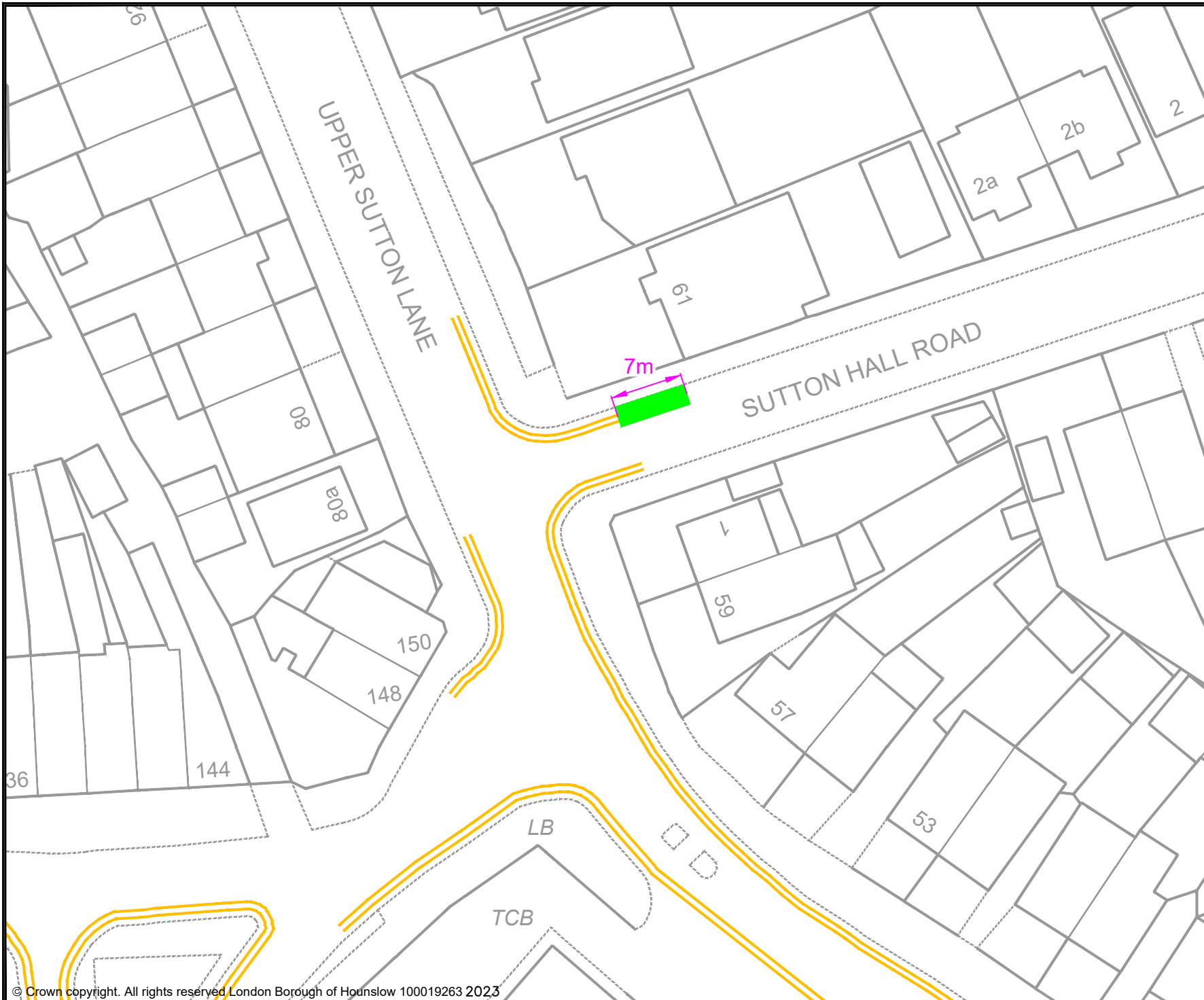

- KEY
- MICRO-MOBILITY BAY
  - EXISTING PERMIT HOLDERS BAY
  - EXISTING PERMIT HOLDERS / 'PAY TO PARK' BAY
  - EXISTING 'PAY TO PARK' BAY
  - EXISTING BLUE BADGE HOLDER BAY
  - EXISTING ELECTRIC VEHICLE CHARGING OR CAR CLUB BAY
  - EXISTING LOADING ONLY BAY
  - EXISTING MOTOR - CYCLE ONLY BAY
  - EXISTING DOUBLE YELLOW LINES
  - EXISTING SINGLE YELLOW LINE
  - EXISTING RED ROUTE RESTRICTION

Rev	Date	Description

Jefferson Nwokeoma  
 Assistant Director of Traffic, Transport & Parking  
 Hounslow House, 7 Bath Road,  
 Hounslow, TW3 3EB

Client

Project  
 PROPOSED MICRO-MOBILITY PARKING BAY

Drawing Title  
 SUTTON HALL ROAD, HESTON

Drawing Status  
 PROPOSED

Drawn	Approved	Date	Scale	Size
BJ	AH	JULY-2023	1:500	A4

Dwg No	Rev

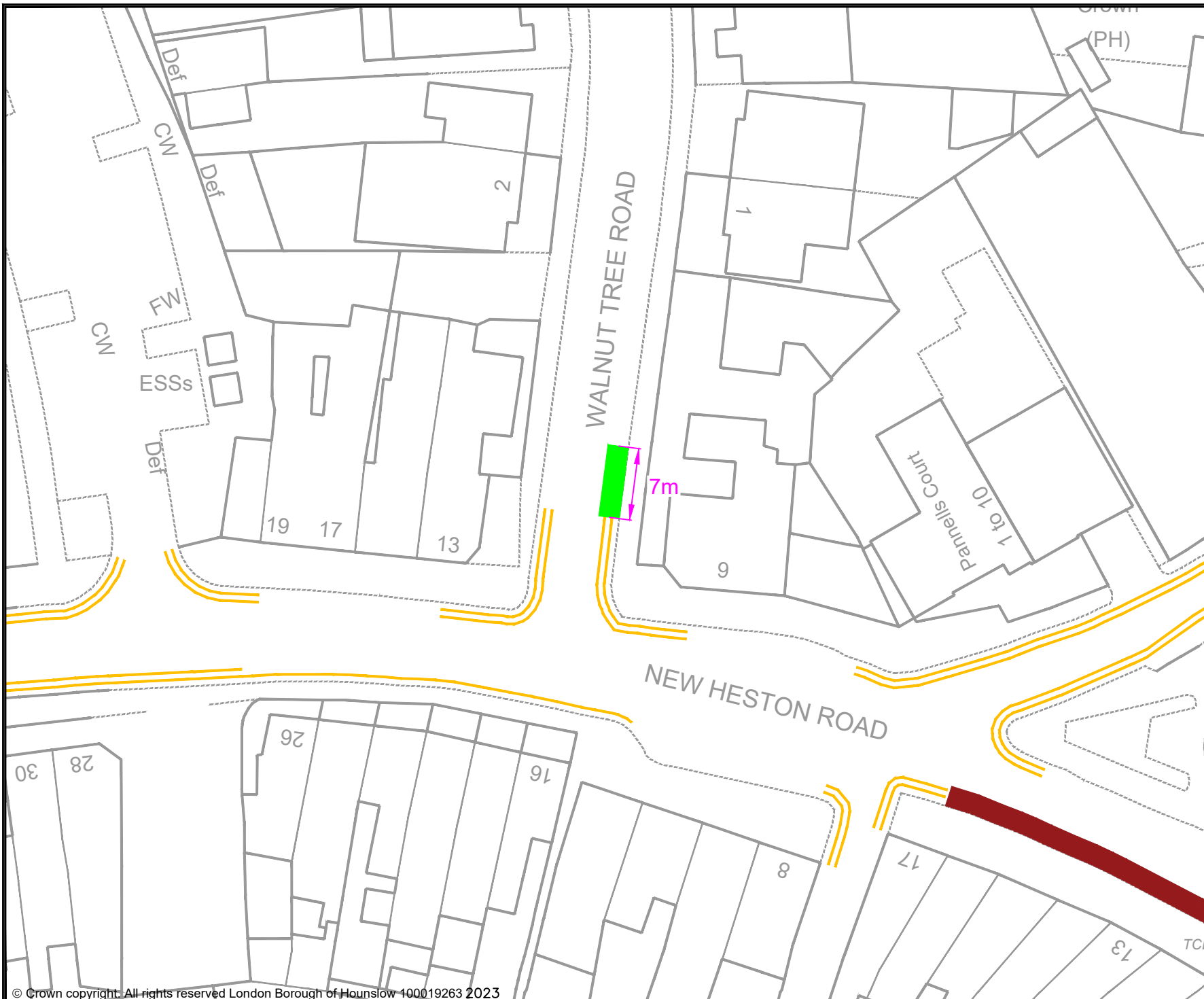

- KEY**
- MICRO-MOBILITY BAY
  - EXISTING PERMIT HOLDERS BAY
  - EXISTING PERMIT HOLDERS / 'PAY TO PARK' BAY
  - EXISTING 'PAY TO PARK' BAY
  - EXISTING BLUE BADGE HOLDER BAY
  - EXISTING ELECTRIC VEHICLE CHARGING OR CAR CLUB BAY
  - EXISTING LOADING ONLY BAY
  - EXISTING MOTOR - CYCLE ONLY BAY
  - EXISTING DOUBLE YELLOW LINES
  - EXISTING SINGLE YELLOW LINE
  - EXISTING RED ROUTE RESTRICTION

Rev	Date	Description

Jefferson Nwokeoma  
 Assistant Director of Traffic, Transport & Parking  
 Hounslow House, 7 Bath Road,  
 Hounslow, TW3 3EB

Client 	
------------	--

Project  
 PROPOSED MICRO-MOBILITY PARKING BAY

Drawing Title  
 WALNUT TREE ROAD, HESTON

Drawing Status  
 PROPOSED

Drawn	Approved	Date	Scale	Size
BJ	AH	JULY-2023	1:500	A4

Dwg No	Rev

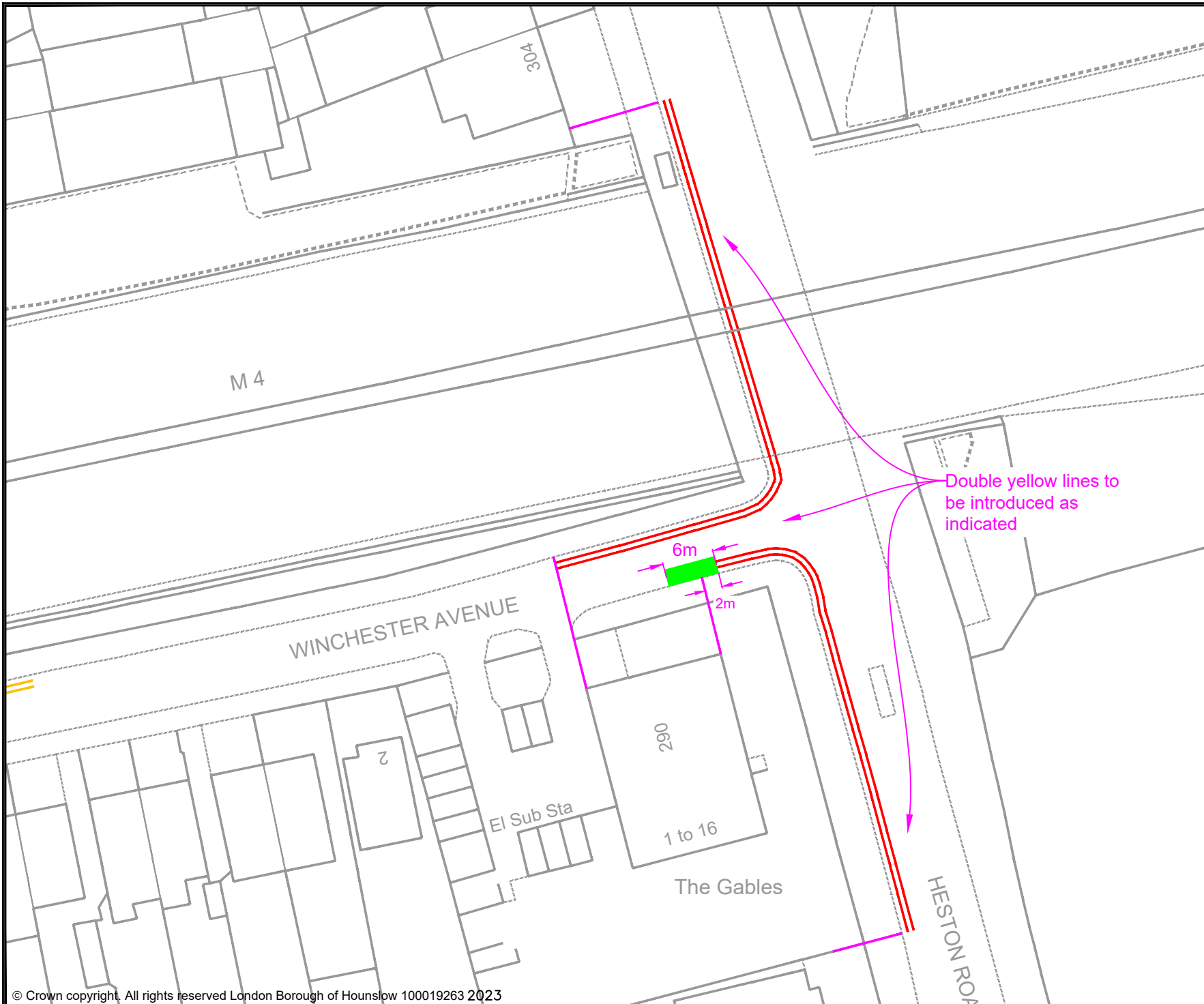

- KEY**
- MICRO-MOBILITY BAY
  - PROPOSED DOUBLE YELLOW LINES
  - EXISTING PERMIT HOLDERS BAY
  - EXISTING PERMIT HOLDERS / 'PAY TO PARK' BAY
  - EXISTING 'PAY TO PARK' BAY
  - EXISTING BLUE BADGE HOLDER BAY
  - EXISTING ELECTRIC VEHICLE CHARGING OR CAR CLUB BAY
  - EXISTING LOADING ONLY BAY
  - EXISTING MOTOR - CYCLE ONLY BAY
  - EXISTING DOUBLE YELLOW LINES
  - EXISTING SINGLE YELLOW LINE
  - EXISTING RED ROUTE RESTRICTION

Rev	Date	Description
-	-	-
Jefferson Nwokeoma Assistant Director of Traffic, Transport & Parking Hounslow House, 7 Bath Road, Hounslow, TW3 3EB		
Client 		
Project <b>PROPOSED MICRO-MOBILITY PARKING BAY</b>		
Drawing Title <b>WINCHESTER AVENUE, HESTON</b>		
Drawing Status <b>PROPOSED</b>		
Drawn BJ	Approved AH	Date JULY-2023
		Scale 1:600
		Size A4
Dwg No		Rev
-		-