



London Borough of Hounslow

Deposited Documents – Reference TMO/P024/23

Held on deposit online - https://www.hounslow.gov.uk/downloads/20165/traffic_notices

Placed on deposit on Friday, 2 June 2023

End of Consultation period is Friday, 23 June 2023

School Street – Heath Road, Hounslow

Contents:

1. **Notice of Intent dated 2 June 2023**
2. **Proposed Traffic Management Order**
 - A. The London Borough of Hounslow (School Streets) (Amendment No.***) Order 20**
3. **Statement of Reasons**
4. **Plan**
5. **Existing Traffic Management Orders**
 - A. The London Borough of Hounslow (School Streets) Order 2021 [2021/56]

Any queries regarding these deposited documents should be sent by email to trafficorders@hounslow.gov.uk or alternatively a voicemail can be left on extension 3322.

School Street – Heath Road, Hounslow

A. The London Borough of Hounslow (School Streets) (Amendment No.*) Order 20****

1. The London Borough of Hounslow proposes to make the above Order under the Road Traffic Regulation Act 1984.
2. The general effect of the School Streets Order would be to prohibit motor vehicles from using the section of Heath Road, between No.72 Heath Road and its junction with Atcham Road between the hours of 8.15am and 9.15am, and 2.45pm and 3.45pm, Mondays to Fridays during school term time. Exemptions would apply for emergency services vehicles, residents who live within the zone, visitors to residents within the zone, Blue Badge holders, delivery vehicles, and school staff.
3. Documents giving further information of the proposed Orders can be viewed for a period of 21 days from the date of this Notice online at hounslow.gov.uk by typing in the term “traffic notices” in the search bar.
4. Any person wishing to object to the proposed Orders should send a statement in writing, stating the grounds of the objection, to the Assistant Director of Traffic, Transport & Parking, Hounslow Council, Hounslow House, 7 Bath Road, Hounslow, Middlesex TW3 3EB or by email to trafficorders@hounslow.gov.uk quoting the reference TMO/P024/23, to be received by no later than Friday, 23 June 2023.

Dated 2 June 2023

Jefferson Nwokeoma
Assistant Director Traffic, & Transport & Parking

Traffic Management Order

20** No.**

The London Borough of Hounslow (School Streets) (Amendment No.**) Order 20**

Made on ** ***** 20**

Coming into operation on ** ***** 20**

The Council of the London Borough of Hounslow, after consulting the Commissioner of Police of the Metropolis, in exercise of the powers conferred by sections 6 and 124 to the Road Traffic Regulation Act 1984¹ as amended, and of all other enabling powers hereby make the following Order:

- 1 This Order shall come into operation on ** ***** 20** and may be cited as the London Borough of Hounslow (School Streets) (Amendment No.**) Order 20**.
- 2 Without prejudice to the validity of anything done or to any liability incurred in respect of any act or omission before the coming into operation of this Order, The London Borough of Hounslow (School Streets) Order 2021² shall have effect as though the items numbered ** and ** in the Schedule to this Order were added to Schedule 1 to that Order.

Dated this ***** day of ***** 20**

Assistant Director for Traffic, Transport & Parking
(the officer appointed for the purpose)

¹ 1984 c.27

² 2021/56

Schedule

| 1 Item Number | 2 Description | 3 Prohibited hours |
|---------------------|--|--|
| ** | Heath Road, Hounslow, between No.72 Heath Road and its junction with Atcham Road | Between 8.15am and 9.15am, and between 2.45pm and 3.45pm |
| ** | The unnamed road between Heath Road and Central Avenue to the west of No.65 Heath Road and No.22a Central Avenue | Between 8.15am and 9.15am, and between 2.45pm and 3.45pm |

EXPLANATORY NOTE

(This Note is not part of the Order, but is intended to indicate its general purport.)

This Order further amends the London Borough of Hounslow (School Streets) Order 2021 by introducing an additional school street in Heath Road, Hounslow.

Statement of Reasons

Heath Road, Hounslow - Access Restriction

The council is consulting on proposals to introduce an access restriction on motor vehicles accessing a section of Heath Road, Hounslow, between No.64 to its junction with Atcham Road during school start and finish times (Monday – Friday, 8.15 - 9.15am and 2.45 - 3.45pm) as part of its School Streets Programme.





Exemptions will be introduced for those who live within the zone and their visitors, blue badge holders, easily recognisable delivery vehicles (e.g. supermarket lorries) and school staff.

The School Street concept is aimed at tackling problems associated with traffic around schools at drop-off and pick-up times, notably road safety concerns, poor air quality, and inconvenience to residents, by restricting motor traffic access in the immediate vicinity of a school access.

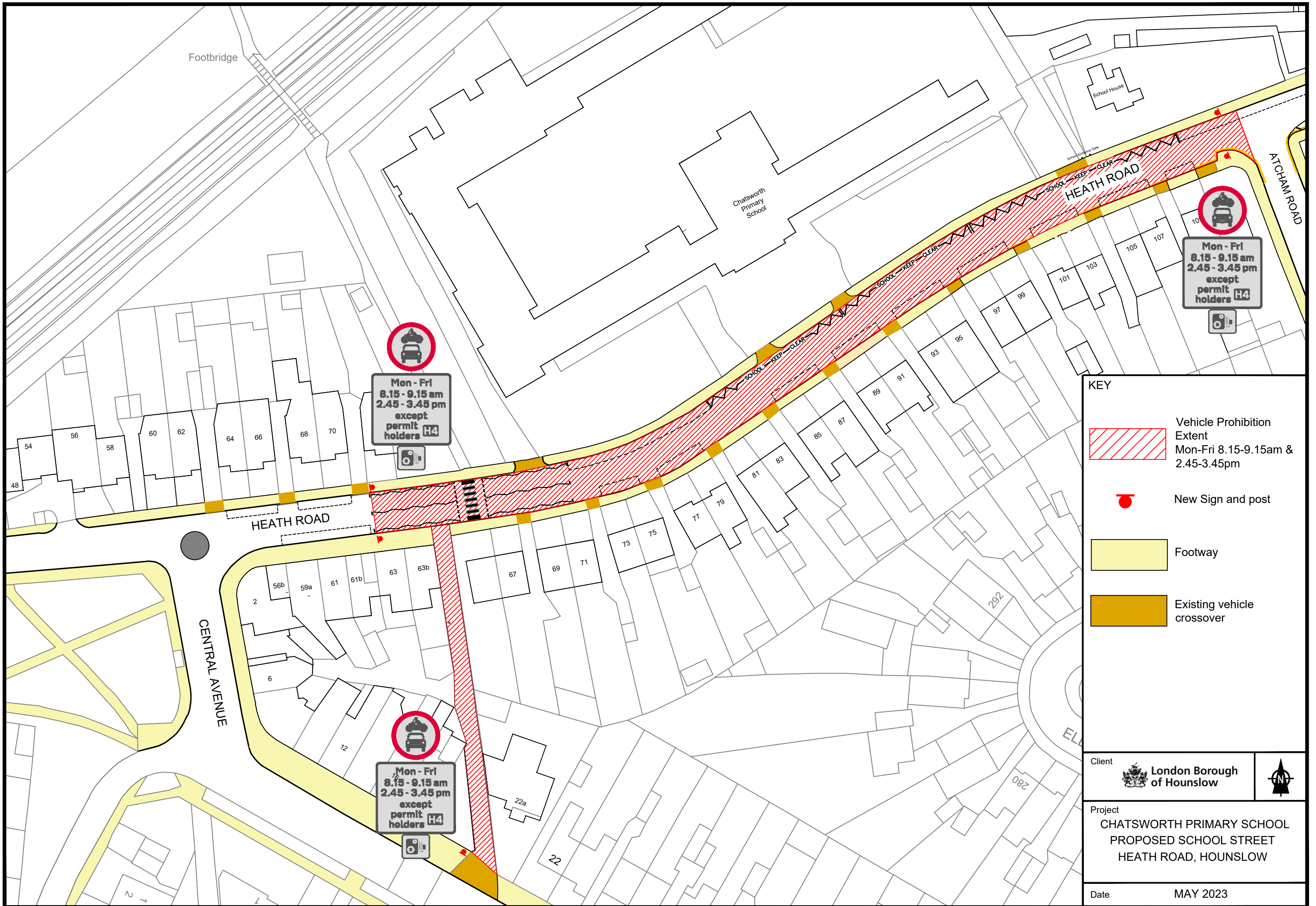
The restrictions are aligned with Hounslow Council's aim to promote active and healthy communities by:

- improving road safety for pupils, residents and visitors to the borough;
- reducing pollution in the area, including particulates, which especially impact young people;
- decreasing the number of motor traffic journeys taken by pupils and their parents and guardians by promoting walking, cycling and active lifestyles; and
- minimising anti-social behaviour arising from inconsiderate parking and dangerous manoeuvres.

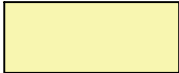

- KEY**
-  Vehicle Prohibition Extent
Mon-Fri 8.15-9.15am & 2.45-3.45pm
 -  New Sign and post
 -  Footway
 -  Existing vehicle crossover

Client
 **London Borough of Hounslow**



Project
**CHATSWORTH PRIMARY SCHOOL
 PROPOSED SCHOOL STREET
 HEATH ROAD, HOUNSLOW**

Date **MAY 2023**

Traffic Management Order

2021 No.56

The London Borough of Hounslow (School Streets) Order 2021

Made on 1 November 2021

Coming into operation on 8 November 2021

The Council of the London Borough of Hounslow, after consulting the Commissioner of Police of the Metropolis, in exercise of the powers conferred by section 6 of the Road Traffic Regulation Act 1984^a, as amended, and of all other enabling powers hereby makes the following Order:

1. Commencement and Citation

- (1) This Order shall come into operation on 8 November 2021 and may be cited as the London Borough of Hounslow (School Streets) Order 2021.

2. Interpretation

- (1) In this order, except where the context otherwise requires, the following expressions have the meanings hereby assigned to them:

“Council” means the Council of the London Borough of Hounslow.

“permit holder” means any person who has been granted exemption by the Council from the prohibition in Article 3.

“prohibited hours” means the times shown in column 3 in the Schedule to this Order, on Mondays to Fridays during school term time.

“school term time” means those days of the year which have been determined as school days by the Council as Local Education Authority in accordance with Section 21 of the Education (No.2) Act 1986^b.

3. Prohibition

- (1) Save as provided in Article 4, no person shall cause or permit any motor vehicle to enter the street specified in column 2 of the Schedule during the prohibited hours.

4. Exemptions

- (1) Nothing in this Order shall apply in respect of a person causing a motor vehicle to enter the prohibited area if:
 - a) it is being used by a permit holder
 - b) required to proceed in any road in accordance with any restriction or requirement indicated by traffic signs placed pursuant to section 67 of the Road Traffic Regulation Act 1984;

^a 1984 c.27

^b 1986 c.60

- c) the vehicle is being used for at least one of the following purposes:
 - i) fire and rescue authority
 - ii) ambulance
 - iii) blood service
 - iv) providing a response to an emergency at the request of an NHS ambulance service;
 - v) bomb or explosive disposal;
 - vi) special forces;
 - vii) police;
 - viii) National Crime Agency.
 - d) the vehicle is being used for the purposes of:
 - i) the maintenance, improvement or reconstruction of any length of highway specified in Schedule 1; or
 - ii) the laying, erection, alteration, repair or cleaning, in any length of highway specified in Schedule 1, of any sewer, or of any main, pipe or apparatus for the supply of gas, water, or electricity, or of any electronic communications apparatus;
- (2) Nothing in this Order shall apply to anything done with the permission of or at the direction of a police officer in uniform.

5. Revocations

(1) The following Orders are hereby revoked:

- A. The London Borough of Hounslow (No 13) Experimental Order 2020
- B. The London Borough of Hounslow (No 14) Experimental Order 2020
- C. The London Borough of Hounslow (No 15) Experimental Order 2020
- D. The London Borough of Hounslow (No 16) Experimental Order 2020
- E. The London Borough of Hounslow (No 17) Experimental Order 2020
- F. The London Borough of Hounslow (No 18) Experimental Order 2020
- G. The London Borough of Hounslow (No 19) Experimental Order 2020
- H. The London Borough of Hounslow (No 20) Experimental Order 2020
- I. The London Borough of Hounslow (No 21) Experimental Order 2020
- J. The London Borough of Hounslow (No 22) Experimental Order 2020
- K. The London Borough of Hounslow (No 23) Experimental Order 2020
- L. The London Borough of Hounslow (No 24) Experimental Order 2020
- M. The London Borough of Hounslow (No 34) Experimental Order 2020
- N. The London Borough of Hounslow (No 35) Experimental Order 2020
- O. The London Borough of Hounslow (No 45) Experimental Order 2020

Dated this 1st day of November 2021



Jefferson Nwokeoma
Assistant Director Transport, Parking and Environmental Strategy

Schedule

| 1. Item | 2. Description | 3. Prohibited Hours |
|------------|---|---|
| 1 | Albany Road, Brentford from the access road leading into Watermans Court to its junction with Alexandra Road. | Between 8.15am and 9.15am, and between 2.45pm and 3.45pm |
| 2 | Belgrave Road, Hounslow | Between 8.15am and 9.15am, and between 2.45pm and 3.45pm, |
| 3 | Logan Close, Hounslow | Between 8.15am and 9.15am, and between 2.45pm and 3.45pm, |
| 4 | Duke Road, Chiswick, from its junction with Fraser Street to the south-easternmost extremity | Between 8.15am and 9.15am, and between 2.45pm and 3.45pm |
| 5 | Orchard Road, Hounslow | Between 8.15am and 9.15am, and between 2.45pm and 3.45pm, |
| 6 | Benham Gardens, Hounslow | Between 8.15am and 9.15am, and between 2.45pm and 3.45pm |
| 7 | Peacock Avenue, Feltham, from its junction with Dudley Road to the southernmost extremity | Between 8:30 and 9:15am, and between 2:45 and 3:30pm |
| 8 | Redford Close, Feltham (spur leading from Redford Close spine to Edward Pauling Primary School) | Between 8.15am and 9.15am, and between 2.45pm and 3.45pm, |
| 9 | Selwyn Close, Hounslow | Between 8.15am and 9.00am, and between 2.45pm and 3.30pm, |
| 10 | Lampton Avenue, Hounslow | Between 8.15 and 9.15am, and between 2.45pm and 3.45pm, |
| 11 | North Dene, Hounslow | Between 8.15 and 9.15am, and between 2.45pm and 3.45pm, |
| 12 | Sutton Dene, Hounslow | Between 8.15 and 9.15am, and between 2.45pm and 3.45pm, |
| 13 | Berwyn Avenue, Hounslow | Between 8.15 and 9.15am, and between 2.45pm and 3.45pm, |
| 14 | North Road, Brentford between a point 11 metres south-east of the boundary of property Nos 21 / 22 and its north-western extremity | Between 8.15am and 9.15am, and between 2.45pm and 3.30pm |
| 15 | Summerwood Road, Isleworth, spur serving Nos 261-293 and Ivybridge Primary School (from Summerwood Road (spine) to Ivybridge Primary School | Between 8.15am and 9.15am, and between 2.45pm and 3.45pm, |

| | | |
|----|--|--|
| 16 | Speart Lane, Hounslow | Between 8.15am and 9.15am, and between 2.45pm and 3.45pm |
| 17 | Blackberry Farm Close | Between 8.15am and 9.15am, and between 2.45pm and 3.45pm |
| 18 | Star Road, Hounslow | Between 8.15am and 9.15am, and between 2.45pm and 3.45pm |
| 19 | Edensor Road, The service road behind Nos.10-14 | Between 8.15am and 9.15am, and between 2.45pm and 3.45pm |
| 20 | Pears Road, Hounslow, from the eastern kerbline of Inwood Road to a point 24.8m east of the boundary of 99/101 Pears Road | Between 8.15am and 9.15am, and between 2.45pm and 3.45pm |
| 21 | School Road, Hounslow, from a point 18.77m north of the boundary of 5/7 School Road to the northern kerbline of Pears Road | Between 8.15am and 9.15am, and between 2.45pm and 3.45pm |
| 22 | Linkfield Road, Isleworth, between its junction with Kendall Road and its junction with Grainger Road | Between 8.15am and 9.15am, and between 2.45pm and 3.45pm |
| 23 | Smallberry Avenue, Isleworth | Between 8.15am and 9.15am, and between 2.45pm and 3.45pm |
| 24 | Thackeray Close, Isleworth | Between 8.15am and 9.15am, and between 2.45pm and 3.45pm |
| 25 | Town Field Way, Isleworth | Between 8.15am and 9.15am, and between 2.45pm and 3.45pm |
| 26 | Mandeville Road, Isleworth | Between 8.15am and 9.15am, and between 2.45pm and 3.45pm |
| 27 | Ferney Meade Way, Isleworth | Between 8.15am and 9.15am, and between 2.45pm and 3.45pm |
| 28 | Teck Close, Isleworth | Between 8.15am and 9.15am, and between 2.45pm and 3.45pm |
| 29 | White Lodge Close, Isleworth | Between 8.15am and 9.15am, and between 2.45pm and 3.45pm |
| 30 | Leigham Drive | Between 7.45 and 9.15am, and between 2.45 and 4.15 pm |
| 31 | Great West Road service road serving Nos 706-748 (evens) | Between 7.45 and 9.15am, and between 2.45 and 4.15 pm |
| 32 | Denham Road, Feltham (the north to south arm), from its junction with the east to west arm of Denham Road to the south-westernmost extremity | Between 8.15am and 9.30am, and between 3pm and 3.45pm |

| | | |
|----|---|--|
| 33 | Hounslow Road, Hanworth, the service road fronting Nos.64-80 Hounslow Road | Between 8.30am and 9.30am, and between 2.45pm and 3.45pm |
| 34 | Carville Crescent, Brentford between Nos.36/38 Carville Crescent and Nos.132a.132b Carville Crescent | Between 8.30am and 9.30am, and between 3pm-4pm |
| 35 | Crowther Avenue, Brentford between its junction with Carville Crescent and Brentwick Gardens | Between 8.30am and 9.30am, and between 3pm-4pm |
| 36 | Darcy Road | Between 8:15am and 9:30am, and between 2:45pm and 3:45pm |
| 37 | Finney Lane | Between 8:15am and 9:30am, and between 2:45pm and 3:45pm |
| 38 | Holderness Road | Between 8:15am and 9:30am, and between 2:45pm and 3:45pm |
| 39 | Blenheim Way | Between 8:15am and 9:30am, and between 2:45pm and 3:45pm |
| 40 | Jodrell Close | Between 8:15am and 9:30am, and between 2:45pm and 3:45pm |
| 41 | Turnpike Way | Between 8:15am and 9:30am, and between 2:45pm and 3:45pm |
| 42 | Old Pound Close | Between 8:15am and 9:30am, and between 2:45pm and 3:45pm |
| 43 | Nightingale Close, Chiswick | Between 8:30 and 9:30am, and between 2:45-3:45pm |
| 44 | Grove Park Terrace, Chiswick, from a point 3.2m north-east of the north-eastern kerbline of St Mary's Grove to a point 2.3m south-west of the south-western kerbline of Burnaby Gardens | Between 8:30 and 9:30am, and between 2:45-3:45pm |
| 45 | St Thomas Road, Chiswick, from a point 3.5 metres south-west of the south-western kerbline of Florence Gardens to a point 5 metres north-east of the common boundary of nos. 41/43 St. Thomas' Road | Between 8:30 and 9:30am, and between 2:45-3:45pm |
| 46 | St Thomas Road, Chiswick, the service road outside the south west block of 1 to 32 Montgomery Court and the north west block of 33-64 Montgomery Court | Between 8:30 and 9:30am, and between 2:45-3:45pm |
| 47 | St Thomas Road, Chiswick, the service road outside the south west block of 33 to 64 Montgomery Court and the north west block of 65-96 Montgomery Court) | Between 8:30 and 9:30am, and between 2:45-3:45pm |

EXPLANATORY NOTE

(This Note is not part of the Order, but is intended to indicate its general purport.)

This Order introduces restrictions on motor vehicles, except permit holders, entering roads in the vicinity of schools, during school term-time drop-off and pick-up times.