

Appendix 1 – Proposed micromobility locations within the Brentford West Ward

For the Brentford West ward, there are a total of 9 micromobility locations proposed. All bays are proposed on the carriageway unless otherwise identified in the location description.

Street Name	Location Description	Length of Bay
Avenue Road	Adjacent to No. 121 Windmill Road	7 metres (of resident permit bay)
Boston Gardens	Adjacent to No. 100 Boston Manor Road	9.5 metres (6.5 metres of resident permit bay and 3 metres of double yellow line)
Church Walk	South-east of the junction with Boston Manor Road	8 metres (of permit / pay to park bay)
Clayton Crescent	Footway opposite No. 5 Clayton Crescent	5 metres (of footway)
Clifden Road	Adjacent to No. 98 Brook Road South	8 metres (of resident permit bay)
High Street	Adjacent to Albany Parade, approximately opposite Goat Wharf	7 metres (of loading only bay)
Junction Road	Outside No. 114 Whitestile Road (on Junction Road)	7 metres (of resident permit bay)
Lateward Road	Opposite No. 5 Lateward Road	7 metres (of permit / pay to park bay)
Manor Vale	East of the junction with Boston Manor Road	7 metres (of double yellow line)

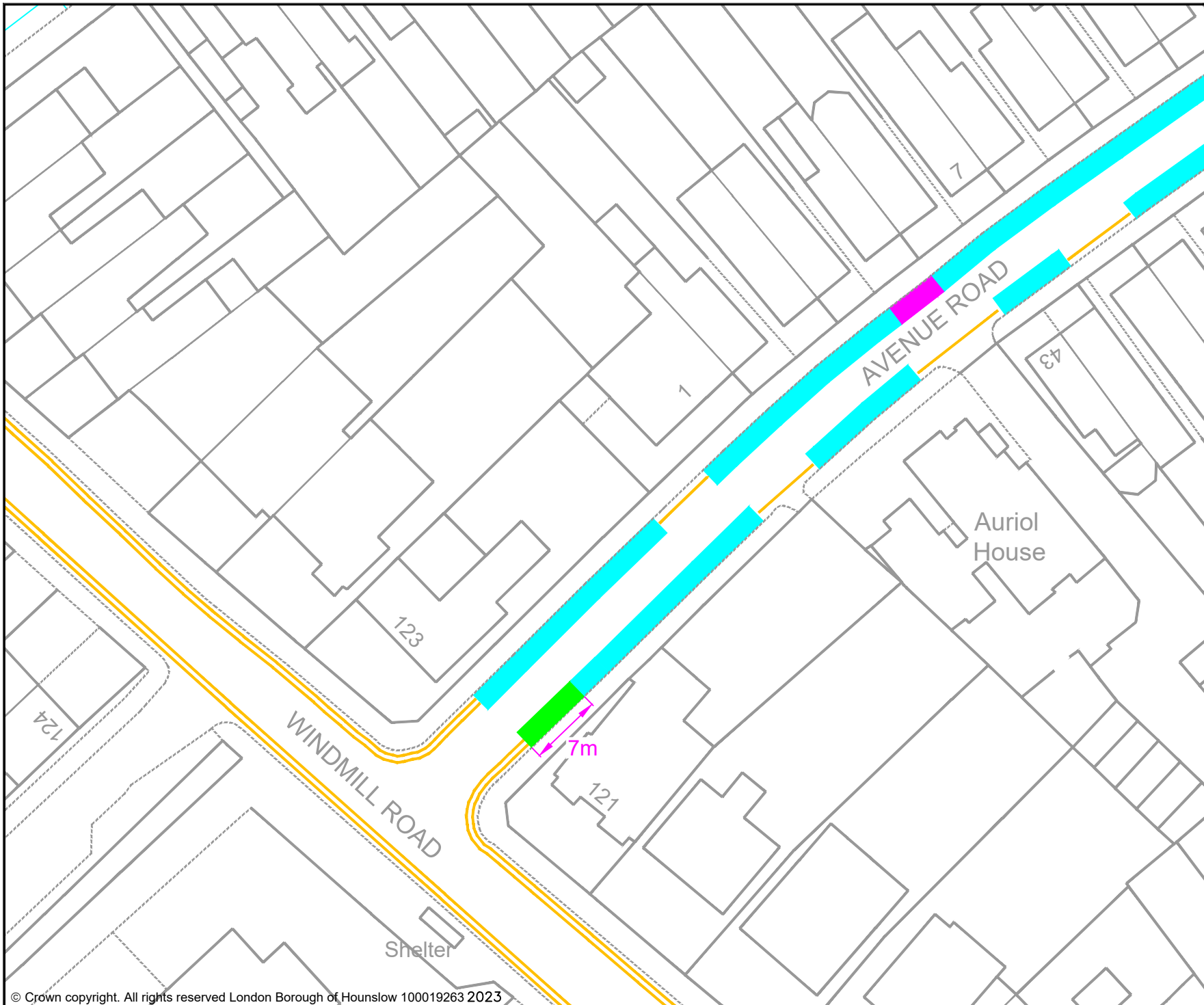

KEY

- MICRO-MOBILITY BAY
- EXISTING PERMIT HOLDERS BAY
- EXISTING PERMIT HOLDERS / 'PAY TO PARK' BAY
- EXISTING 'PAY TO PARK' BAY
- EXISTING BLUE BADGE HOLDER BAY
- EXISTING ELECTRIC VEHICLE CHARGING OR CAR CLUB BAY
- EXISTING LOADING ONLY BAY
- EXISTING MOTOR - CYCLE ONLY BAY
- EXISTING DOUBLE YELLOW LINES
- EXISTING SINGLE YELLOW LINE
- EXISTING RED ROUTE RESTRICTION
- 1 POST / SIGN SCHEDULE NUMBER

Jefferson Nwokeoma
 Assistant Director of Traffic, Transport & Parking
 Hounslow House, 7 Bath Road,
 Hounslow, TW3 3EB

Client	
--------	--

Project
PROPOSED MICRO-MOBILITY PARKING BAY

Drawing Title
AVENUE ROAD, BRENTFORD

Drawing Status
PROPOSED

Drawn	Approved	Date	Scale	Size
AN	AH	MAR-2023	1:500	A4
Dwg No				Rev
-				-

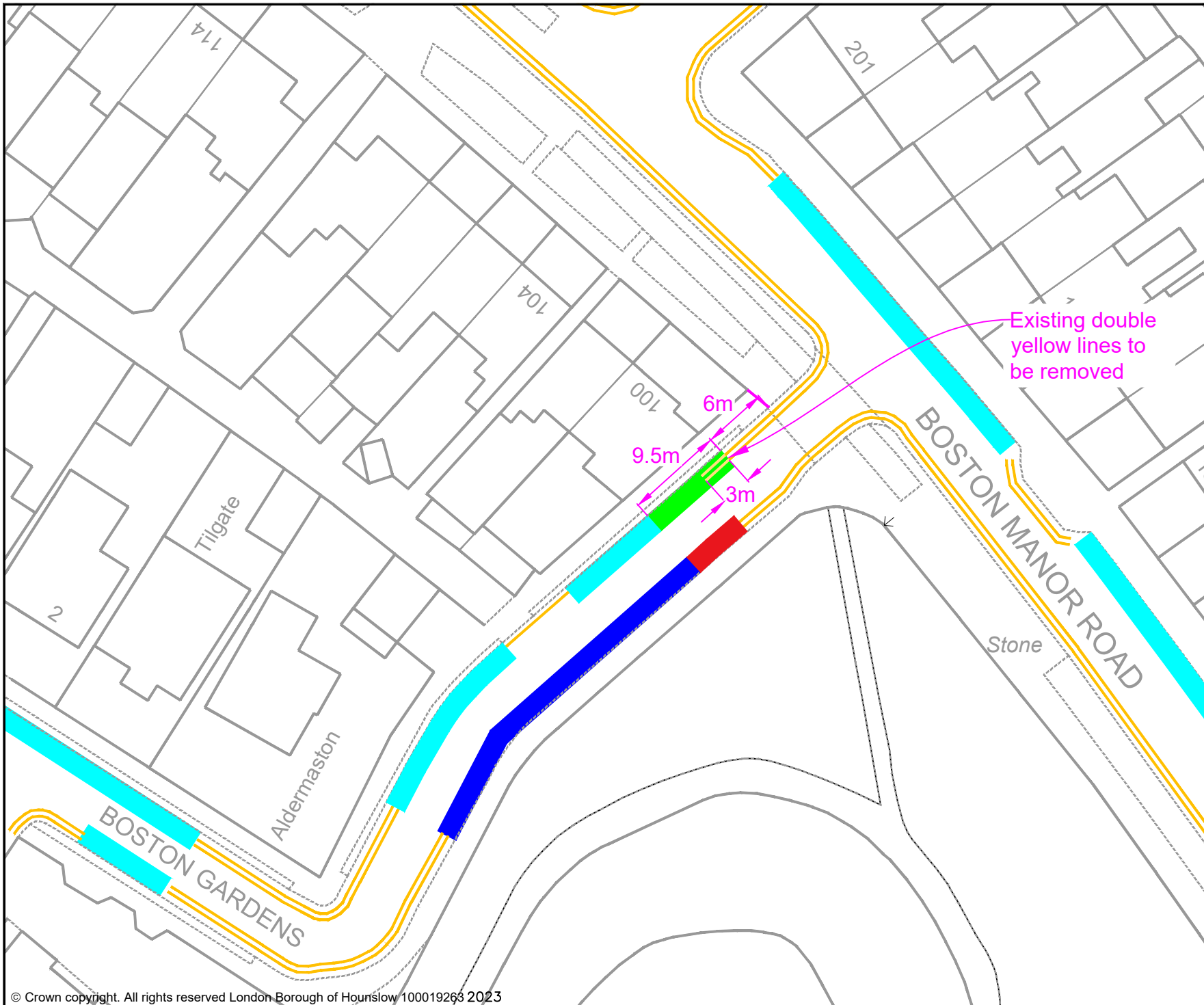

- KEY**
- MICRO-MOBILITY BAY
 - EXISTING PERMIT HOLDERS BAY
 - EXISTING PERMIT HOLDERS / 'PAY TO PARK' BAY
 - EXISTING 'PAY TO PARK' BAY
 - EXISTING BLUE BADGE HOLDER BAY
 - EXISTING ELECTRIC VEHICLE CHARGING OR CAR CLUB BAY
 - EXISTING LOADING ONLY BAY
 - EXISTING MOTOR - CYCLE ONLY BAY
 - EXISTING DOUBLE YELLOW LINES
 - EXISTING SINGLE YELLOW LINE
 - EXISTING RED ROUTE RESTRICTION
 - 1 POST / SIGN SCHEDULE NUMBER

Jefferson Nwokeoma
 Assistant Director of Traffic, Transport & Parking
 Hounslow House, 7 Bath Road,
 Hounslow, TW3 3EB

Client 	
------------	--

Project
PROPOSED MICRO-MOBILITY PARKING BAY

Drawing Title
BOSTON GARDENS, BRENTFORD

Drawing Status
PROPOSED

Drawn	Approved	Date	Scale	Size
AN	AH	MAR-2023	1:500	A4

Dwg No	Rev
-	-

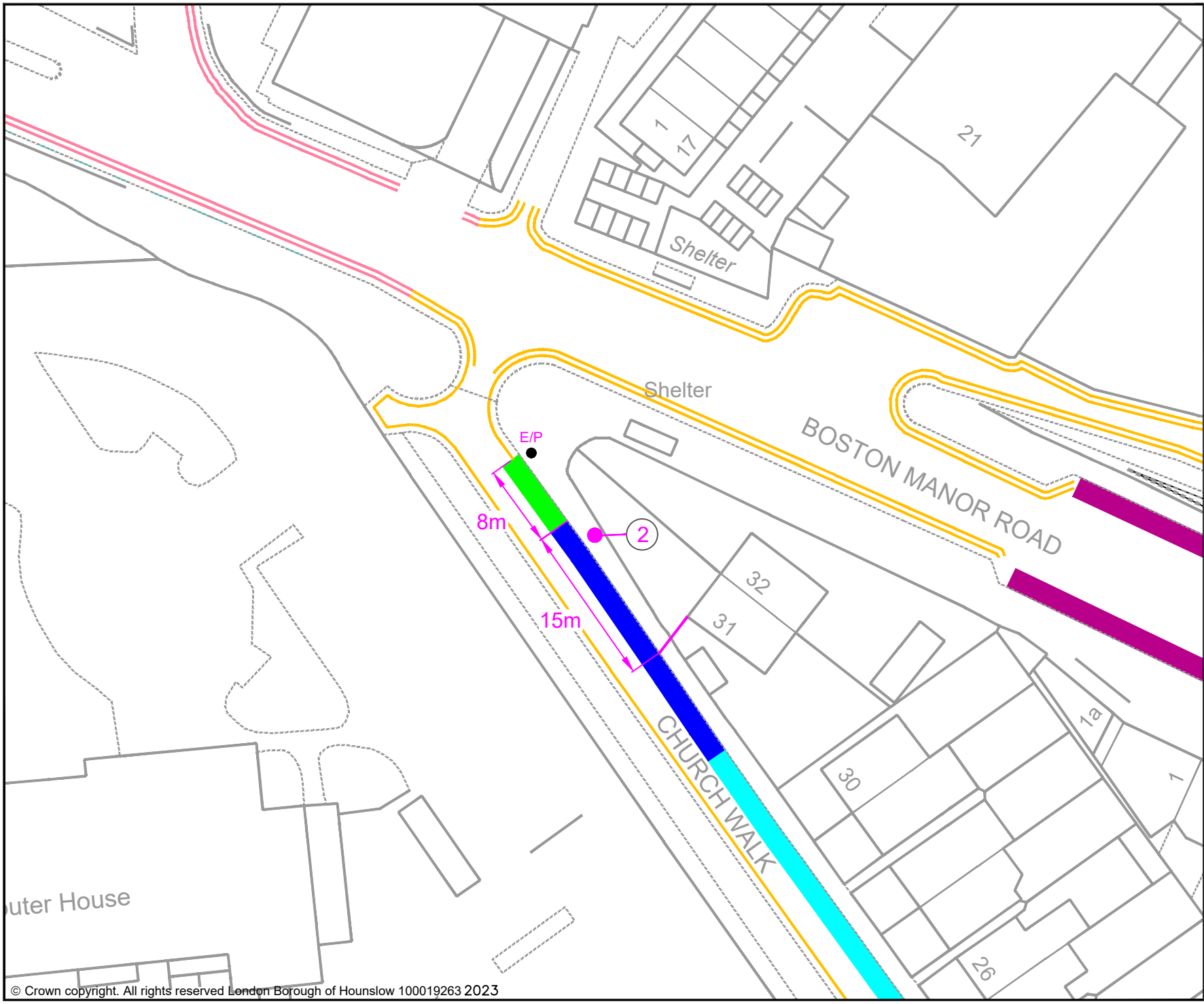

KEY

- MICRO-MOBILITY BAY
- EXISTING PERMIT HOLDERS BAY
- EXISTING PERMIT HOLDERS / 'PAY TO PARK' BAY
- EXISTING 'PAY TO PARK' BAY
- EXISTING BLUE BADGE HOLDER BAY
- EXISTING ELECTRIC VEHICLE CHARGING OR CAR CLUB BAY
- EXISTING LOADING ONLY BAY
- EXISTING MOTOR - CYCLE ONLY BAY
- EXISTING DOUBLE YELLOW LINES
- EXISTING SINGLE YELLOW LINE
- EXISTING RED ROUTE RESTRICTION
- 1 POST / SIGN SCHEDULE NUMBER

Jefferson Nwokeoma
Assistant Director of Traffic, Transport & Parking
Hounslow House, 7 Bath Road,
Hounslow, TW3 3EB

Client		London Borough of Hounslow		
Project				
PROPOSED MICRO-MOBILITY PARKING BAY				
Drawing Title				
CHURCH WALK, BRENTFORD				
Drawing Status				
PROPOSED				
Drawn	Approved	Date	Scale	Size
AN	AH	MAR-2023	1:500	A4
Dwg No				Rev
				-

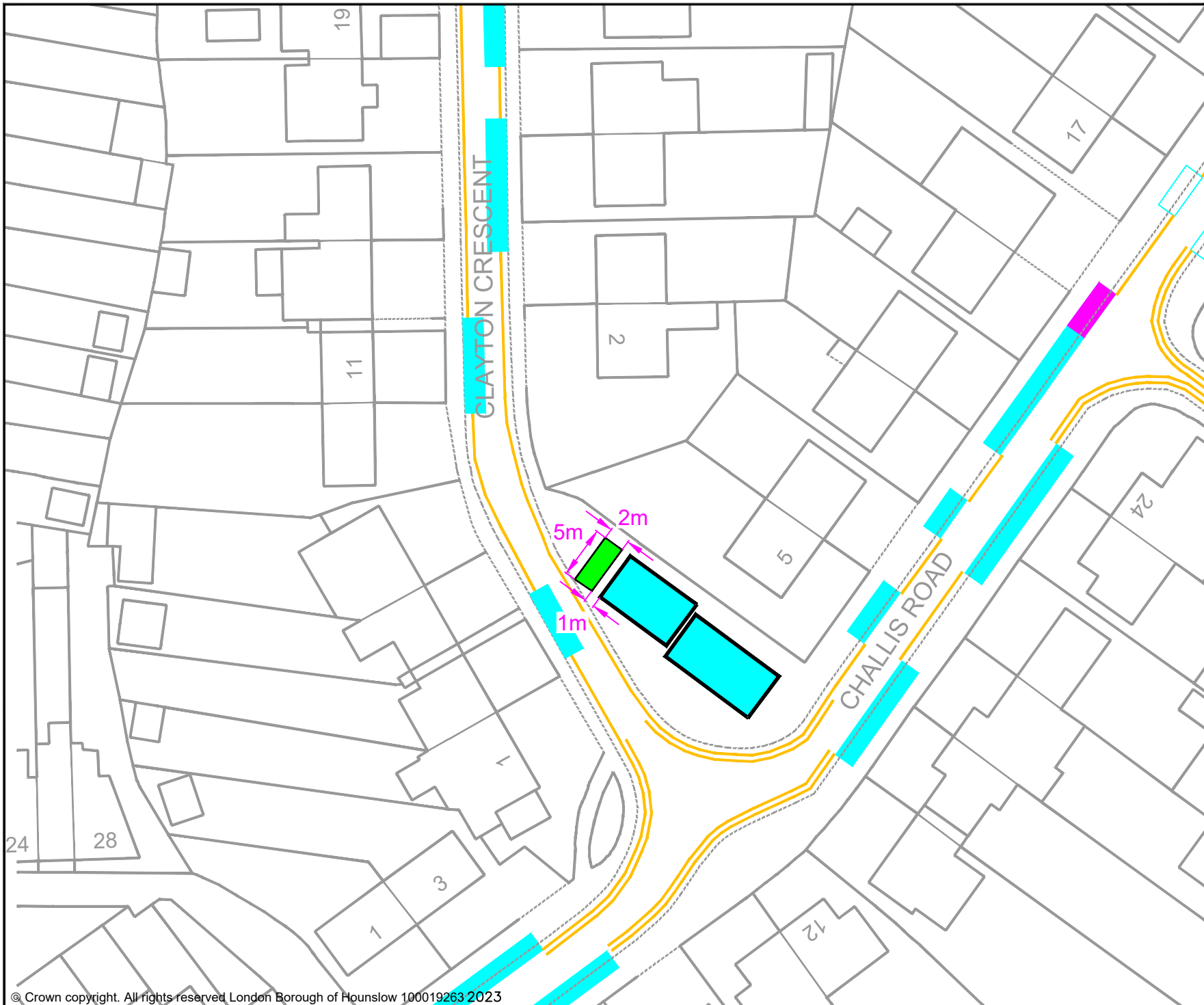

- KEY**
- MICRO-MOBILITY BAY
 - EXISTING PERMIT HOLDERS BAY
 - EXISTING PERMIT HOLDERS / 'PAY TO PARK' BAY
 - EXISTING 'PAY TO PARK' BAY
 - EXISTING BLUE BADGE HOLDER BAY
 - EXISTING ELECTRIC VEHICLE CHARGING OR CAR CLUB BAY
 - EXISTING LOADING ONLY BAY
 - EXISTING MOTOR - CYCLE ONLY BAY
 - EXISTING DOUBLE YELLOW LINES
 - EXISTING SINGLE YELLOW LINE
 - EXISTING RED ROUTE RESTRICTION
 - 1 POST / SIGN SCHEDULE NUMBER

Jefferson Nwokeoma
 Assistant Director of Traffic, Transport & Parking
 Hounslow House, 7 Bath Road,
 Hounslow, TW3 3EB

Client	
--------	--

Project
PROPOSED MICRO-MOBILITY PARKING BAY

Drawing Title
CLAYTON CRESCENT, BRENTFORD

Drawing Status
PROPOSED

Drawn	Approved	Date	Scale	Size
AN	AH	MAR-2023	1:500	A4

Dwg No	Rev
-	-

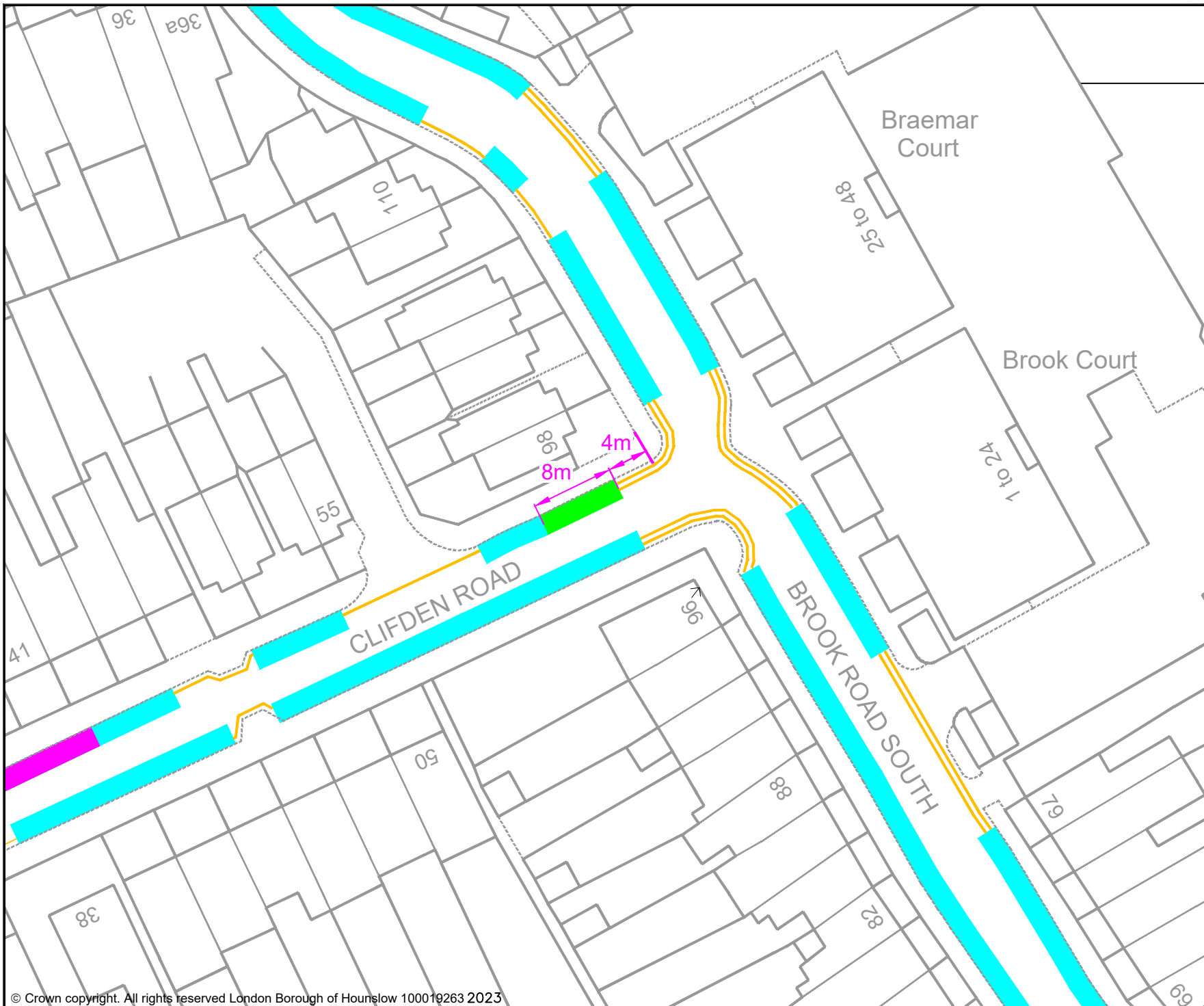

KEY

- MICRO-MOBILITY BAY
- EXISTING PERMIT HOLDERS BAY
- EXISTING PERMIT HOLDERS / 'PAY TO PARK' BAY
- EXISTING 'PAY TO PARK' BAY
- EXISTING BLUE BADGE HOLDER BAY
- EXISTING ELECTRIC VEHICLE CHARGING OR CAR CLUB BAY
- EXISTING LOADING ONLY BAY
- EXISTING MOTOR - CYCLE ONLY BAY
- EXISTING DOUBLE YELLOW LINES
- EXISTING SINGLE YELLOW LINE
- EXISTING RED ROUTE RESTRICTION
- 1 POST / SIGN SCHEDULE NUMBER

Jefferson Nwokeoma
 Assistant Director of Traffic, Transport & Parking
 Hounslow House, 7 Bath Road,
 Hounslow, TW3 3EB

Client

Project
PROPOSED MICRO-MOBILITY PARKING BAY

Drawing Title
CLIFDEN ROAD, BRENTFORD

Drawing Status
PROPOSED

Drawn	Approved	Date	Scale	Size
AN	AH	MAR-2023	1:500	A4

Dwg No	Rev
-	-

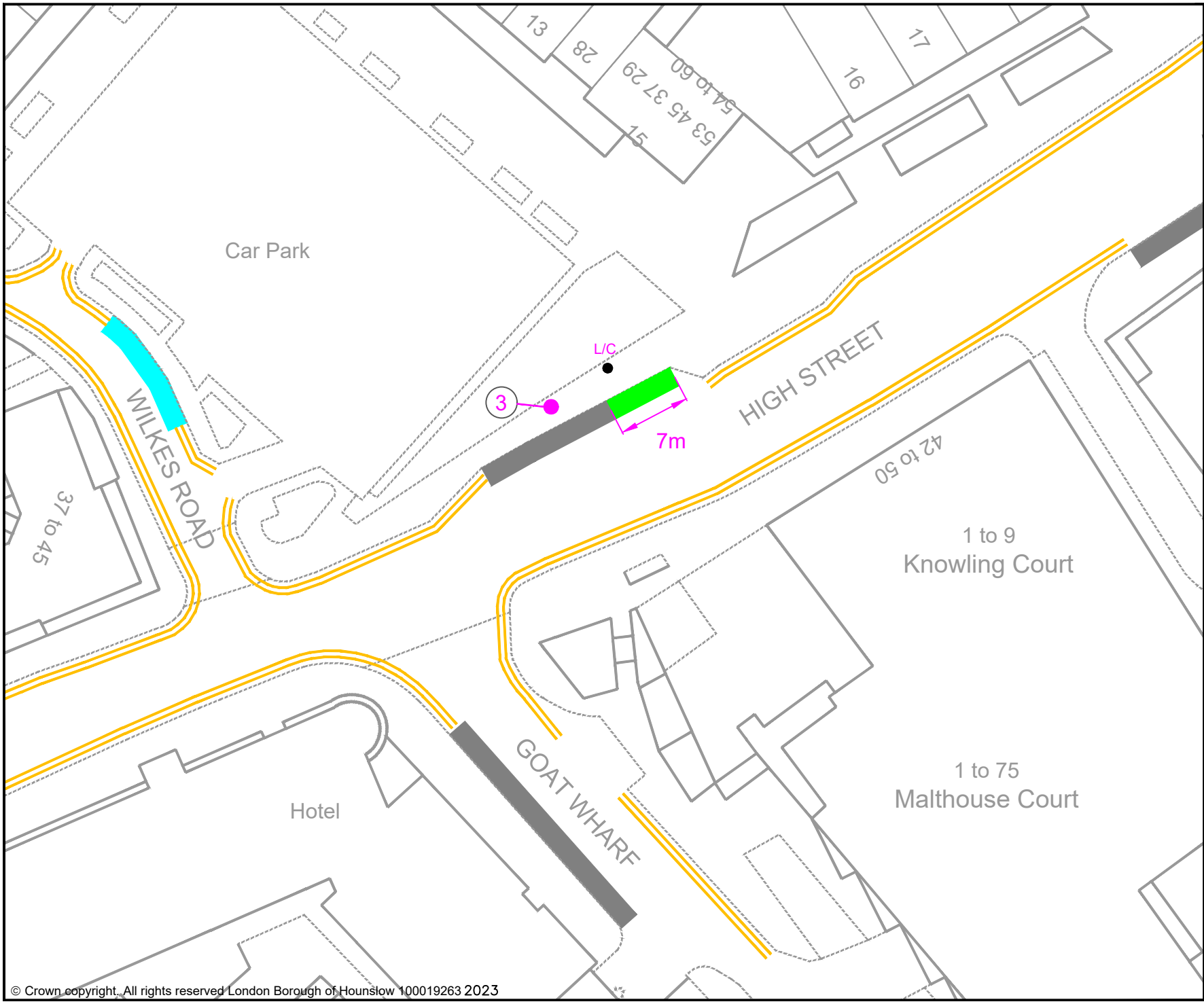

KEY

- MICRO-MOBILITY BAY
- EXISTING PERMIT HOLDERS BAY
- EXISTING PERMIT HOLDERS / 'PAY TO PARK' BAY
- EXISTING 'PAY TO PARK' BAY
- EXISTING BLUE BADGE HOLDER BAY
- EXISTING ELECTRIC VEHICLE CHARGING OR CAR CLUB BAY
- EXISTING LOADING ONLY BAY
- EXISTING MOTOR - CYCLE ONLY BAY
- EXISTING DOUBLE YELLOW LINES
- EXISTING SINGLE YELLOW LINE
- EXISTING RED ROUTE RESTRICTION
- 1 POST / SIGN SCHEDULE NUMBER

Jefferson Nwokeoma
 Assistant Director of Traffic, Transport & Parking
 Hounslow House, 7 Bath Road,
 Hounslow, TW3 3EB

Client 	
------------	--

Project
PROPOSED MICRO-MOBILITY PARKING BAY

Drawing Title
HIGH STREET, BRENTFORD

Drawing Status
PROPOSED

Drawn	Approved	Date	Scale	Size
AN	AH	MAR-2023	1:500	A4
Dwg No				Rev
				-

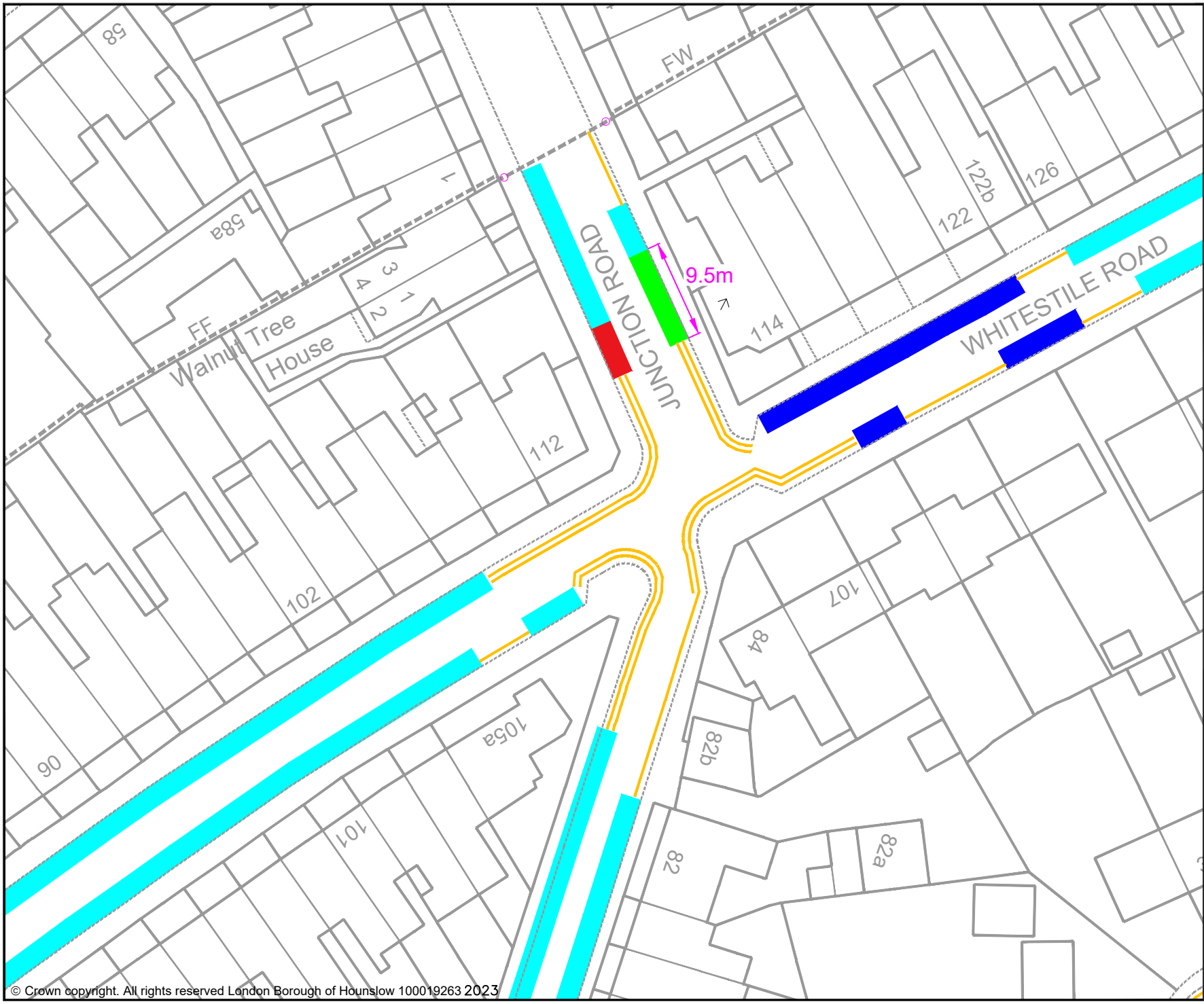

KEY

- MICRO-MOBILITY BAY
- EXISTING PERMIT HOLDERS BAY
- EXISTING PERMIT HOLDERS / 'PAY TO PARK' BAY
- EXISTING 'PAY TO PARK' BAY
- EXISTING BLUE BADGE HOLDER BAY
- EXISTING ELECTRIC VEHICLE CHARGING OR CAR CLUB BAY
- EXISTING LOADING ONLY BAY
- EXISTING MOTOR - CYCLE ONLY BAY
- EXISTING DOUBLE YELLOW LINES
- EXISTING SINGLE YELLOW LINE
- EXISTING RED ROUTE RESTRICTION
- 1 POST / SIGN SCHEDULE NUMBER

Jefferson Nwokeoma
 Assistant Director of Traffic, Transport & Parking
 Hounslow House, 7 Bath Road,
 Hounslow, TW3 3EB

Client	
--------	--

Project
PROPOSED MICRO-MOBILITY PARKING BAY

Drawing Title
JUNCTION ROAD, BRENTFORD

Drawing Status
PROPOSED

Drawn	Approved	Date	Scale	Size
AN	AH	MAR-2023	1:500	A4
Dwg No				Rev
				-



- KEY**
- MICRO-MOBILITY BAY
 - EXISTING PERMIT HOLDERS BAY
 - EXISTING PERMIT HOLDERS / 'PAY TO PARK' BAY
 - EXISTING 'PAY TO PARK' BAY
 - EXISTING BLUE BADGE HOLDER BAY
 - EXISTING ELECTRIC VEHICLE CHARGING OR CAR CLUB BAY
 - EXISTING LOADING ONLY BAY
 - EXISTING MOTOR - CYCLE ONLY BAY
 - EXISTING DOUBLE YELLOW LINES
 - EXISTING SINGLE YELLOW LINE
 - EXISTING RED ROUTE RESTRICTION
 - 1 POST / SIGN SCHEDULE NUMBER

Jefferson Nwokeoma
 Assistant Director of Traffic, Transport & Parking
 Hounslow House, 7 Bath Road,
 Hounslow, TW3 3EB

Client	
--------	--

Project
PROPOSED MICRO-MOBILITY PARKING BAY

Drawing Title
LATEWARD ROAD, BRENTFORD

Drawing Status
PROPOSED

Drawn	Approved	Date	Scale	Size
AN	AH	MAR-2023	1:500	A4

Dwg No	Rev
-	-

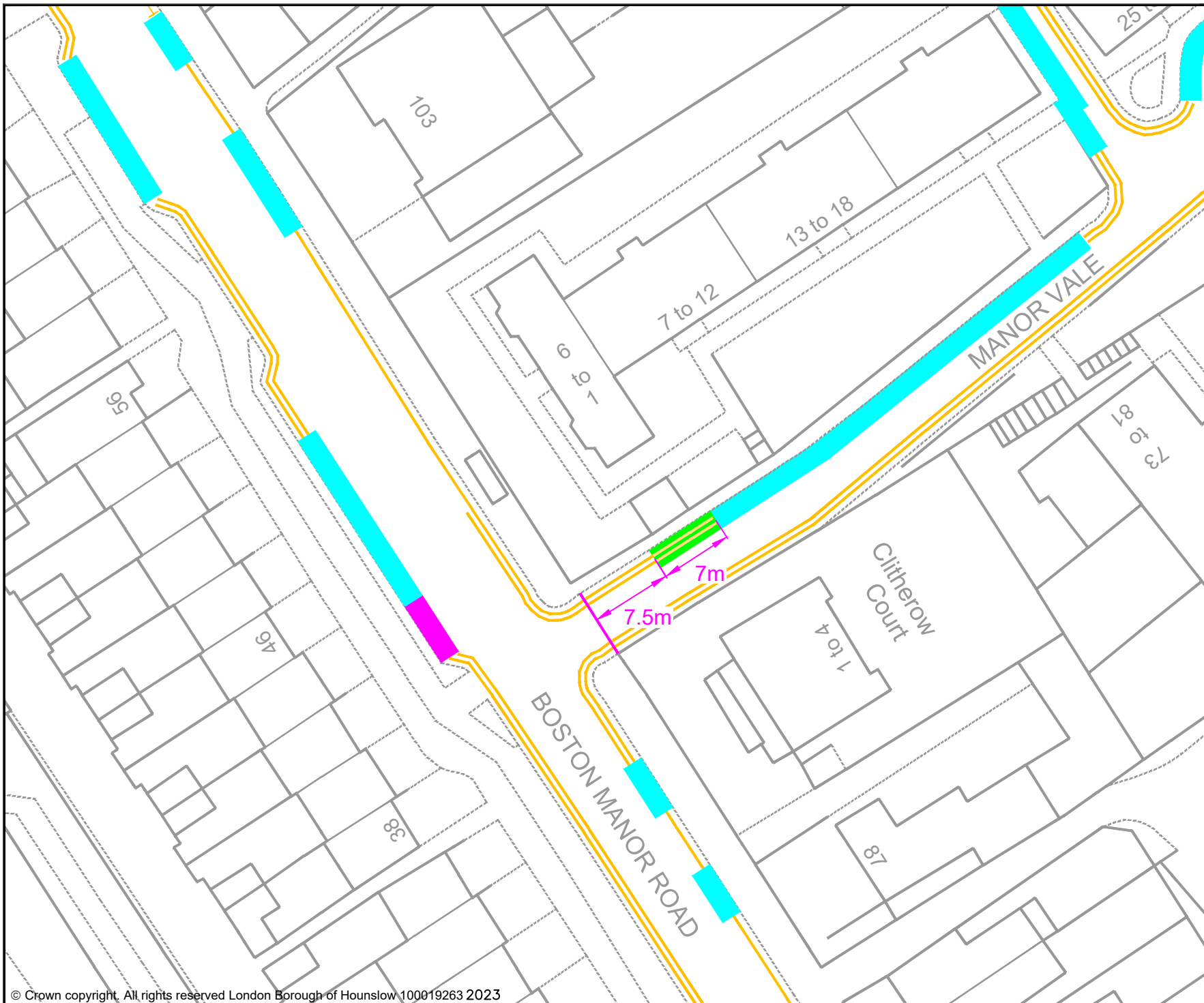

KEY	
	MICRO-MOBILITY BAY
	EXISTING PERMIT HOLDERS BAY
	EXISTING PERMIT HOLDERS / 'PAY TO PARK' BAY
	EXISTING 'PAY TO PARK' BAY
	EXISTING BLUE BADGE HOLDER BAY
	EXISTING ELECTRIC VEHICLE CHARGING OR CAR CLUB BAY
	EXISTING LOADING ONLY BAY
	EXISTING MOTOR - CYCLE ONLY BAY
	EXISTING DOUBLE YELLOW LINES
	EXISTING SINGLE YELLOW LINE
	EXISTING RED ROUTE RESTRICTION
	POST / SIGN SCHEDULE NUMBER

Jefferson Nwokeoma
 Assistant Director of Traffic, Transport & Parking
 Hounslow House, 7 Bath Road,
 Hounslow, TW3 3EB

Client		
--------	--	--

Project
 PROPOSED MICRO-MOBILITY PARKING BAY

Drawing Title
 MANOR VALE, BRENTFORD

Drawing Status
 PROPOSED

Drawn	Approved	Date	Scale	Size
AN	AH	MAR-2023	1:500	A4
Dwg No	-	Rev	-	-