



# London Borough of Hounslow

## Deposited Documents – Reference TMO/P032/20

Held on deposit online on the London Borough of Hounslow's website -

[www.hounslow.gov.uk/downloads/20165/traffic\\_notices](http://www.hounslow.gov.uk/downloads/20165/traffic_notices)

Placed on deposit on Wednesday, 18 November 2020

## Goods vehicle loading bay – New Heston Road, Hounslow

### Contents:

1. **Notice of Making dated 18 November**
2. **Traffic Management Orders**
  - A. The London Borough of Hounslow (Loading Places) (Amendment No.44) Order 2020
3. **Intent dated 9 September 2020**
4. **Proposed Traffic Management Orders**
  - A. The London Borough of Hounslow (Loading Places) (Amendment No.\*\*\*) Order 20\*\*
3. **Statement of Reasons**
4. **Plan**
5. **Existing Traffic Management Orders**
  - A. London Borough of Hounslow (Loading Places) Order 2009

Any person wishing to comment on or object to the order should follow the instructions on the Notice.

Any queries regarding these deposited documents should be sent by email to [trafficorders@hounslow.gov.uk](mailto:trafficorders@hounslow.gov.uk) or alternatively a voicemail can be left on extension 3322.

## **Goods vehicle loading bay – New Heston Road, Hounslow**

### **A. The London Borough of Hounslow (Loading Places) (Amendment No.44) Order 2020**

1. The London Borough of Hounslow on 16 November 2020 made the above Order under the Road Traffic Regulation Act 1984. The Order will come into operation on 23 November 2020.
2. The general effect of the above Order will be to introduce a goods vehicle only loading bay outside Nos.1 to 9 Elm Tree Court, New Heston Road which would operate “at any time”, maximum stay of 20 minutes, no return for one hour.
3. Documents giving further information of the Order can be viewed for a period of 6 weeks from the date of this Notice online at [hounslow.gov.uk](https://hounslow.gov.uk) by typing in the term “traffic notices” in the search bar.
4. Any person desiring to question the validity of the Order or any provision contained therein on the grounds that they are not within the relevant powers of the Road Traffic Regulation Act 1984, or that any of the relevant regulations made thereunder have not been complied with in relation to the Order may, within six weeks of the date on which the Order was made, make an application for the purpose to the High Court.

Dated 18 November 2020

Mark Frost  
Assistant Director Transport, Parking & Environmental Strategy

# Traffic Management Order

2020 No.106

The London Borough of Hounslow (Loading Places) (2009, No.1) (Amendment No.44) Order 2020

Made on 16 November 2020

Coming into operation on 23 November 2020

The Council of the London Borough of Hounslow, after consulting the Commissioner of Police of the Metropolis, in exercise of the powers conferred by section 6 and 124 of the Road Traffic Regulation Act 1984<sup>a</sup>, and of all other enabling powers hereby make the following Order:

1. This Order may be cited as the London Borough of Hounslow (Loading Places) (2009, No.1) (Amendment No.44) Order 2020 and shall come into operation for all purposes on 23 November 2020.
2. Without prejudice to the validity of anything done or to any liability incurred in respect of any act or omission before the coming into operation of this Order, the London Borough of Hounslow (Loading Places) Order 2009<sup>b</sup> shall have effect as though:
  - a) the item numbered 79 was added to Schedule 2 to that Order with the item similarly numbered and set out in the Schedule to this Order.

Dated this sixteenth day of November 2020



Assistant Director Transport, Parking & Environmental Strategy  
(The officer appointed for this purpose)

## Schedule

1. Item	2. Designated loading place	3. Permitted hours	4. Maximum stay	5. No return within
79	<b>New Heston Road, Hounslow</b> , the south side, from the eastern flank wall of Nos.1 to 9 Elm Tree Court, New Heston Road, westwards for a distance of 13 metres.	At any time	20 minutes	1 hour

<sup>a</sup> 1984 c.27

<sup>b</sup> LBH 2009/04

---

### **EXPLANATORY NOTE**

(This Note is not part of the Order, but is intended to indicate its general purport.)

This Order amends the Order of 2009 by introducing a new goods vehicle loading bay outside Nos.1 to 9 Elm Tree Court, New Heston Road.

## **Proposed goods vehicle loading bay – New Heston Road, Hounslow**

### **A. The London Borough of Hounslow (Loading Places) (Amendment No.\*\*\*) Order 20\*\***

1. The London Borough of Hounslow proposes to make the above Order under the Road Traffic Regulation Act 1984.
2. The general effect of the above Order would be to introduce a goods vehicle only loading bay outside Nos.1 to 9 Elm Tree Court, New Heston Road which would operate “at any time”, maximum stay of 20 minutes, no return for one hour.
3. Documents giving further information of the proposed Order can be viewed for a period of 21 days from the date of this Notice online at [hounslow.gov.uk](https://hounslow.gov.uk) by typing in the term “traffic notices” in the search bar.
4. Any person wishing to comment on the proposed Order should send a statement in writing stating the grounds of the objection to the Assistant Director Transport, Parking & Environmental Strategy at the address above or by email to [trafficorders@hounslow.gov.uk](mailto:trafficorders@hounslow.gov.uk) quoting the reference TMO/P032/20 to be received by no later than Wednesday, 30 September 2020.

Dated 9 September 2020



Mark Frost  
Assistant Director Transport, Parking & Environmental Strategy

# Traffic Management Order

20\*\* No.\*\*

The London Borough of Hounslow (Loading Places) (2009, No.1) (Amendment No.\*\*\*) Order 20\*\*

Made on \*\* \* 20\*\*

Coming into operation on \*\* \* 20\*\*

The Council of the London Borough of Hounslow, after consulting the Commissioner of Police of the Metropolis, in exercise of the powers conferred by section 6 and 124 of the Road Traffic Regulation Act 1984<sup>a</sup>, and of all other enabling powers hereby make the following Order:

1. This Order may be cited as the London Borough of Hounslow (Loading Places) (2009, No. 1) (Amendment No.\*\*\*) Order 20\*\* and shall come into operation for all purposes on \*\* \* 20\*\*.
2. Without prejudice to the validity of anything done or to any liability incurred in respect of any act or omission before the coming into operation of this Order, the London Borough of Hounslow (Loading Places) Order 2009<sup>b</sup> shall have effect as though:
  - a) the item numbered \*\* was added to Schedule 2 to that Order with the item similarly numbered and set out in the Schedule to this Order.

Dated this \*\* day of 20\*\*

Assistant Director Transport, Parking & Environmental Strategy  
(The officer appointed for this purpose)

## Schedule

1. Item	2. Designated loading place	3. Permitted hours	4. Maximum stay	5. No return within
17	<b>New Heston Road, Hounslow</b> , the south side, from the eastern flank wall of Nos.1 to 9 Elm Tree Court, New Heston Road, westwards for a distance of 13 metres.	At any time	20 minutes	1 hour

<sup>a</sup> 1984 c.27

<sup>b</sup> LBH 2009/04

---

### **EXPLANATORY NOTE**

(This Note is not part of the Order, but is intended to indicate its general purport.)

This Order amends the Order of 2009 by introducing a new goods vehicle loading bay outside Nos.1 to 9 Elm Tree Court, New Heston RoadRegatta Point, 38 Kew Bridge Road.



**London Borough  
of Hounslow**

## **Proposed goods vehicle loading bay – New Heston Road, Hounslow**

### **STATEMENT OF REASONS**

The Council is proposing to introduce a goods vehicle only loading bay outside Nos.1 to 9 Elm Tree Court, New Heston Road to provide a loading facility for local shops. The loading bay will operate 'at any time, maximum stay 20 minutes, no return for one hour.



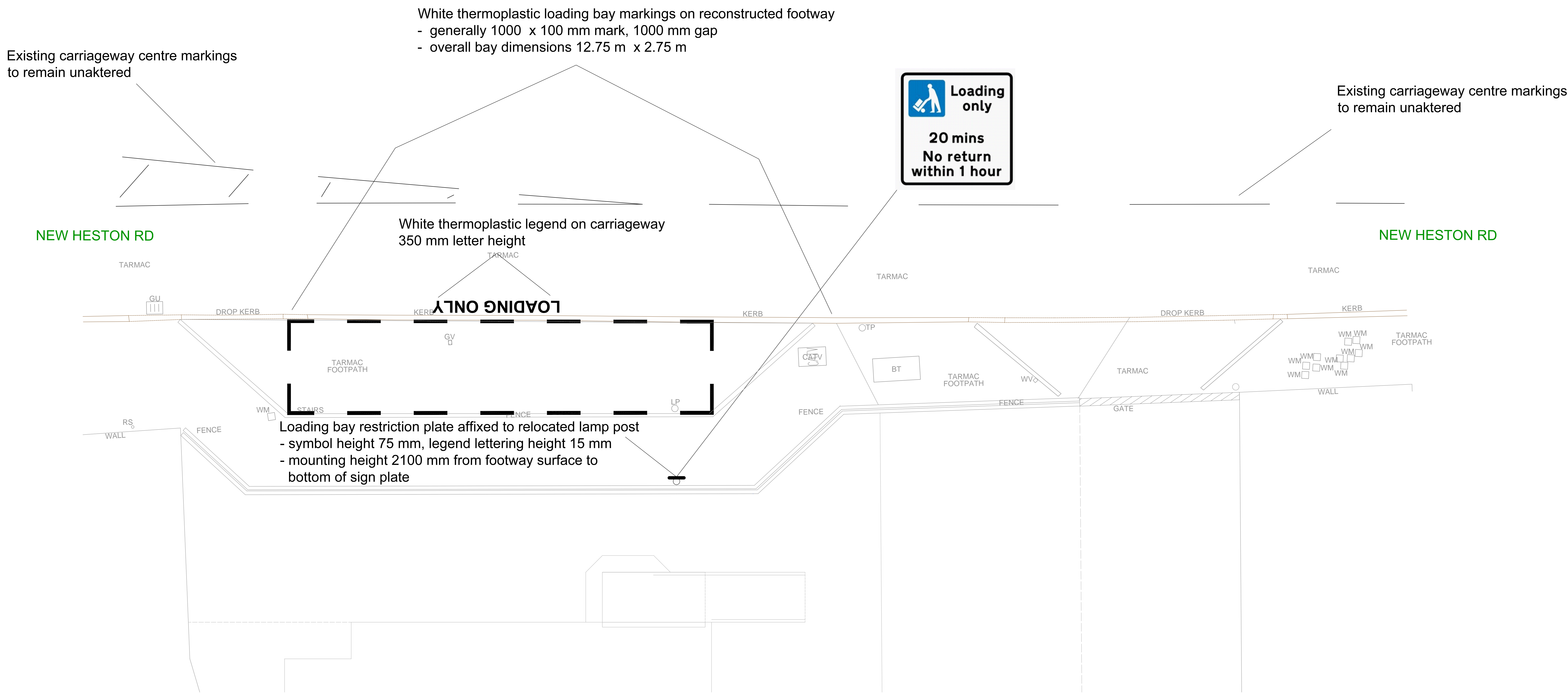

1 Traffic sign plate and markings to accord with current (2016) Traffic Signs Regulations and General Directions and Traffic Signs Manual

Nov 2018: Loading bay shortened, crossover detail amended and telegraph pole new location changed

Dec 2018: Loading bay restriction plate wording amended

Jan 2018: Loading bay restriction plate wording further amended to include stay time and return restrictions



Client <b>SINCLAIR MCKINSLEY</b>		Contract <b>136 NEW HESTON ROAD</b>	
Drawing Title <b>NEW AND ALTERED HIGHWAY AREA TRAFFIC SIGNS AND MARKINGS</b>			
Date <b>Aug 2018</b>	Designed <b>CMV</b>	Drawing No <b>IC/268/01/06 rev C</b>	
Scale <b>1:50 @ A0</b>	Drawn <b>CMV</b>		